



Job Name:	
Job Location:	
Engineer:	
Contractor:	
Tag:	
PO#:	
Rep:	
Wholesale Dist.:	

### DESCRIPTION

The **Apollo TV (34-200 Series) Thermostatic Mixing Valve** provides non-ASSE extension of water heater capacity and hot water temperature control in hydronic heating systems. Available in low or high temperature options for floor or baseboard applications.

### FEATURES

- Standard Temperature Range (120°F-180°F)
- Low Temperature Range (85°F-120°F) - L1 Option
- Fingertip Temperature Control
- Replaceable thermal element
- Solder connections are standard
- **Made in USA - ARRA compliant**

### OPTIONS

- -01 (Standard Temp 120°F - 180°F)
- -L1 (Low Temp 85° - 120°F)

### APPROVALS

- ASSE 1017 - Temperature Actuated Mixing Valve for Hot Water Distribution Systems

### STANDARD MATERIALS LIST

<b>BODY</b>	ASTM B584 Bronze
<b>SHUTTLE</b>	Scale Resistant Noryl® Polymer
<b>SENSOR</b>	Copper / Wax filled
<b>O-RING</b>	Chloramine Resistant EPDM
<b>SPRING</b>	ASTM A313 Stainless Steel
<b>CAP</b>	ABS Polymer

### DIMENSIONS

ORDER NO. LOW TEMP 85° - 120° F	ORDER NO. HIGH TEMP 120° - 180° F	CONNECTION	SIZE (IN.)	DIMENSIONS (IN.)		WEIGHT (LB.)
				HEIGHT	WIDTH	
34203L1	3420301	Solder	1/2	4.45	3.75	1.4
34204L1	3420401	Solder	3/4	4.47	4.00	1.46

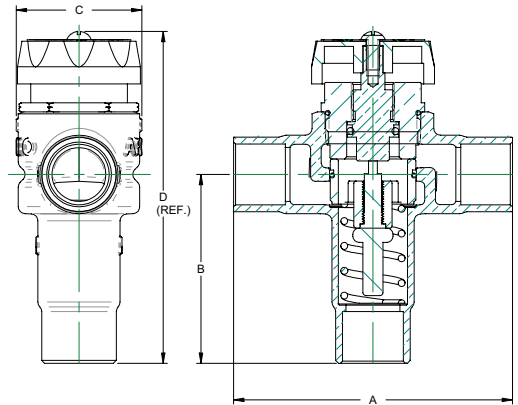

### PERFORMANCE RATING

- Maximum Supply Pressure: 150 psi (1034 kpa)
- Minimum Inlet/Outlet Temperature Differential: 15°F
- Hot Inlet Temperature Range: 120°F - 210°F (49°C - 99°C)
- Cold inlet temperature Range: 39°F - 80°F (4°C - 27°C)
- Outlet Temperature Control: 80°F - 120°F (27°C - 49°C)
- Outlet Temperature Control (Hydronic): 120°F - 180°F
- Low Temperature (L1) Mix Range: 85°F - 120°F (30°C - 49°C)
- High Temperature (01) Mix Range: 120°F - 180°F (49°C - 82°C)
- Mixed Water Temperature Tolerance: +/- 7°F (1.7°C)

