

# RP40S

Reduced Pressure Detector Assembly with  
Slow-Close Ball Valves

## SUBMITTAL SHEET

"Apollo" Valves

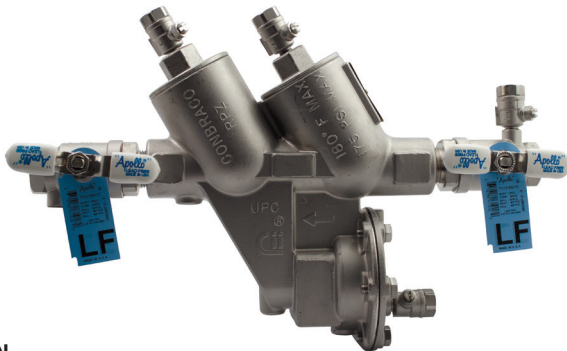

|                  |  |
|------------------|--|
| Job Name:        |  |
| Job Location:    |  |
| Engineer:        |  |
| Contractor:      |  |
| Tag:             |  |
| PO#:             |  |
| Rep:             |  |
| Wholesale Dist.: |  |

### DESCRIPTION

The 3/8" - 1" Stainless Steel Reduced Pressure Principle Backflow preventer shall be an Apollo® RP40S. The assembly shall be manufactured in America with all domestic components and parts. The stainless steel body shall be configured with individually-accessible top-access check valves including top-mounted test cocks. The relief valve shall be bottom-centered with a separate access cover. The replaceable seat rings shall be glass-filled Noryl® and the reversible seat discs shall be silicone rubber. The Apollo® domestic shut-off ball valves shall have stainless steel handles. The assembly shall prevent contamination of the potable water supply due to back-siphonage or back pressure from substances that are health or non-health hazards. The pressure drop across the assembly shall be documented by the Foundation for Cross-Connection Control and Hydraulic Research at the University of Southern California approval curves.

### FEATURES

- Replaceable Seats & Reversible Silicone Seat Discs
- Top-mounted Test Cocks for Easy Testing
- Corrosion Resistance
- **Made in the USA**

### APPROVALS

- ASSE 1013
- CSA B.64.4
- IAPMO
- AWWA C-511
- NSF/ANSI 372 - Lead Free
- Foundation for Cross-Connection Control and Hydraulic Research at the University of Southern California
- UL\*

\*UL-Classified less ball valves only (3/4" & 1" only)

### PERFORMANCE RATING

- Maximum Working Pressure: 175 psi
- Temperature Range: 33°F - 180°F
- Hydrostatic Test Pressure: 350 psi

### DIMENSIONS

| Size | 3/8", 1/2" | 3/4"  | 1"     |
|------|------------|-------|--------|
| A    | 10.5       | 13.5  | 15.375 |
| B    | 5.75       | 8     | 8      |
| C    | 6.875      | 9     | 9      |
| D    | 2.625      | 4.125 | 4.125  |
| Wt.  | 7.4        | 14    | 14.5   |

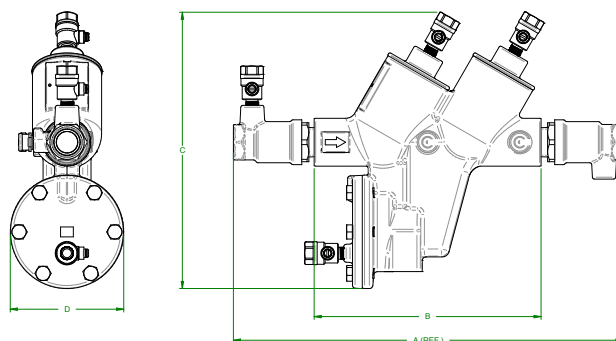

### ORDERING INFORMATION

40-20X-TXS

#### SHUT OFF VALVES

- ☐ 1 - less ball valves
- ☐ 2- with Apollo® ball valves

#### SIZE

- ☐ 2 - 3/8"
- ☐ 3 - 1/2"
- ☐ 4 - 3/4"
- ☐ 5 - 1"

### FLOW CURVES

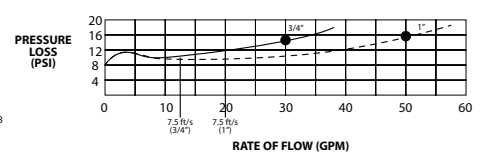
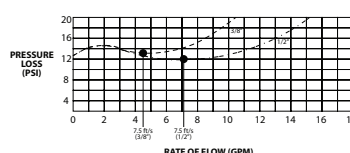

\*LEAD FREE: The wetted surfaces of this product shall contain no more than 0.25% lead by weighted average. Complies with Federal Public Law III-380. ANSI 3rd party approved and listed.

Customer Service (704) 841-6000  
www.apollovalves.com

This specification is provided for reference only. Conbraco Industries Inc. reserves the right to change any portion of this specification without notice and without incurring obligation to make such changes to Conbraco products previously or subsequently sold. Please visit [apollovalves.com](http://apollovalves.com) for the most current information.

