

# ROD COUPLINGS AND TURNBUCKLES



☐ **Fig. 136: Straight**  

Rod Coupling

☐ **Fig. 136R: Reducing** 

**Size Range:** 1/4" through 1"

**Material:** Malleable iron

**Finish:** ☐ Plain or ☐ Zinc Plated

**Service:** For connecting rod lengths within limitation.

**Approvals:** Fig. 136: UL, ULC Listed (3/8" - 7/8" rod size) and FM Approved (3/8" and 1/2" rod size). Fig. 136R: UL Listed (1/2" and 3/8" rod size).

**Features:**

- Available in reducing sizes.
- Provides visual inspection of thread engagement.
- Uniform strength; good appearance.

**Ordering:** Specify rod tapping size, figure number and name. Furnished with right-hand UNC threads only.



FIG. 136, 136R: DIMENSIONS (IN) • LOADS (LBS) • WEIGHTS (LBS)				
Rod Size A	Max Load	Weight	L	D
<b>Straight: Fig. 136</b>				
1/4	230	0.06	1 3/8	5/8
3/8	730	0.10	1 5/8	1 1/16
1/2	1,350	0.20	2 1/8	1 5/16
5/8	2,160	0.33	2 1/2	1 1/8
3/4	3,230	0.44	2 5/8	1 1/4
7/8	4,480	0.96	3 3/16	1 5/8
1	5,900	0.94	2 3/4	1 13/16
<b>Reducing: Fig. 136R</b>				
3/8 x 1/4	230	0.10	1 5/8	1 5/8
1/2 x 3/8	730	0.21	2 1/8	2 1/8

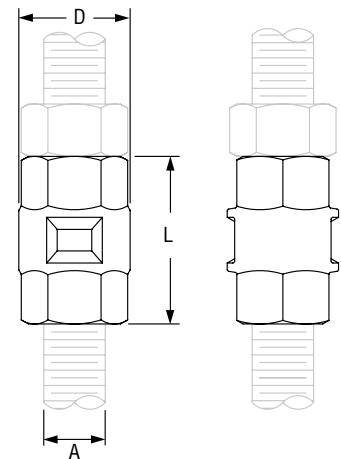

PROJECT INFORMATION		APPROVAL STAMP	
Project:		<input type="checkbox"/> Approved	
Address:		<input type="checkbox"/> Approved as noted	
Contractor:		<input type="checkbox"/> Not approved	
Engineer:		Remarks:	
Submittal Date:			
Notes 1:			
Notes 2:			