

Performance Data

NEW 12-Volt Pumps from CDS-John Blue Company - Agri-Pump

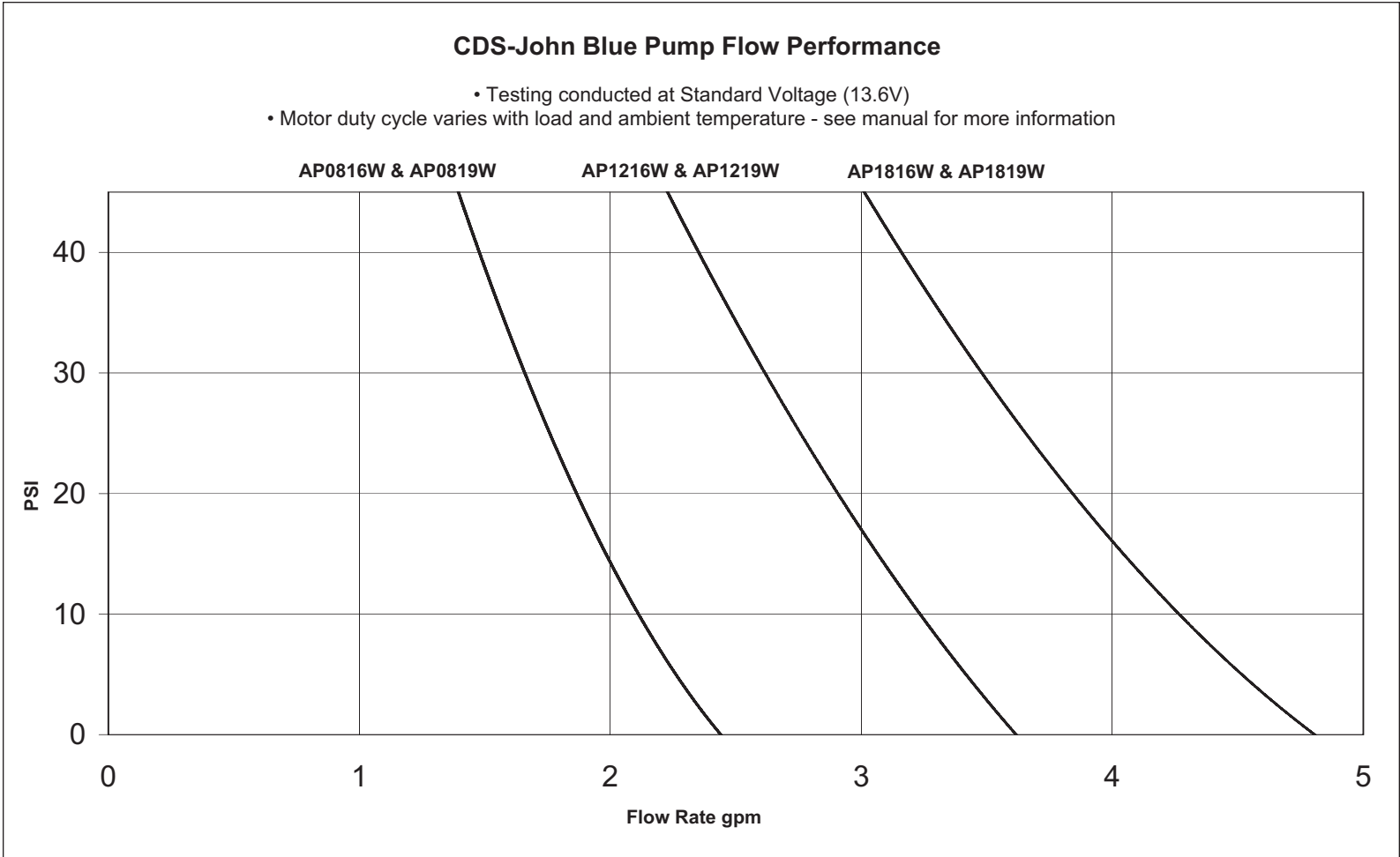

Distributed by:

Contact CDS-John Blue Company

Division of Advanced Systems Technology
PO Box 1607
Huntsville, AL 35807
Tel: 256-721-9090
800-253-2583

info@cds-johnblue.com
www.cds-johnblue.com

QUALITY MANAGEMENT SYSTEM
CERTIFIED BY DNV
ISO 9001:2000

Features

- Weatherproof tested - The only 12-volt pump to be totally protected against Weather, Dust and Overspray, backed by a 2-year Warranty!
- 4 piston diaphragm for smoother flow.
- Quick connect ports system means it's faster to install, requires fewer parts and connections while reducing the number of potential leak points.
- Integral pressure switch (fully sealed)
- Low current draw resulting in a longer battery life.
- Chemical resistant materials
- Automatic demand
- Runs dry without damage
- **2-year warranty**



Model Specifications

Product Code		AP0816W	AP0819W	API216W	API219W	API816W	API819W
Output @ Open Flow gpm		2.2		3.6		4.8	
Nominal Voltage		12V dc					
Maximum Operating Pressure		45 PSI					
Maximum AMP Draw		7 Amps		12 Amps		13 Amps	
Weight		5.3 lbs				6.4 lbs	
Inlet/Outlet Ports		15 mm quick connect ports	1/2" NPT Male	15 mm quick connect ports	1/2" NPT Male	15 mm quick connect ports	1/2" NPT Male
Connectors Included		Includes clear sight-glass strainer, 5 hose barb quick connect fittings.	None	Includes clear sight-glass strainer, 5 hose barb quick connect fittings.	None	Includes clear sight-glass strainer, 5 hose barb quick connect fittings.	None
Inlet Strainer Included		Yes		Yes		Yes	
Material	Diaphragm	Santoprene®					
	Valves	Santoprene®					
	Seals	Viton®					
	Housing	Glass Filled Polypropylene					
	Strainer	Polycarbonate, 316 stainless steel 50 mesh screen					
Minimum Wire Size		14 AWG		12 AWG			

12-Volt Agri-Pump

Spare Parts Information

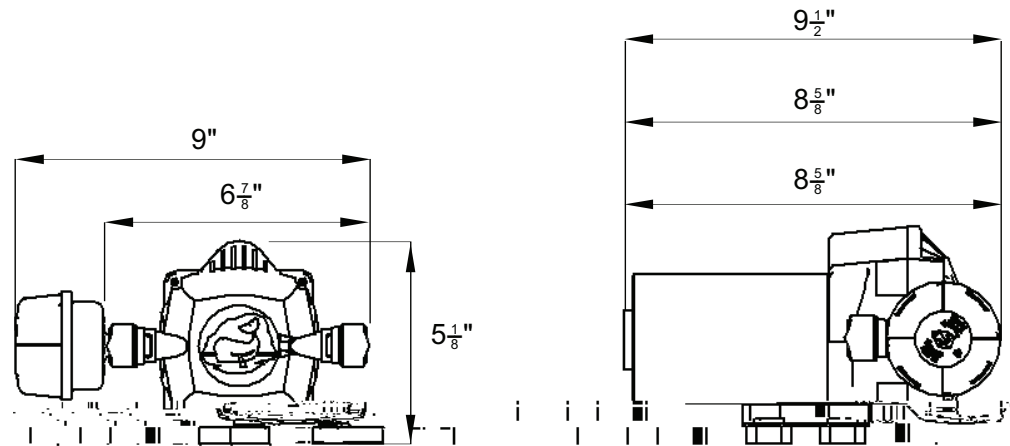

API816W

API216W

AP0816W

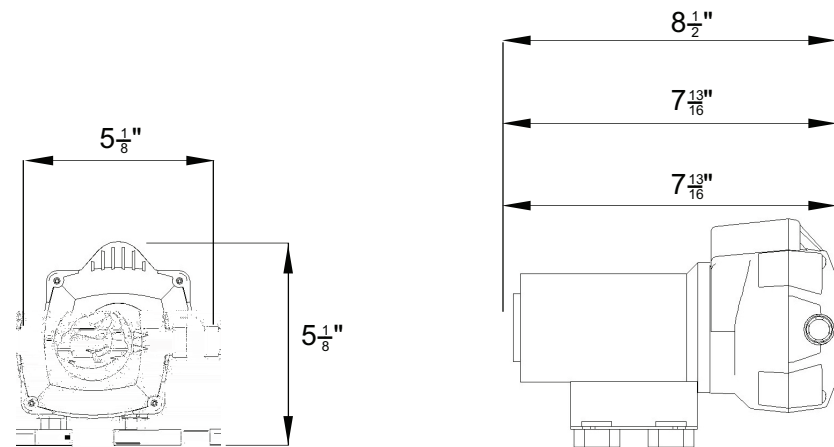

API819W

API219W

AP0819W

WX1584W

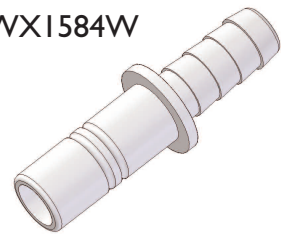

CDS-JOHN BLUE QUICK
CONNECT - 1/2" BARB

WX1591W

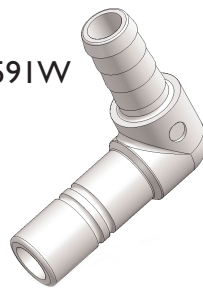

CDS-JOHN BLUE QUICK
CONNECT - 1/2" BARB
ELBOW

WX1592W

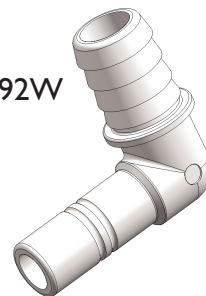

CDS-JOHN BLUE QUICK
CONNECT - 3/4" BARB
ELBOW

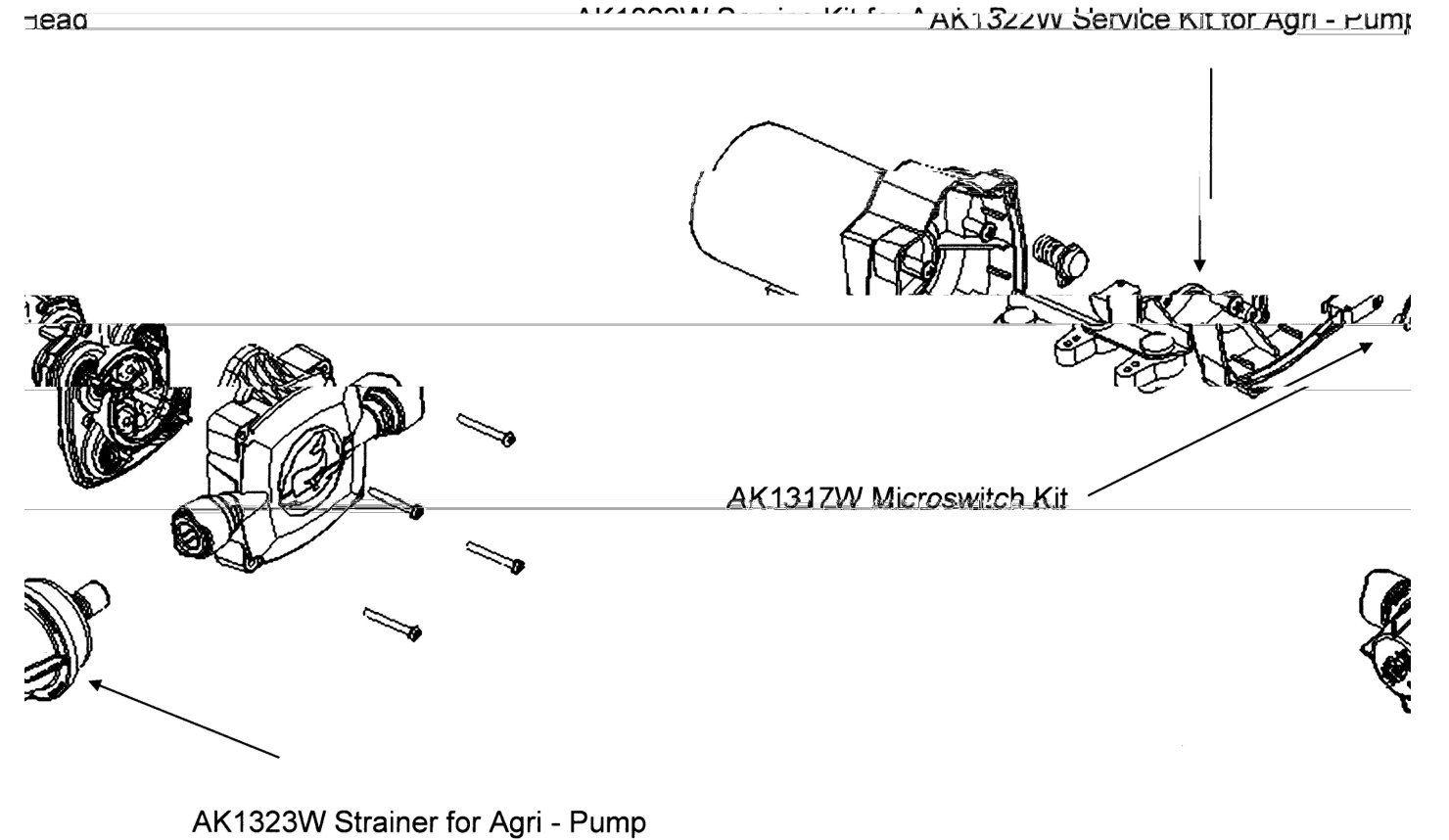

AK1317W Universal Service Kit for 12-V Pump Microswitch

AK1322W Universal Service kit for Agri-Pump Head

AK1323W Universal Inlet Strainer - 90 degrees