



E-3 and E-41 Pressure Regulating Valves

The Cash Acme E-3 and E-41 Pressure Reducing and Regulating Valves automatically reduce a high inlet pressure to a lower delivery pressure and maintain the lower pressure within reasonably close limits.

The Cash Acme E Series 3 is designed for use where supply line inlet pressure does not exceed 300 psi and is suitable for either cold or hot water service for a variety of applications. Similar to the E-3, the Cash Acme E-41 comes without an inbuilt strainer for conditions that do not require their use or where separate or individual strainers are preferred.

- Automatically reduces a high inlet pressure to a lower delivery pressure: *Maintains a lower pressure within reasonably close limits.*
- Every valve is tested for performance prior to shipping: *Specify and install with confidence!*
- Solves problems of water hammer, pipe noise and rapid wearing of fixtures, faucets, and valves: *Longer life of the valve saves money and time!*
- Listed by ASSE 1003 and IAMPO: *Inspector friendly, peace of mind!*



TYPICAL INSTALLATION

The **E-3** and **E-41** pressure regulators should be installed in the horizontal position with the spring chamber upright. For other installation requirements, consult the factory.

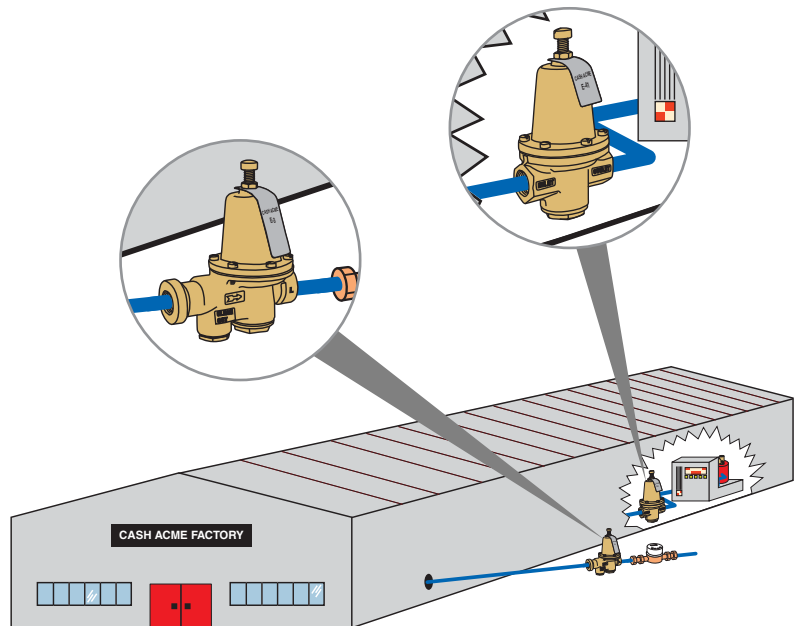

E-3 and E-41 Pressure Regulating Valves

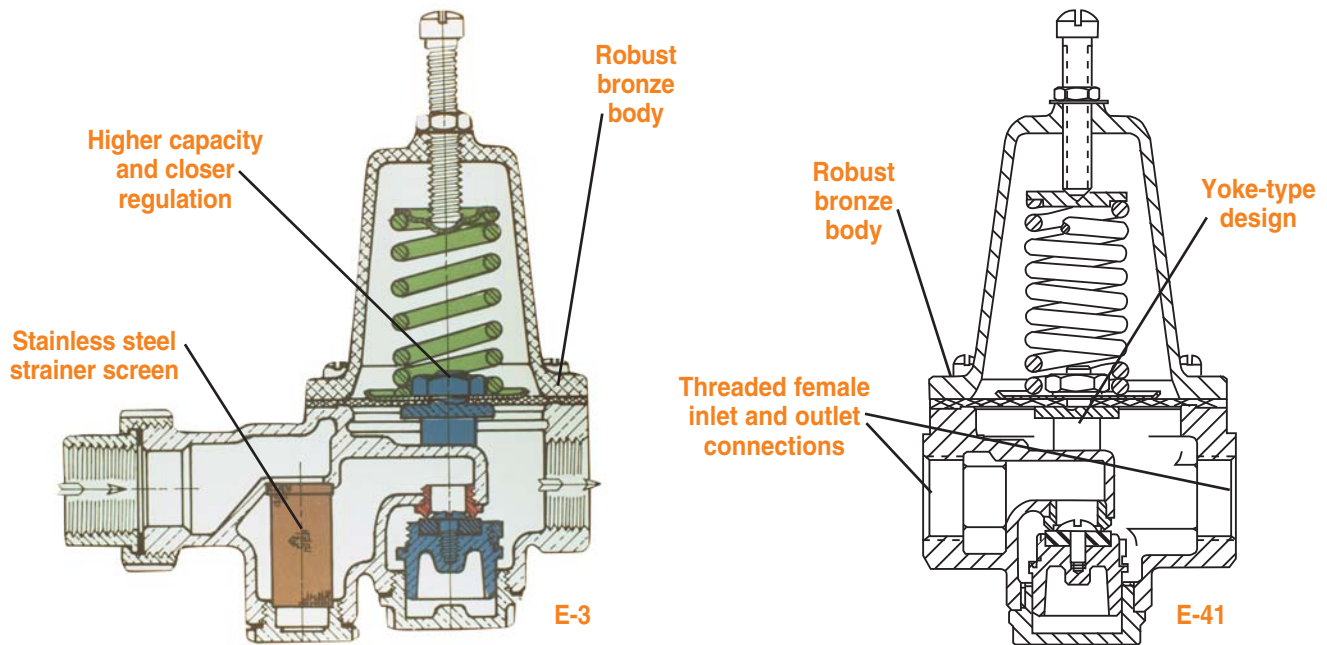

MODELS/SIZES

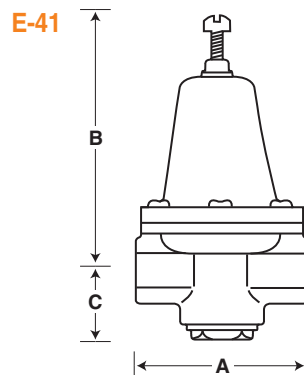
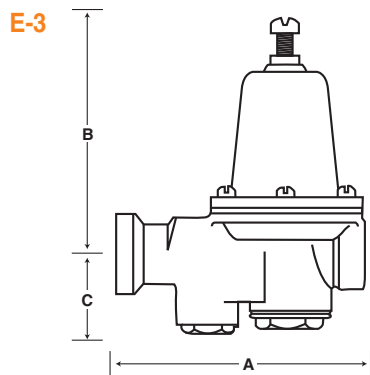

E-3 Dimensions	A	B	C
1/2"	5"	5-1/4"	1-3/4"
3/4"	5-1/2"	5-15/16"	1-7/8"
1"	6-7/16"	7"	2-11/16"
1-1/4"	7-5/8"	7-1/2"	3"
1-1/2"	8-7/8"	8-1/2"	3-1/4"
2"	10-7/16"	10-1/4"	3-3/16"

E-41 Dimensions	A	B	C
1/2"	3-3/8"	5-1/4"	1-1/2"
3/4"	4-1/16"	5-15/16"	1-7/8"
1"	4-9/16"	7"	2-5/16"
1-1/4"	5-3/16"	8"	2-3/8"
1-1/2"	5-13/16"	8-1/2"	2-5/8"
2"	6-1/2"	10-1/4"	2-3/4"

CONNECTIONS

Threaded (NPT) 1/2", 3/4", 1", 1-1/4", 1-1/2" and 2"

CERTIFICATIONS

The Cash Acme E-3 and E-41 Pressure Regulators are certified to ASSE 1003 and is listed by ASSE and IAPMO (UPC).