



## SoloSet® EB-25 Pressure Regulator

SoloSet® EB-25 from Cash Acme brings state-of-the-art water control technology to pressure regulators. SoloSet® has a convenient orange pressure adjustment twist-cap and numerical indicator which makes installation a quick, one-man job. The unique design also eliminates the water whistle or hum associated with most PRVs, due to innovative “micro-fingers” that dissipate noise as water flows across the seat. And thanks to a patented single-cartridge design, SoloSet® has fewer parts for increased reliability, and it can be serviced without having to remove the valve body.

Reducing water pressure from high supply to lower delivery pressure is an everyday need – make quick work of the task with SoloSet® and enjoy the benefits. Lead Free\* models are also available

- Convenient orange twist-cap eliminates need for wrench adjustment, numerical indicator displays the pressure without the need for a gauge: *One person can install, saving money and time!*
- Single piece cartridge can be removed with valve body remaining in place: *You can service all the parts from one place, quicker and easier!*
- Integral backpass check with the cartridge: *No add-on or small parts, longer life and more reliable performance.*
- Cutting edge design and production incorporate “micro-fingers” that dissipate noise due to water flow across the seat: *Meets the latest stringent international standards, quieter installation.*
- Available with a blanking cap for “rough-in” installations: *No more dummy valve necessary.*



**SoloSet®**

### TYPICAL INSTALLATION

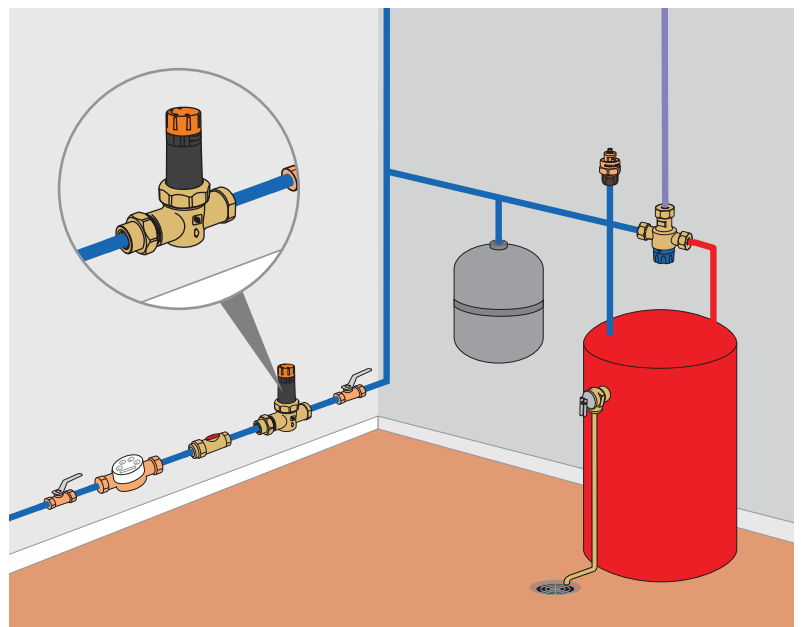



# SoloSet® EB-25 Pressure Regulator

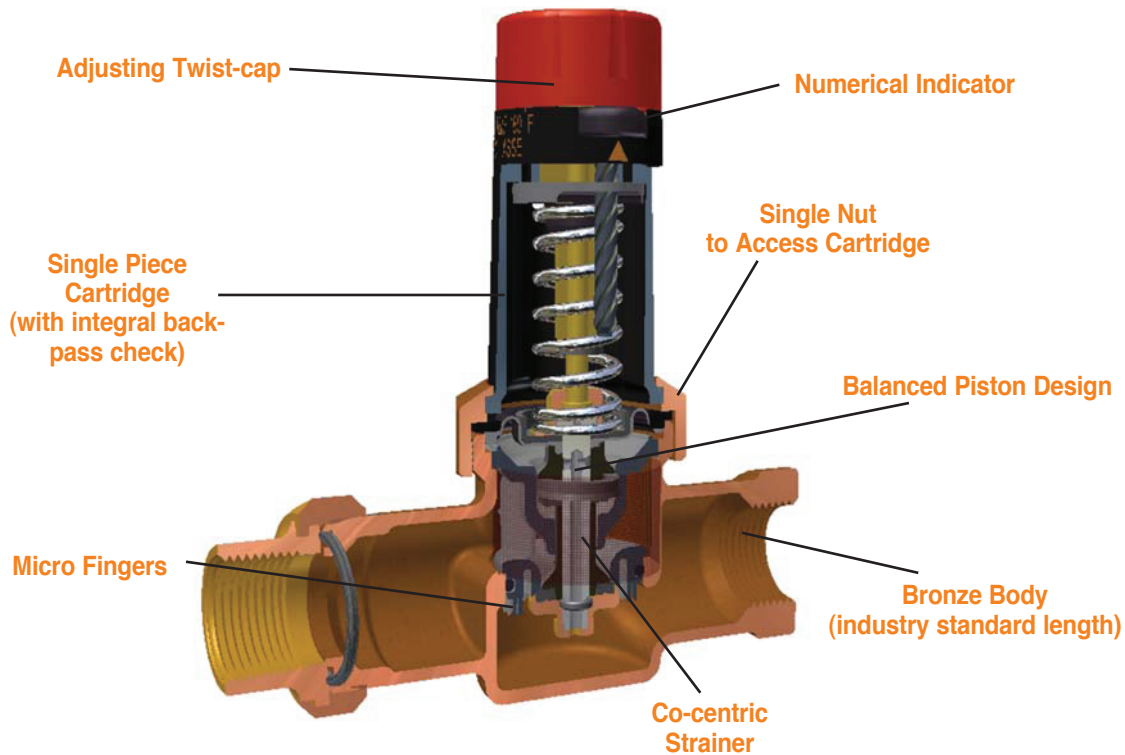

## MODELS/SIZES

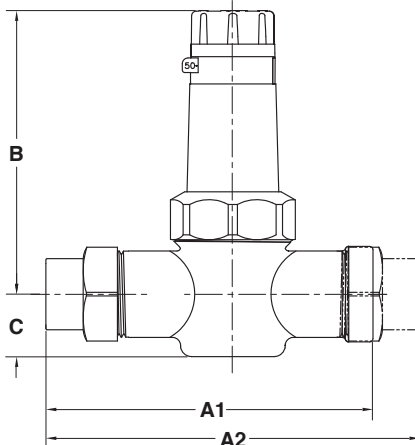

Dimensions	A1 (mm)	A2 (mm)	B (mm)	C (mm)
1/2" Union	5.67 (144)	-	4.92 (125)	1.08 (28)
3/4" Union	5.67 (144)	-	4.92 (125)	1.08 (28)
1" Union	5.74 (146)	-	4.92 (125)	1.08 (28)
1 1/4" Union	5.74 (146)	-	7.48 (190)	1.41 (36)
1 1/2" Union	5.96 (151)	-	7.48 (190)	1.57 (40)
2" Union	6.05 (154)	-	7.48 (190)	1.89 (48)
3/4" Double Union	-	6.49 (165)	4.92 (125)	1.08 (28)
1" Double Union	-	6.61 (168)	4.92 (125)	1.08 (28)
1 1/4" Double Union	-	6.55 (166)	7.48 (190)	1.41 (36)
1 1/2" Double Union	-	6.99 (178)	7.48 (190)	1.57 (40)
2" Double Union	-	7.18 (182)	7.48 (190)	1.89 (48)

## CONNECTIONS

Threaded (NPT) Union Inlet . . . . . 1/2", 3/4", 1", 1-1/4", 1-1/2" and 2"

Threaded (NPT) Union Inlet and Outlet . . . . 3/4", 1", 1-1/4", 1-1/2" and 2"

**Note:** Now available in lead free\*, or with high pressure (400 inlet psi) and low pressure (8-35 outlet psi) cartridges.

## CERTIFICATIONS

Cash Acme Type EB-25 Pressure Regulators are certified to **ASSE 1003** and **CSA B356** and are listed by **ASSE, CSA** and **IAPMO (cUPC)**. Low pressure (8-35 psi) not certified/listed.

\* For our Lead Free models, surfaces that are in contact with consumable water contain less than 0.25% lead by weight.

