



VB-222 Self-Draining Hose Connection Vacuum Breaker

Cash Acme's Self-Draining VB-222 Hose Connection Vacuum Breaker is so innovative that it carries a U.S. Patent for 22 design features.

The Cash Acme VB-222 is designed to prevent dangerous back-siphonage and backflow into a potable water supply system and drain automatically when all attachments are removed.

- Prevents dangerous back-siphonage:
Automatically self-drains when all attachments are removed.
- Self-draining with hose removed: *Protects the valve and faucet from freezing and rupturing in cold weather.*
- Listed by ASSE, CSA and IAPMO:
Inspector friendly, peace of mind!



TYPICAL INSTALLATION

The **Cash Acme VB-222 Vacuum Breaker** is specifically designed for use around homes, schools, commercial buildings, laboratories or anyplace involving movable hoses attached to threaded faucets.

For proper operation of the self-draining feature and to provide help in freeze protection, all connections to the outlet of the **VB-222** must be removed.

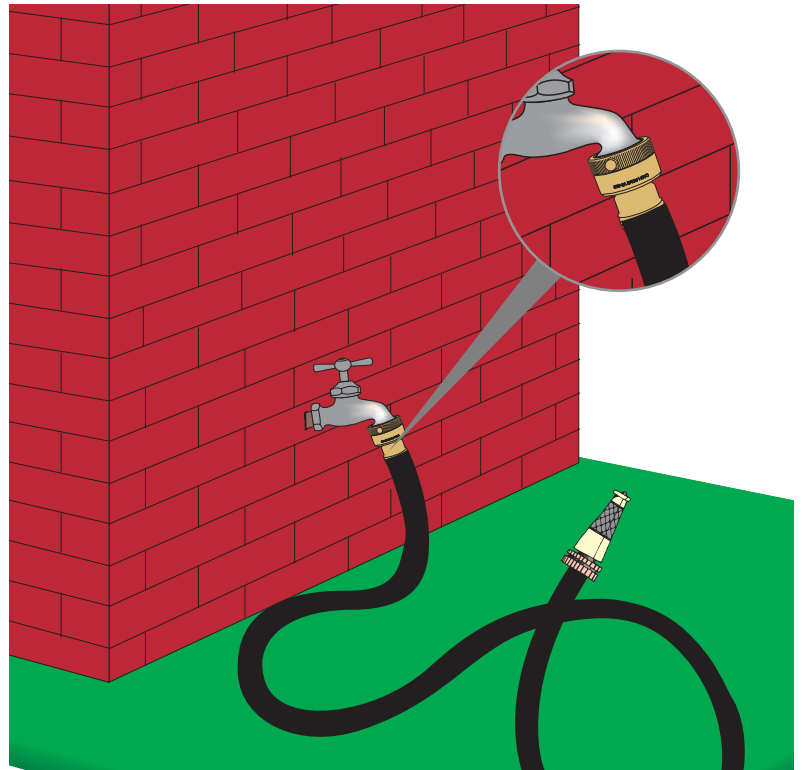



VB-222 Self-Draining Hose Connection Vacuum Breaker

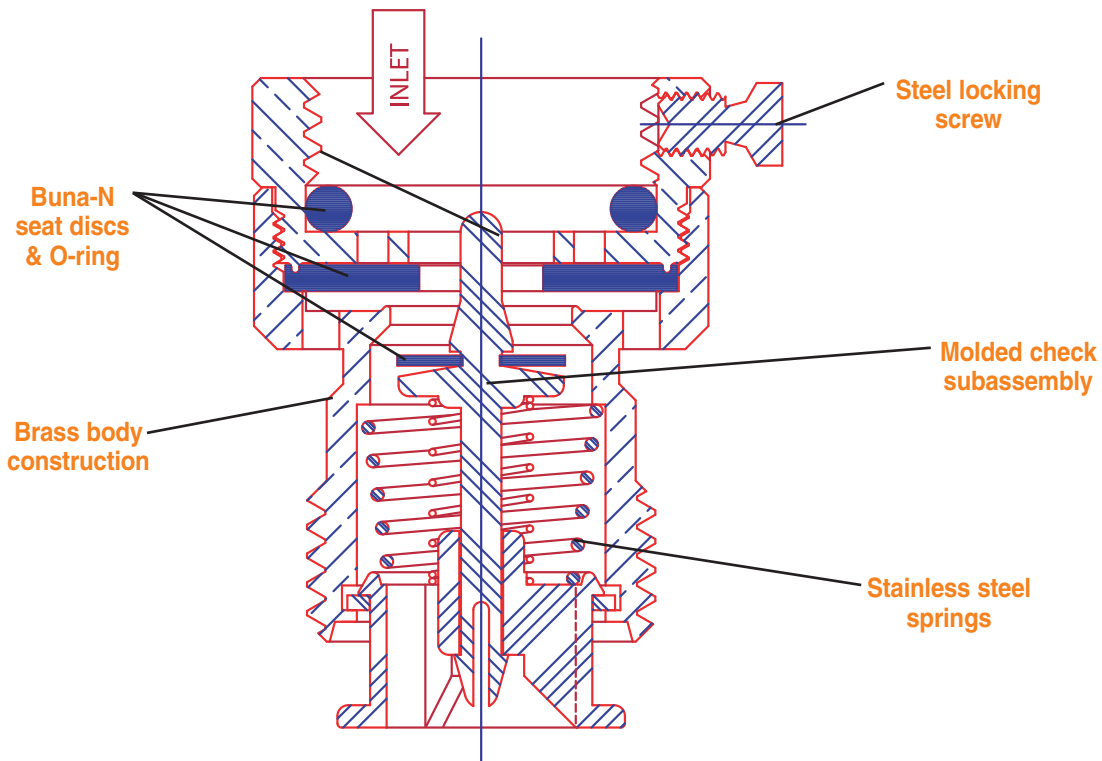

MODELS/SIZES

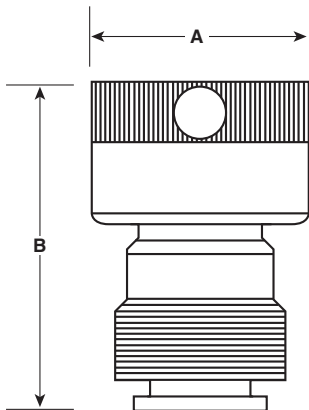

VB-222 Dimensions

Size	A	B
3/4"	1-5/16"	2"

CONNECTIONS

Threaded (NH) 3/4"

CERTIFICATIONS

The **Cash Acme VB-222** is certified to **Product Standards ASSE 1011** and **CSA B64.2**.
The **Cash Acme VB-222** is listed by **ASSE, CSA** and **IAPMO**.

