



EB-75 Pressure Regulators

The Cash Acme EB-75 is a compact, iron-body pressure reducing and regulating valve designed for installations where small size and economy are important considerations and where local codes allow the use of iron body regulators for water service.

The EB-75 Regulators are available in 1/2" and 3/4" sizes. This regulator is intended for use where supply line inlet pressure does not exceed 300 psi. The EB-75 is suitable for either cold or hot (to 180°F) water service. Ideal for domestic installations, it automatically reduces and regulates inlet pressures down to the standard factory setting of 45 psi.

- Compact pressure reducing and regulating valves:
Designed for small size and economic considerations.
- Every valve is tested for performance prior to shipping:
Specify and install with confidence!
- Inbuilt back-pass check: *Allows water to flow back through the regulator in cases of thermal expansion caused by hot water heating devices.*
- Fully pressure-balanced piston: *Automatically reduces and regulates high inlet pressures from a maximum of 300 psi down to 45 psi at standard factory setting.*



TYPICAL INSTALLATION

The Cash Acme EB-75 pressure regulators should be installed in the horizontal position with the spring chamber upright. For other installation requirements, consult the factory.

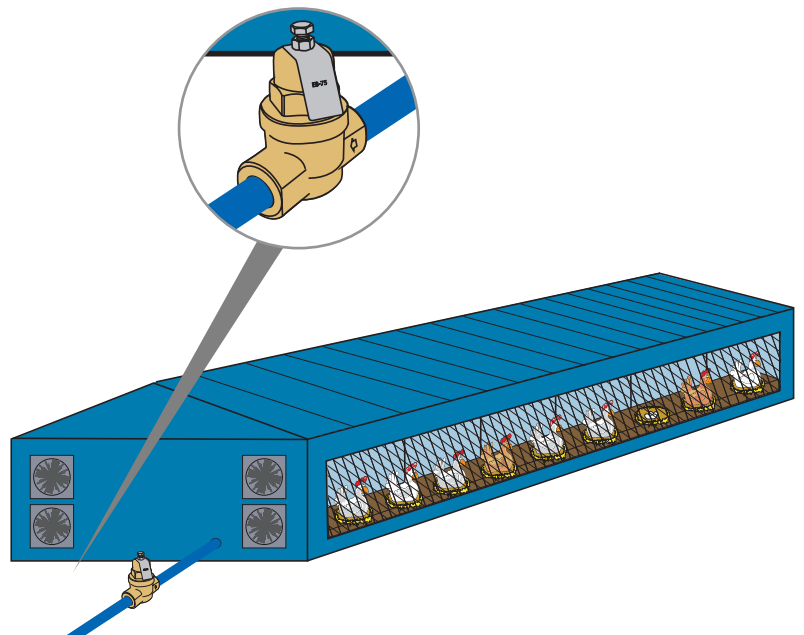



EB-75 Pressure Regulators

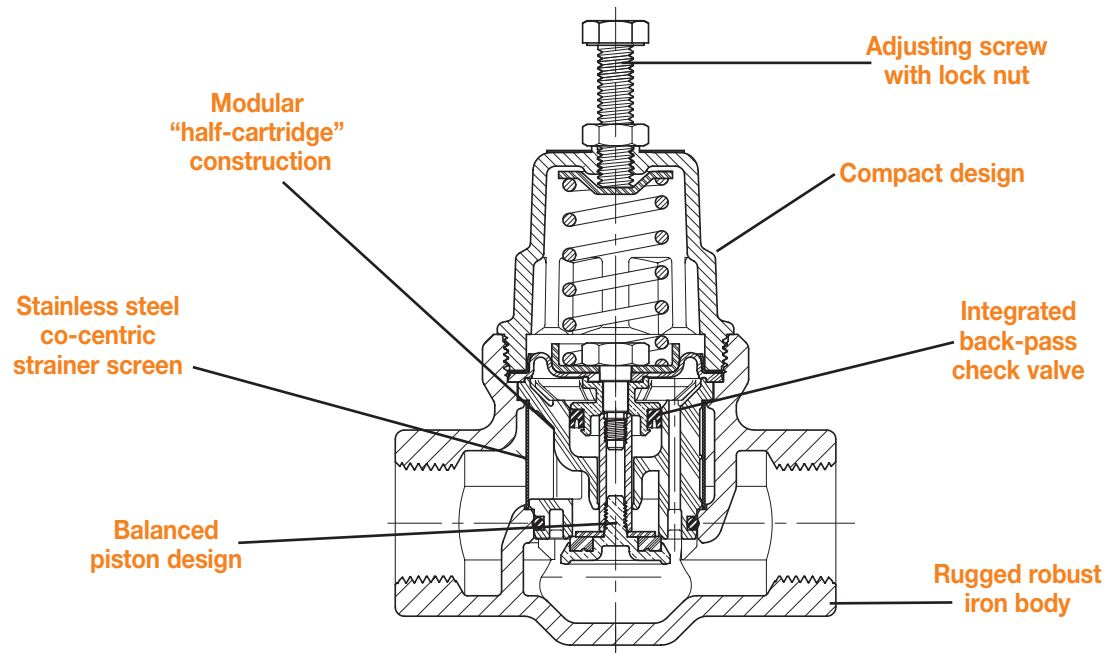

MODELS/SIZES

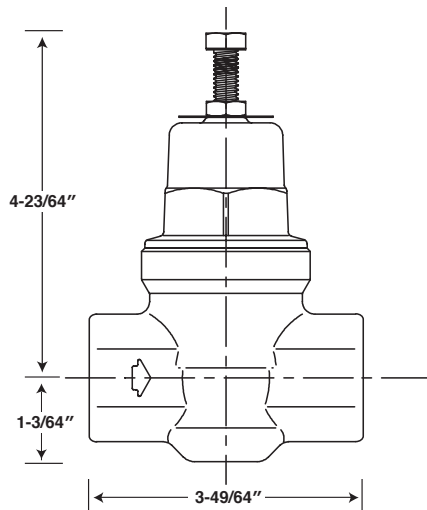

CONNECTIONS

Threaded (NPT) 1/2" and 3/4"

