

# F-30 Safety Relief Valve

## DESCRIPTION

---

The Cash Acme F-30 is a compact and economical ASME Safety Relief Valve for use on hot water space heating boilers, water supply heaters, and storage tanks.

The Cash Acme F-30 Relief Valve is designed for use on hot water service only and is **not to be used on steam**.

The Cash Acme F-30 is available in 3/4" size only. The standard factory pressure relief setting of 30 psi. Our F-30 pressure only relief valve features an all brass body, brass internal parts, a silicone seat disc and a stainless steel pressure spring.

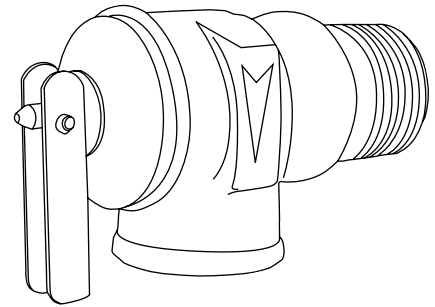

## FEATURES AND BENEFITS

---

Compact and economical:  
*Saves space and money!*

Listed by ASME:  
*Inspector friendly, peace of mind!*

Every valve is tested for performance prior to shipping:  
*Specify and install with confidence.*

## SPECIFICATION

---

A pressure only relief valve shall be installed to protect the vessel. The valve shall have a relief capacity of 510,000 BTU/HR. The valve shall have a set pressure of 30 psi and shall be ASME certified. The valve shall be a **Cash Acme F-30 ASME Safety Relief Valve**.

# F-30 Safety Relief Valve

## TYPICAL INSTALLATION

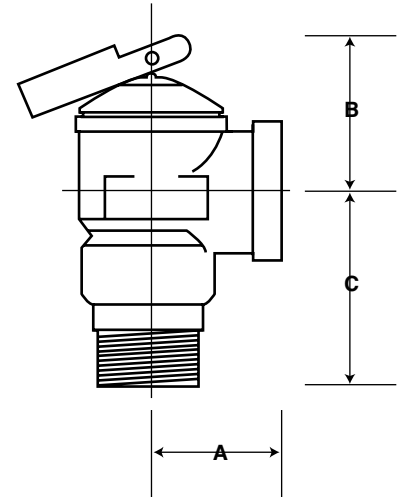
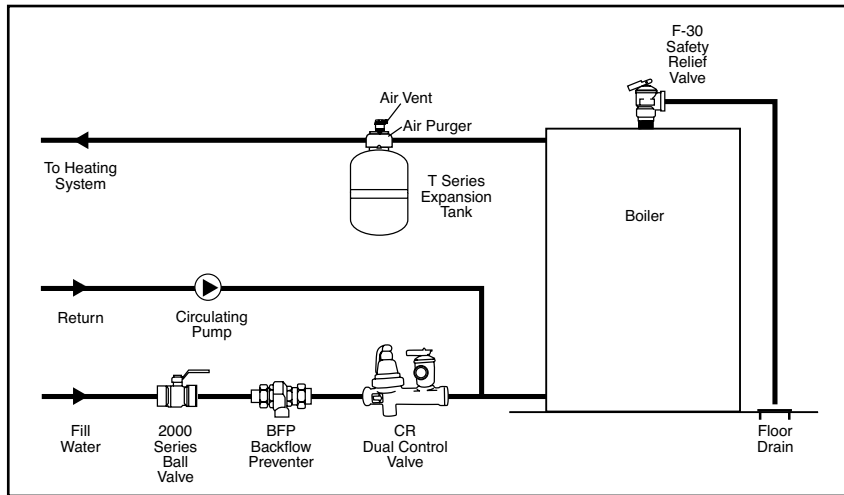

Dimensions	A	B	C
3/4"	1-1/4"	1-9/16"	1-13/16"

## SPECIFICATION DATA

### Performance:

Set pressure ..... 30 psi

Service ..... Water

### Materials:

Body ..... Brass

Internal Parts ..... Brass and stainless steel

Seat Disc ..... Silicone

Pressure Spring ..... Stainless steel

## CONNECTIONS

Threaded ..... 3/4" male inlet and female outlet

## CERTIFICATIONS

The Cash Acme F-30 Relief Valve is listed by ASME.