

# SPLIT RING HANGERS

## 516 series

### SPECIFICATION

Sioux Chief 516-B series domestic split ring hangers shall be used where necessary to suspend or support CTS or IPS piping with 3/8" threaded rod in accordance with national code requirements for light commercial applications. Hanger shall comply with MSS-SP58 Type 12 and WWH-171D Type 25.

### MATERIALS

516\_CB: copper plated, 16 gauge steel

516\_GB: galvanized, 16 gauge steel

### SAFE WORKING LOAD

180 lbs.

### DIMENSIONS

#### CTS

A Tube Size	1/2"	3/4"	1"	1-1/4"	1-1/2"	2"
B Pipe O.D.	0.625	0.875	1.125	1.375	1.625	2.125
C Center-Line	0.600	0.730	0.850	0.980	1.100	1.350

#### IPS

A Pipe Size	1/2"	3/4"	1"	1-1/4"	1-1/2"	2"
B Pipe O.D.	0.84	1.05	1.32	0.17	1.90	2.38
C Center-Line	0.71	0.82	0.95	1.12	1.24	1.48



516-4CB

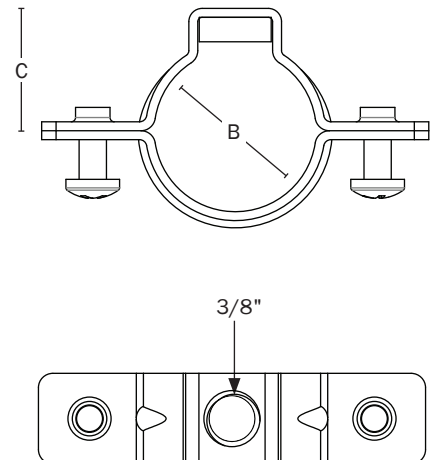

Made in USA

Create Item Number

**516-A B**

e.g. 516-4CB = copper plated split ring hanger for 1" CTS tube

A PIPE/TUBE

2 1/2"

3 3/4"

4 1"

5 1 1/4"

6 1 1/2"

7 2"

B FINISH

CB copper plated

GB galvanized