



An American Icon Since 1886

Product Catalog
Volume XIII

Ground Application Pumps and Accessories:

2014 New Products	2-3
Complete Systems	4-5
CDS-John Blue Piston Pumps	6-11
DRV and Pump Drives	12-13
Variable Rate Hydraulic Drive Kits	14-15
Flow Dividers and Check Valves	16-17
Flow Monitors (VisaGage II)	18-19
John Deere Kits	20
Squeeze Tube Pumps	21-23
Manifolds	24
System Components	25

Anhydrous Ammonia Products:

Impellicone Flow Divider	26
Anhydrous Ammonia Manifolds	27

Knives:

Knives	28-29
--------	-------

Transfer Pumps:

Centrifugal Pumps	30-32
-------------------	-------

Irrigation Injection:

Piston Metering Injection Pumps	33-36
---------------------------------	-------

Specialty Pumps:

Brass Gear Pumps	37
------------------	----

Diaphragm Pumps:

Poly Pump Introduction	38-39
Low Pressure Poly Pumps	40-45
Medium Pressure Pumps	46-48
High Pressure Pumps	49-50
High Pressure "Golden" Brass Pumps	51-52

Piston Spray Pumps:

Piston Spray Pumps	53-56
--------------------	-------

Spray Control Valves:

Spray Control Units	57-61
---------------------	-------

Miscellaneous Diaphragm Pumps Kits, Spray Guns and Lances:

Diaphragm Pump Miscellaneous Kits	61
Spray Guns	61
Low Volume, High Pressure Guns and Lances	62

Foam Markers:

Foam Markers	63-65
--------------	-------

12-Volt Pumps, Speed Controllers, and Accessories:

12-Volt Pumps	66
12-Volt Speed Controllers and Accessories	67

Miscellaneous:

Miscellaneous Drive Components	68
Seal & Gasket Repair Kits for Centrifugal Pumps	68
Seal Kits for Centrifugal Pumps	68
Repair Kits for Pumps and Fittings	69
Anhydrous Ammonia Meter Gasket Repair Kits and N-Serve Check Valve	69
Squeeze Pump Hoses and Miscellaneous Parts	69
Strainers and Strainer Components	69
Operator Kits	70
Conversion Kits	70
Miscellaneous Planter Kits	70
Sprockets for Pumps without Clutch	70

CDS-John Blue Company:

Customer Testimonials	71
-----------------------	----

2014 NEW Products

New Delivery Line Check Valves and Push Connect Fittings



Available on page **17**.

New 6-outlet Anhydrous Ammonia Splitter



Other models available on page **27**.

New Sting Pressure Regulator model SC-1241-2 for Diaphragm Pumps



More choices available on pages **57-61**.

New NGP-4055-F, NGP-5055-DRF and NGP-5655-ARF

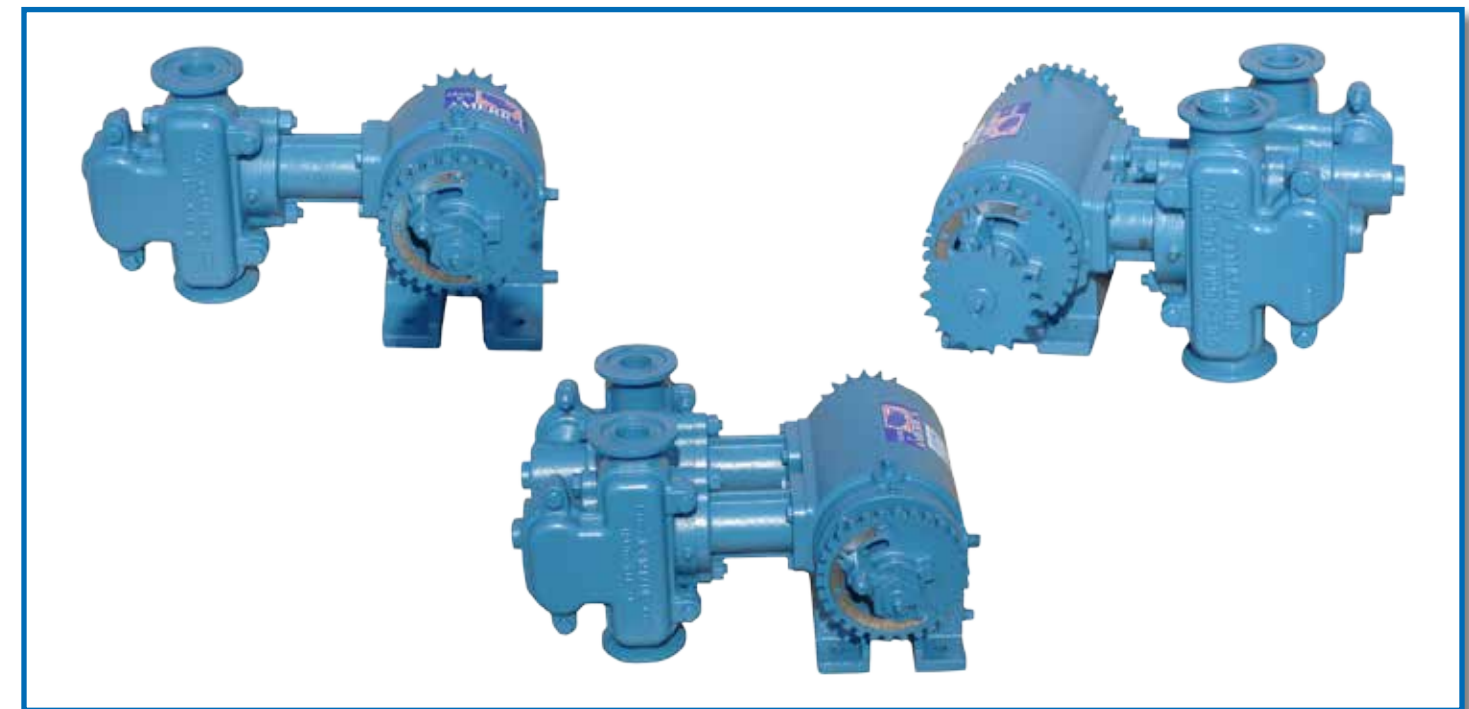

The complete line of NGP pumps are listed on pages **6-11**.

Push Connect Fittings for VisaGage II



See pages **18-19** for the VisaGage II push connect fittings plus the new Fumigant VisaGage II models.

The most reliable liquid fertilizer system on the market today is simple. It starts with the **CDS-John Blue Piston Pump** coupled with our **flow divider** for equal distribution. Simply add the **VisaGage II** to monitor your flow and the newly released serviceable **in-line check valves** to stop unwanted dripping at your application point. Set your fertilizer rates and forget it - let our piston pump package work for you! With over 125 years of experience the CDS-John Blue Complete Fertilizer Package is proven to be cost-effective and reliable while remaining accurate and dependable day in and day out from one year to the next.



Why the CDS-John Blue Complete System:

Accurate: Application rates DO NOT change due to temperature fluctuations.

Precise: A CDS-John Blue Piston Pump can pull product from your tanks for even application rates.

Flexible: Available with either a Variable Rate Hydraulic or Ground Drive Kit.

Reliable: Built to last, engineered for performance.

NEW! Dual Adjustable Rate Piston Pump NGP-8055-AR: Apply 2 products with 1 pump. Five to 1 max ratio between the pumping heads. Ideal for starter and NPK applications, for example 5 GPA starter fertilizer and 5-25 GPA NPK.

NEW! Flanges: Eliminate leaks with flange fittings and make it easier to plumb your system.

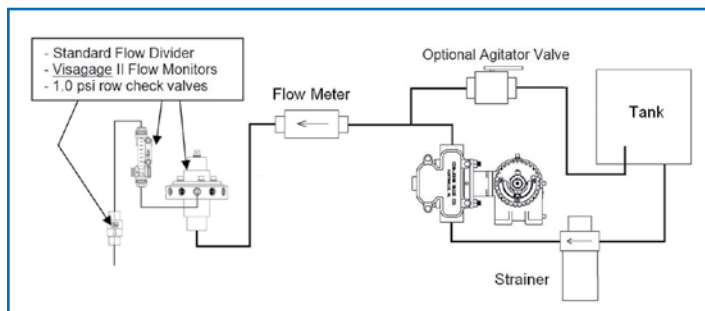

Fertilizer System Schematic

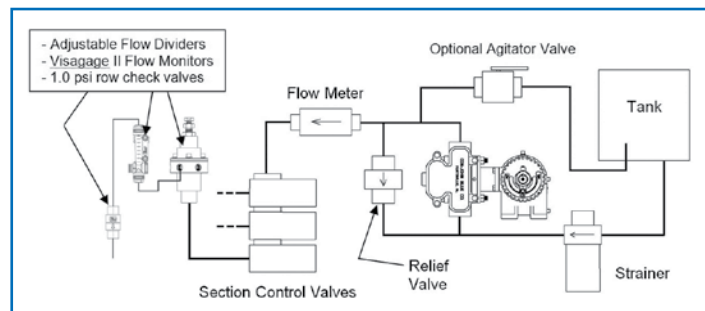

Fertilizer System Schematic
with section control

Typical schematic for a hydraulically driven system. Flow meters are only necessary with a hydraulically driven system and are not necessary or typically used for a ground driven system.

How to Select Your Complete CDS-John Blue Fertilizer Package:

1. How many rows do you have?
2. What is your swath width (row spacing distance multiplied by number of rows)?
3. What application rate do you want to achieve?
4. Now simply select the CDS-John Blue Piston Pump that best fits your needs (see charts under each pump series description pages 6-11).

DRV Kits: (see pages 12-13 for complete details)

- DRV-3300 Complete Ground Drive System, including pump mount and drive. It automatically adjusts for your terrain.
- DRV-3200 Universal Mount that uses the existing shaft from your planter.
- DRV-3100 Gage Wheel only.
- DRV-3000 is ideal for fixed height. Includes pump mount and drive.

VRH Kits: (see pages 14-15 for complete details)

CDS-John Blue bar mount and direct drive kits to fit most common electronic packages:

- JD series fits John Deere® CANbus Planters using GreenStar™ GS2 and GS3.
- PWM (pulse width modulation) series is for Raven®, Ag Leader®, Dickey-John® plus others. Used for variable rate and sectional shut-off.
- MAN (manual) series uses your tractor's hydraulics for a simple hydraulic driven system.



Now select your CDS-John Blue Flow Dividers:

1. How many outlets do you need?
For 6 outlets or sectional shutoff select the **NEW** FD-0610.
For 12 outlets or less select the FD-1210.
For 20 outlets or less select the FD-2010.
2. For multiple flow dividers, ideal for sectional shut-off, it is recommended that you purchase the Flow Divider Adjustable Spring Kit. For more information see pages 16-17.
3. New and improved delivery line check valves plus the **NEW** push connect fittings are available for any applications, see chart on Flow Divider page 17.

Knowing your flow is easy with CDS-John Blue VisaGage II Flow Monitors: (pages 18-19)



- Determine the number of outlets you need.
- Bank together single columns or sets of four or any combination you choose.
- Clasp them together with the stainless steel clips and Viton o-rings and you are ready to go.
- New and improved delivery line check valves are available for any application, see page 19 for more information.

It All Starts with the Best Pump

Select the Best CDS-John Blue Piston Pump to Fit Your Needs

NGP-6055-F with
VRH-PWM-15

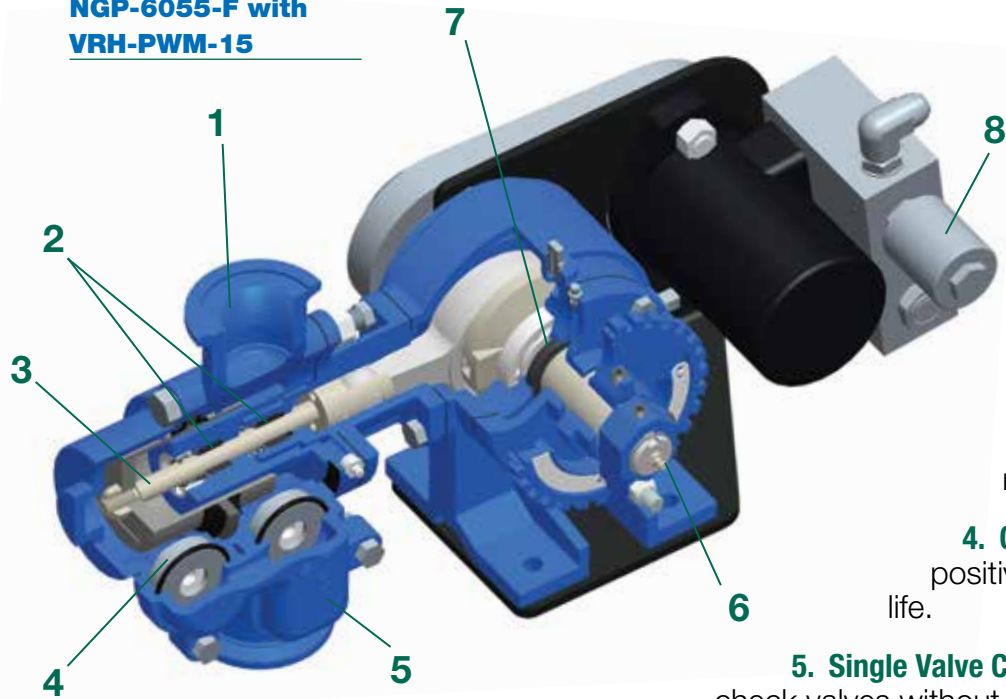

1. NEW Inlet and Outlet Flanges make it easier to plumb your system and eliminate leaks with flange fittings. (Add -F after model number).

2. Double piston rod seals work in unison to offer multiple stage protection between the wet end and crankcase.

3. Outboard cylinder plunger packing can be inspected or replaced in the field without removing the hoses.

4. Check Valves are designed for positive seal, easy priming and long life.

5. Single Valve Cap makes easy access to check valves without removing the hoses. Simple to service in the field.

6. Common or Independent Manifolds are available on the double pumps. Independent manifolds allow for dual flow divider usage or half width application.

7. Main Shaft Seals incorporate a dual wiper that is enclosed in a grease cavity to flush out contamination. This helps to extend the life of the pump.

8. NEW Optional Hydraulic Drives for numerous electronic packages.



NEW NGP-5055-DRF Series

Double Piston - Double Acting	Rated Speed - 450 RPM
Stroke - Variable	Inlet - 1" Inlet, 200 series flanges standard
Rated Flow - 20.4 GPM	Outlet - 1" Inlet, 200 series flanges standard
Rated Pressure - 120 PSI	Clutch - No Clutch

Rows	Swath in Inches		NGP-5055-DRF Application Range in GPA at 5 MPH			
			30 Inch Spacing		36 Inch Spacing	
	30	36	Min	Max	Min	Max
4	120	144	9.2	207.9	7.7	173.3
8	240	288	4.6	104.0	3.9	86.6
12	360	432	3.1	69.3	2.6	57.8
16	480	576	2.3	52.0	1.9	43.3
24	720	864	1.5	34.7	1.3	28.9
36	1080	1296	1.0	23.1	0.9	19.3

Additional
model
options,
including
NEW flanges,
on page **11**.

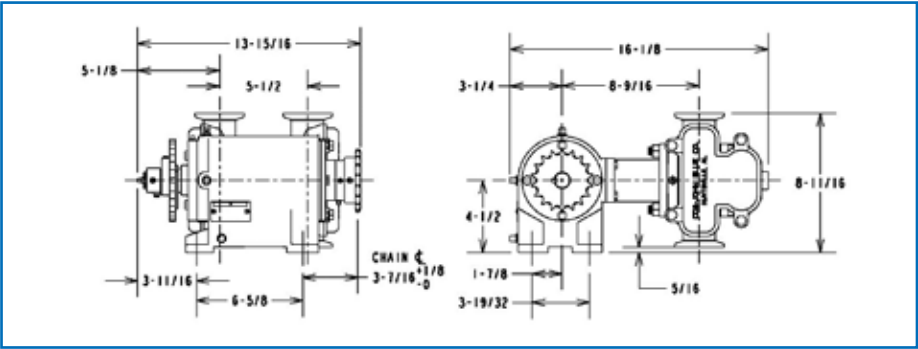

CDS-John Blue Piston Pumps



NEW NGP-4055-F Series*

Single Piston - Double Acting	Rated Speed - 450 RPM
Stroke - Variable	Inlet - 1" Inlet, 200 series flanges standard
Rated Flow - 10.2 GPM	Outlet - 1" Inlet, 200 series flanges standard
Rated Pressure - 120 PSI	Clutch - No Clutch

*Equivalent LM-1250 series

Rows	Swath in Inches		NGP-4055-F Application Range in GPA at 5 MPH			
			30 Inch Spacing		36 Inch Spacing	
	30	36	Min	Max	Min	Max
4	120	144	4.6	104.0	3.9	86.7
8	240	288	2.3	52.0	2.0	43.3
12	360	432	1.6	34.7	1.3	28.9
16	480	576	1.2	26.0	1.0	21.7
24	720	864	0.8	17.4	0.7	14.5
36	1080	1296	0.5	11.6	0.5	9.7

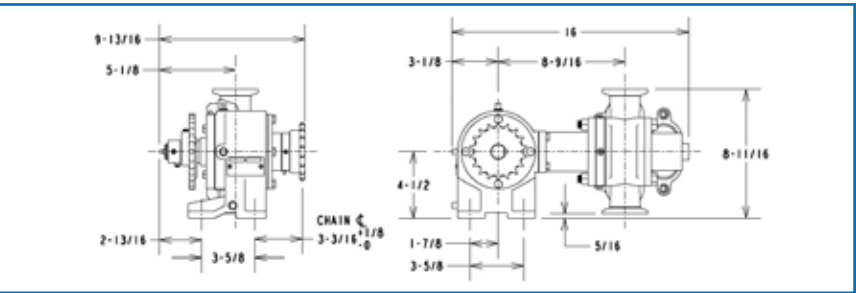

CDS-John Blue Technical Sales Department is available to answer all of your questions.

All calculations based on ground speed of 5 MPH.
Rated Flow Based on 12 lbs. per gallon fertilizer. 316 SS available on wet end casting.
Note: Standard Piston Pumps are manufactured with Viton Piston Packings and Buna o-rings and rod packings.



NEW NGP-5655-ARF Series

Apply two products at two rates with one pump
Max ratio 10 to 1, min ratio 2 to 1

Double Piston - Double Acting	Rated Speed - 450 RPM
Stroke - Variable	Inlet/Outlet small cylinder head - 1" FPT 200 series flanges
Rated Flow - 31.2 GPM total	Inlet/Outlet large cylinder head - 1-1/2" FPT 220 series flanges
10.2 GPM small side	Clutch - No Clutch
21 GPM large side	

Rows	Swath in Inches		NGP-5655-ARF Application Range in GPA at 5 MPH (small side of pump)			
			30 Inch Spacing		36 Inch Spacing	
	30	36	Min	Max	Min	Max
4	120	144	4.6	104.0	3.9	86.7
8	240	288	2.3	52.0	2.0	43.3
12	360	432	1.6	34.7	1.3	28.9
16	480	576	1.2	26.0	1.0	21.7
24	720	864	0.8	17.4	0.7	14.5
36	1080	1296	0.5	11.6	0.5	9.7

The chart above is for the small side of the pump. Calculate first the small side and then calculate the large side with the chart below

Rows	Swath in Inches		NGP-5655-ARF Application Range in GPA at 5 MPH (large side of pump)			
	30 Inch Spacing			36 Inch Spacing		
	30	36	Min	Max	Min	Max
4	120	144	9.2	207.9	7.7	173.3
8	240	288	4.6	104.0	3.9	86.6
12	360	432	3.1	69.3	2.6	57.8
16	480	576	2.3	52.0	1.9	43.3
24	720	864	1.5	34.7	1.3	28.9
36	1080	1296	1.0	23.1	0.9	19.3

The chart above is for the large side of the pump.

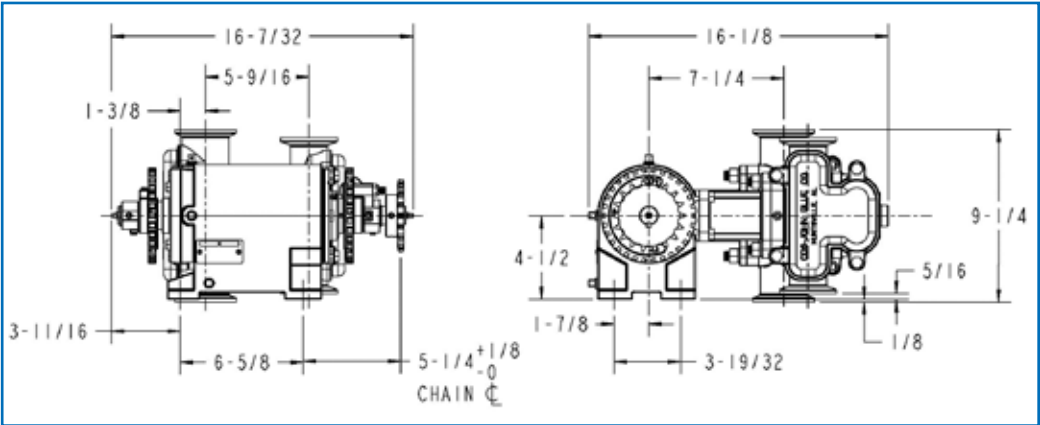

All calculations based on ground speed of 5 MPH.

Rated Flow Based on 12 lbs. per gallon fertilizer. 316 SS available on wet end casting.

Note: Standard Piston Pumps are manufactured with Viton Piston Packings and Buna o-rings and rod packings.



Visit our web site at www.cds-johnblue.com to easily calculate your flow rates.



NGP-6050 Series*

Single Piston - Double Acting	Rated Speed - 450 RPM
Stroke - Variable	Inlet - 1-1/2" FPT
Rated Flow - 21.0 GPM	Outlet - 1-1/2" FPT
Rated Pressure - 120 PSI	Clutch - Various Options

*Equivalent LM-2450 series

Rows	Swath in Inches		NGP-6055 Application Range in GPA at 5 MPH			
	30 Inch Spacing			36 Inch Spacing		
	30	36	Min	Max	Min	Max
4	120	144	9.2	207.9	7.7	173.3
8	240	288	4.6	104.0	3.9	86.6
12	360	432	3.1	69.3	2.6	57.8
16	480	576	2.3	52.0	1.9	43.3
24	720	864	1.5	34.7	1.3	28.9
36	1080	1296	1.0	23.1	0.9	19.3

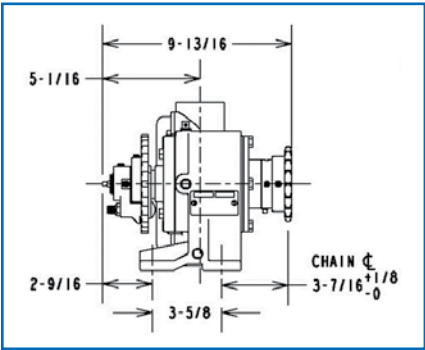
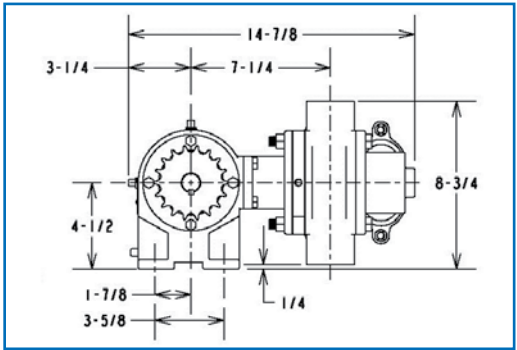

NGP-7050 Series*

Single Piston - Double Acting	Rated Speed - 450 RPM
Stroke - Variable	Inlet - 1-1/2" FPT
Rated Flow - 34.2 GPM	Outlet - 1-1/2" FPT
Rated Pressure - 120 PSI	Clutch - Various Options

*Equivalent LM-4450 series

Rows	Swath in Inches		NGP-7050 Application Range in GPA at 5 MPH			
	30 Inch Spacing			36 Inch Spacing		
	30	36	Min	Max	Min	Max
4	120	144	15.0	338.6	12.5	282.2
8	240	288	7.5	169.3	6.3	141.1
12	360	432	5.0	112.9	4.2	94.1
16	480	576	3.8	84.6	3.1	70.5
24	720	864	2.5	56.4	2.1	47.0
36	1080	1296	1.7	37.6	1.4	31.4

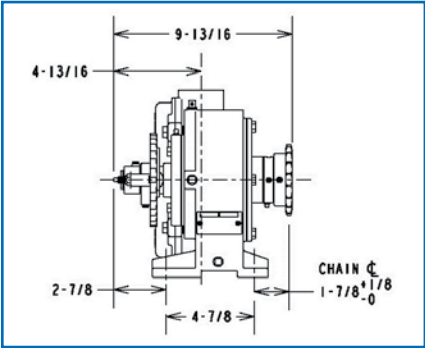
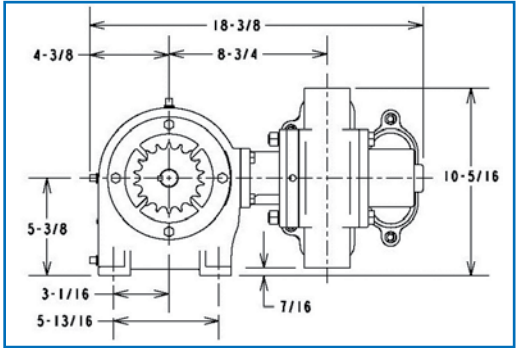

MODELS AVAILABLE:

- NGP-6050
- Rope Control Clutch
- NGP-6055
- Without Clutch
- NGP-6058
- Electric Control Clutch
- NGP-6059
- Hydraulic Control Clutch

MODELS AVAILABLE:

- NGP-7050
- Rope Control Clutch
- NGP-7055
- Without Clutch
- NGP-7058
- Electric Control Clutch
- NGP-7059
- Hydraulic Control Clutch

Select the Best CDS-John Blue Piston Pump to Fit Your Needs

Piston Pumps, Flanges & Flange Adaptors



Photo of DR Pump - Pump with independent dual inlet and outlet manifolds.

NGP-8050 Series

Double Piston - Double Acting	Rated Speed - 450 RPM
Stroke - Variable	Inlet - 1-1/2" FPT
Rated Flow - 42 GPM	Outlet - 1-1/2" FPT
Rated Pressure - 120 PSI	Clutch - Various Options

MODELS AVAILABLE:
NGP-8050
 Rope Control Clutch
NGP-8055
 Without Clutch
NGP-8058
 Electric Control Clutch
NGP-8059
 Hydraulic Control Clutch

Rows	Swath in Inches		NGP-8055 Application Range in GPA at 5 MPH			
			30 Inch Spacing		36 Inch Spacing	
	30	36	Min	Max	Min	Max
4	120	144	18.5	415.8	15.4	346.5
8	240	288	9.2	207.9	7.7	173.3
12	360	432	6.2	138.6	5.1	115.5
16	480	576	4.6	104.0	3.9	86.6
24	720	864	3.1	69.3	2.6	57.8
36	1080	1296	2.1	46.2	1.7	38.5

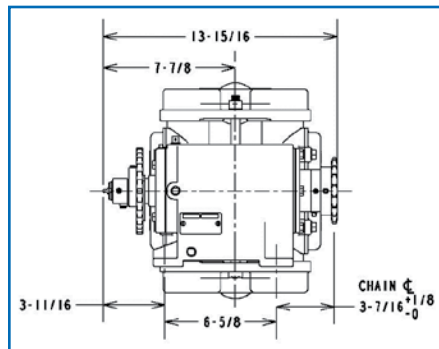
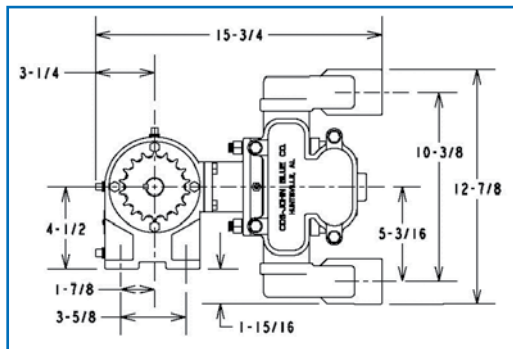

NEW NGP-8055-AR Dual Rate Piston Pump

Apply two products at two rates with one pump

Max ratio 5 to 1, min ratio 2 to 1

Double Piston - Double Acting	Rated Speed - 450 RPM
Stroke - Variable	Inlet - 1-1/2" FPT
Rated Flow - 42 GPM total	Outlet - 1-1/2" FPT
21 GPM per side	Clutch - No Clutch
Rated Pressure - 120 PSI	

Rows	Swath in Inches		NGP-8055-AR Application Range in GPA at 5 MPH			
			30 Inch Spacing		36 Inch Spacing	
	30	36	Min	Max	Min	Max
4	120	144	9.2	207.9	7.7	173.3
8	240	288	4.6	104.0	3.9	86.6
12	360	432	3.1	69.3	2.6	57.8
16	480	576	2.3	52.0	1.9	43.3
24	720	864	1.5	34.7	1.3	28.9
36	1080	1296	1.0	23.1	0.9	19.3

The chart above is for one side of the pump. Calculate first one side of the pump, and then calculate the second side.



NGP-9050 Series*

Double Piston - Double Acting	Rated Speed - 450 RPM
Stroke - Variable	Inlet - 1-1/2" FPT
Rated Flow - 68.4 GPM	Outlet - 1-1/2" FPT
Rated Pressure - 120 PSI	Clutch - Various Options

*Equivalent LM-4950 series

Rows	Swath in Inches		NGP-9055 Application Range in GPA at 5 MPH			
			30 Inch Spacing		36 Inch Spacing	
	30	36	Min	Max	Min	Max
4	120	144	30.1	677.2	25.1	564.3
8	240	288	15.0	338.6	12.5	282.2
12	360	432	10.0	225.7	8.4	188.1
16	480	576	7.5	169.3	6.3	141.1
24	720	864	5.0	112.9	4.2	94.1
36	1080	1296	3.3	75.2	2.8	62.7

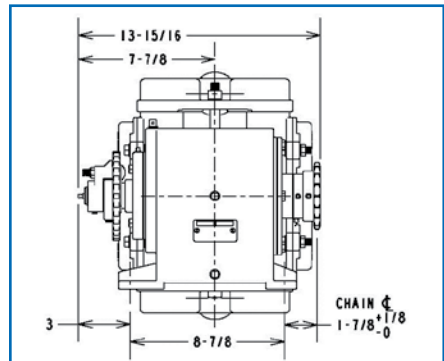
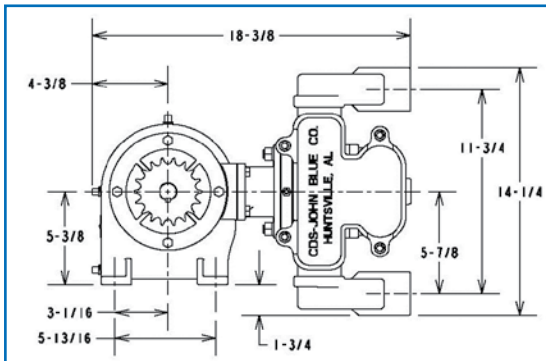

NEW - Flange and Flange Adapters

Part Number	Description
-F	Add -F after part numbers for flanges (photo left). Cast iron pumps have either 200 or 220 flanges with internal 1" or 1-1/2" ports depending on pump model. SS pumps have 220 flanges only.
116000-01S	1-1/2" NPT to 200 Series Flange Adapter, Stainless Steel
116083-01S	1-1/2" NPT to 220 Series Flange Adapter, Stainless Steel



Additional Model Options [-suffix]:

- DR** denotes independent dual inlet & outlet
- F denotes flanges
- K denotes pump less sprocket
- R denotes RC40 chain 18 tooth sprocket
- S denotes 316SS wet-end castings
- U denotes Viton wet-end o-rings and rod packing

** -DR only available on double piston NGP-5055-DRF, NGP-5655-DRF, NGP-8050 and NGP-9050

Additional Kit Modules (modifies existing pumps):

- 115670 Manual Clutch Add On - NGP Universal
- 115671 Hydraulic Clutch Add On - NGP Universal
- 115672 Electric Clutch Add On - NGP Universal
- 115673 Stainless Wet-End Conversion - NGP-6050 Series
- 115674 Stainless Wet-End Conversion - NGP-7050 Series
- 115675 Stainless Wet-End Conversion - NGP-8050 Series***
- 115676 Stainless Wet-End Conversion - NGP-9050 Series***

*** -DR pumps may use 2 single piston stainless conversion kits

All calculations based on ground speed of 5 MPH.

Rated Flow Based on 12 lbs. per gallon fertilizer. 316 SS available on wet end casting.

Note: Standard Piston Pumps are manufactured with Viton Piston Packings and Buna o-rings and rod packings.

Apply your liquid fertilizer with the best pump for the job while doing it easily with your hydraulic system. You don't need to buy new equipment to benefit from **Variable Rate Technology**. A great feature of the CDS-John Blue Piston Pump, with the Variable Rate Hydraulic Drive Kit (VRH), is that you can use it on your current equipment - planters, drills, strip till and liquid applicators. Regardless if your pump is 40 years old or new, the VRH Kits will mount to your pump (LF, L, LM and NGP series piston pumps). You can have tomorrow's technology today.



We have bar mount kits and direct drive kits to fit most common configurations. Our JD series fits **John Deere®** and the PWM (pulse width modulation) series is for **Raven®, Ag Leader®, Dickey-john®** plus others and can be used for variable rate and sectional shut-off as desired. The MAN (manual) series lets you use your tractor's hydraulics for a simple hydraulic driven system.

Features of the CDS-John Blue Variable Rate Hydraulic Drive Kits

- Base Kit to add variable rate capacity to a CDS-John Blue Piston Pump for your planter or applicator. Other required off-the-shelf components to complete the kit are detailed in the instructions.
- Existing pumps can be easily converted to **variable rate and sectional shut-off**.
- A piston pump allows for quick and stable adjustment to application rates within a fraction of a second using this technology.
- With a piston pump your application rates will not change with the temperature or lack of head pressure.
- Sturdy mounting bracket attaches to the side or top of the machine's bar.
- Two types of flow control valves (servo or PWM) are available based on the kit you select.
- Hydraulic 2-way bypass valve turns pump and liquid flow on and off (only on John Deere kits).
- Hydraulic motor requires 10 gpm to run the piston pump at maximum rpm, but the system can be used at lower gpm as the specific application allows.

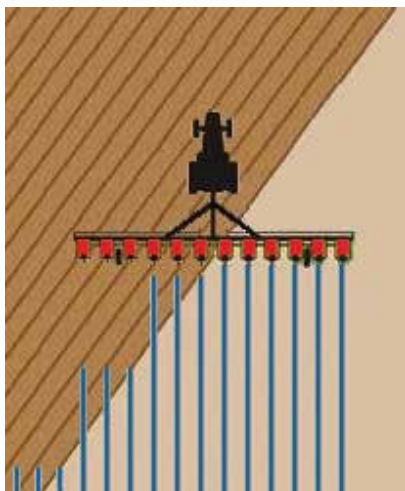

- The manual speed drive system allows you to mount your pump anywhere on the machine and set the pump at a constant speed.
- The manual speed drive can also be used with other brands of hydraulic flow control valves in order to interface with controllers that are not listed below.
- "Bracket only kits" allow the use of the **20/20 Precision Planting®** motor, **Dickey-john** motor and others.

Sectional shut-off and variable rate are easy with the CDS-John Blue System.

Bar Mount Kits

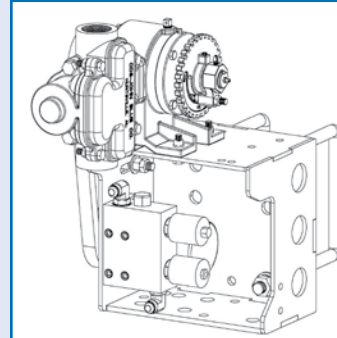

VRH-JD-10 and VRH-JD-15

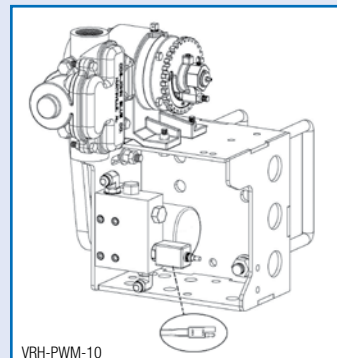

VRH-PWM-10

Direct Drive Kits

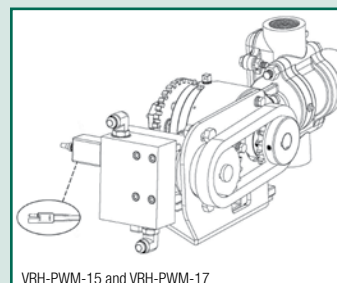

VRH-PWM-15 and VRH-PWM-17

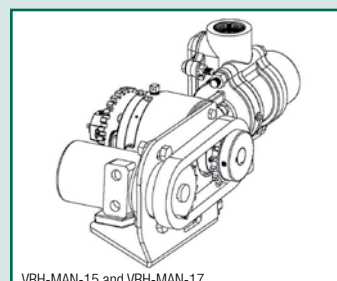

VRH-MAN-15 and VRH-MAN-17

VRH-JD-10 Variable Rate Hydraulic Drive Kit for John Deere CANbus Planters Using GreenStar™ GS2 and GS3. Kit includes: bar mounting bracket, chain, sprockets, hydraulic motor, PWM flow control manifold, custom adaptor harness and setup instructions with parts listing for obtaining off-the-shelf components to complete installation. Other applications may work, but CANbus wiring must be present.

VRH-JD-15 Multi-Section Variable Rate Hydraulic Drive Kit for John Deere CANbus Planters using GreenStar™ GS2 and GS3. Same as above except for harness to control up to 7 section valves. Other applications may work, but CANbus wiring must be present.

VRH-PWM-10 Variable Rate Hydraulic Drive Kit for Raven, Ag Leader, Trimble and other systems that can control a PWM valve. Motor has manifold with PWM valve and **Raven**-type plug. Kit includes: bar mounting bracket, chain, sprockets, hydraulic motor, PWM flow control manifold and setup instructions.

116133-91 Bracket-Only Drive Kit for use with 20/20 Precision Planting, DICKEY-john and Micro-Trak Drive Motors. Kit includes: bar mounting bracket (no motor), chain, sprockets and setup instructions.

VRH-MAN-10 Manual Rate/Speed Control Drive Kit for Remote Mounting of Drive. Kit includes: bar mounting bracket, chain, sprockets, ½" FPT port motor, ½" FPT manually adjusted in-line flow control valve, optical tachometer (to set pump speed) and setup instructions.

U-bolts for your bar size (two each required per drive):

7"x 7" Bar = 115907-01A
4"x 4" Bar = 115907-01B
4"x 6" Bar = 115907-01C
6"x 6" Bar = 115907-01D
9"x 9" Bar = 115907-01E &
116035-01 Bracket

116045-91 Universal Drive Kit for use with any Hydraulic Flow Control Valve. Motor has ½" female pipe ports for connection to your valve. Kit includes: bar mounting bracket, ½" FPT port motor (no flow control valve), chain, sprockets and setup instructions.

VRH-PWM-15 Variable Rate Hydraulic Drive Kit for Raven, Ag Leader, Trimble and other systems that can control a PWM valve. Motor has manifold with PWM valve and **Raven**-type plug. Kit includes: mounting bracket for **NGP-4055-F, 5055-DRF, 6055 and 8055** pumps, chain, sprockets, hydraulic motor, PWM flow control manifold and setup instructions.

VRH-PWM-17 Same as above except with bracket to fit **NGP-7055** and **NGP-9055**.

116131-91 Bracket-Only Drive Kit for use with 20/20 Precision Planting, DICKEY-john and Micro-Trak Drive Motors. Kit includes: mounting bracket for **NGP-4055-F, 5055-DRF, 6055 and 8055** pumps (no motor), chain, sprockets and setup instructions.

116132-91 Same as above except with bracket to fit **NGP-7055** and **NGP-9055**.

VRH-MAN-15 Manual Rate/Speed Control Drive Kit for Remote Mounting of Drive. Kit includes: mounting bracket for **NGP-4055-F, 5055-DRF, 6055 and 8055** pumps, chain, sprockets, ½" FPT port motor, manually adjusted in-line flow control valve, optical tachometer (to set pump speed) and setup instructions.

VRH-MAN-17 Same as above except with bracket to fit **NGP-7055** and **NGP-9055**.

116123-91 Universal Drive Kit for use with any Hydraulic Flow Control Valve. Motor has ½" female pipe ports for connection to your valve. Kit includes: mounting bracket for **NGP-4055-F, 5055-DRF, 6055 and 8055** pumps, ½" FPT port motor (no flow control valve), chain, sprockets and setup instructions.

116124-91 Same as above except with bracket to fit **NGP-7055** and **NGP-9055**.

Note: The 6055/8055 bracket will not fit NGP-5655-ARF and NGP-8055-AR. You must purchase a bar mount kit.

Call CDS-John Blue Company for technical support.
Visit our web site: www.cds-johnblue.com for VRH schematics and instruction manuals.

Newly Revised
Flow Divider

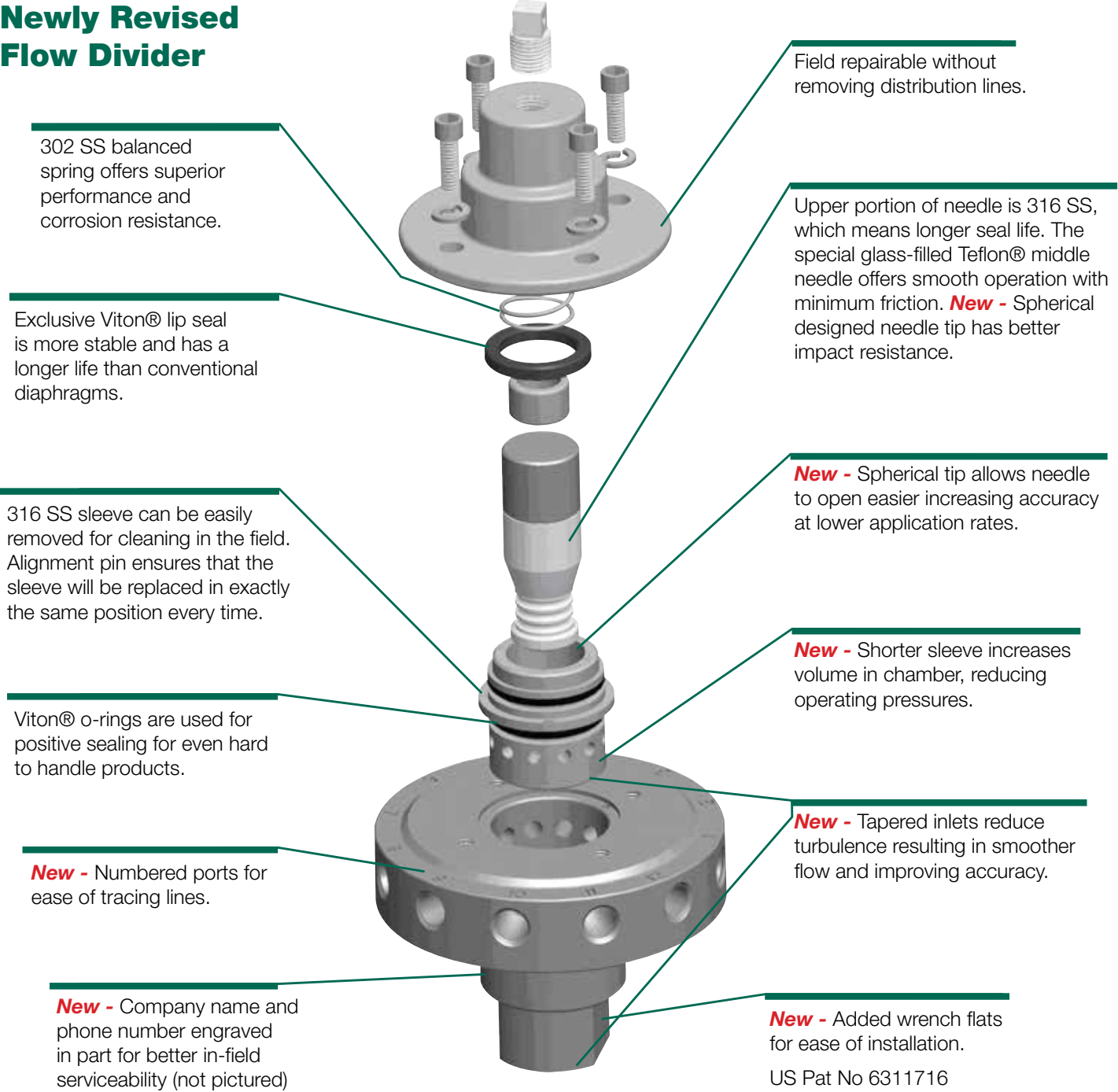

Flow Divider and Flow Divider Mount					
Part Number	Description	Outlets	Inlet	Outlet	Maximum Flow Outlet
FD-0610	Stainless Steel Flow Divider	6	3/4" FPT	1/4" FPT	2.25 GPM
FD-1210	Stainless Steel Flow Divider	12	3/4" FPT	1/4" FPT	2.25 GPM
FD-2010	Stainless Steel Flow Divider	20	1" FPT	1/4" FPT	2.25 GPM
113989	Manifold Mount				



NEW Flow Divider Adjustable Spring Kit
Features:

- Adjustable spring kit will enable you to balance multiple flow dividers.
- Kit may be purchased separately or pre-installed on any size flow divider.
- When using multiple flow dividers the same size flow dividers must be used.
- With multiple flow dividers the number of plugged outlets should be identical and the plugs equally spaced. The maximum recommended differential between flow dividers is two plugged ports.

Flow Divider Adjustable Spring Kits	
Part Number	Description
FD-0610-ADJ	6 Outlet Stainless Steel Flow Divider with Adjustable Spring Kit
FD-1210-ADJ	12 Outlet Stainless Steel Flow Divider with Adjustable Spring Kit
FD-2010-ADJ	20 Outlet Stainless Steel Flow Divider with Adjustable Spring Kit
116063*	FD-0610 Retrofit Kit
116064*	FD-1210 Retrofit Kit
116065*	FD-2010 Retrofit Kit

*Kit will include the adjustment bolt, nut, spring seat, cap with straight threads (for 12 and 20 port kits) and vented plug.

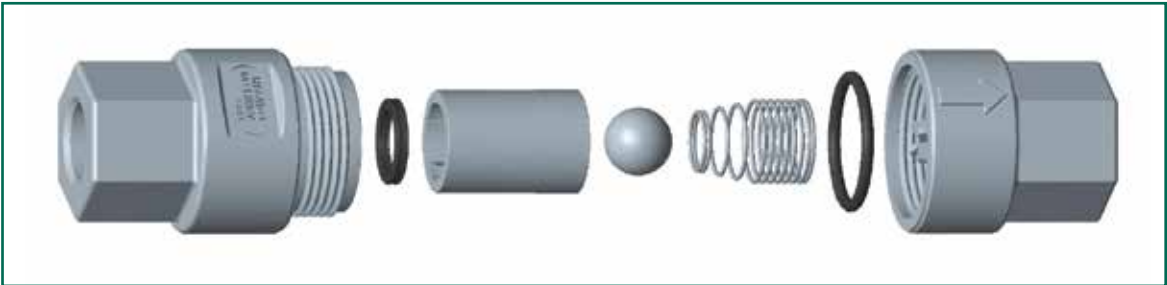

NEW Delivery Line Check Valves and Push Connect Fittings

- New and Improved
- Easy to Clean
- Repairable
- Easier to service in the field
- 1 psi
- Precision molded in glass-reinforced polypropylene
- 316 stainless steel ball and spring
- All Viton seals

Poly Applicator Check Valves	
Part Number	Description
CV-1101	Poly Check Valve, 1/4" NPT Female Inlet and Outlet
NEW CV-1101-P14	Poly Check Valve, 1/4" Push Connect Inlet and Outlet
NEW CV-1101-P56	Poly Check Valve, 5/16" Push Connect Inlet and Outlet
NEW CV-1101-P38	Poly Check Valve, 3/8" Push Connect Inlet and Outlet
CV-1101-B14	Poly Check Valve, 1/4" Hose Barbs Inlet and Outlet, replaces 115284-01
CV-1101-B38	Poly Check Valve, 3/8" Hose Barbs Inlet and Outlet, replaces 115285-01
CV-1101-B12	Poly Check Valve, 1/2" Hose Barbs Inlet and Outlet, replaces 115286-01

*3 psi spring and 11/16" straight inlet/outlet threads are available.



Know The Flow - Apply With Accuracy

Monitoring flow rates of your liquid fertilizers and herbicides just got easier with the cost-effective, simple to install, VisaGage II. This CDS-John Blue Flow Monitor enables growers to easily monitor flow rates of liquid fertilizers and herbicides, which helps to improve efficiency and profitability.

CDS-John Blue Company is offering flow monitors for spraying or fertilizer applications in single columns or in sets of four flow monitor assemblies. Plus most CDS-John Blue Flow Monitor parts are interchangeable with other brands already on the market today.



CDS-John Blue VisaGage II is manufactured with chemical resistant polypropylene adapters and clear PVC body with an additive for UV protection. Viton o-rings are also standard.

The newly released **Fumigant VisaGage II** is made from polymethylpentene (TPX®) chemical resistant bodies with UV protection. The Fumigant VisaGage II is ideal for Telone applications.

Proper Application = Increased Yields

- With the CDS-John Blue VisaGage II you will know immediately if an outlet is plugged, thus causing possible variations in your application rates.
- So easy - See the balls in line and know your rate is uniform.
- When the ball is lower you know there is a restriction at the outlet, hose or opener supplied by that flow monitor.
- A ball higher than the others is an indication that hoses or fittings supplied by that specific flow monitor is broken or has a leak.

Customize Your Visual Flow Monitor System

- Get the exact number of flow monitors for spraying or fertilizer applications by simply banking single columns or sets of 4 Flow Monitors or any combination you choose. Clasp them together with the stainless steel clips and Viton O-rings and go.
- The CDS-John Blue VisaGage II allows the use of common stainless steel orifice plates.
- Ports are standard NPT - Use our barb or convenient push connect fittings for simple installation.
- Most parts are interchangeable with other brands.
- **NEW** - Now available with push connect fittings and can also be purchased for existing VisaGage II Flow Monitors.



SMSS4 with SMPT-0053

For Use with Sprayers	
Part Number*	Description
SMSS1	Single Flow Monitor Assembly - Spray Type includes single body, 3/8" NPT female inlet and outlet, (5) 1/2" diameter balls, end cap, Viton O-rings and stainless steel retainer clips.
SMSS4	Set of 4 Flow Monitor Assembly - Spray Type includes 4 bodies, 1/2" NPT female inlet, 3/8" NPT female outlet, (20) 1/2" diameter balls, end cap, Viton O-rings and stainless steel retainer clips.

*add -fum after part number for fumigant models.



SMFD4

For Use with Flow Dividers or Squeeze Tube Pumps	
Part Number*	Description
SMFD1	Single Flow Monitor Assembly - Flow Divider Type includes single flow divider monitor body, 3/8" NPT female inlet and outlet, (5) 1/2" diameter balls, end cap, Viton O-rings and stainless steel retainer clips.
SMFD4	Set of 4 Flow Monitor Assembly - Flow Divider Type includes 4 bodies, 3/8" NPT female inlet and outlet, (20) 1/2" diameter balls, end cap, Viton O-rings and stainless steel retainer clips.

*add -fum after part number for fumigant models.



SMPT-009

Miscellaneous Components	
Part Number	Description
NEW SMPT-007	O-ring
SMPT-0009	Ball storage unit - optional - holds up to 40 balls (use one per set of 8 bodies). Lid can be locked.
SMPT-0014	Tee - optional - for spray type use with typically 8 total bodies, 1" NPT female inlet port and 1/4" female NPT port for gauge.
SMPT-0021	7/16" Stainless Steel Ball - optional - for use with extra high flow rates.
SMPT-0034	#112 Viton O-ring - optional - used to seal orifice plates, install plate in recess of the 3/8" NPT port adapters and then install the O-ring to retain and seal orifice plate.
NEW SMPT-0049	Flanged Tee - optional - for spray type use with typically 8 total bodies, 100 series flange with o-rings and 1/4" female NPT port for gauge.
NEW SMPT-0050	Yellow Ball - optional - 13% heavier than the blue plastic ball and lighter than the glass ball that comes standard with the VisaGage II.
NEW SMPT-0051	1/4" Tube Push Connect Elbow Adapter, use existing VisaGage o-ring.
NEW SMPT-0052	5/16" Tube Push Connect Elbow Adapter, use existing VisaGage o-ring.
NEW SMPT-0053	3/8" Tube Push Connect Elbow Adapter, use existing VisaGage o-ring.

Update Your John Deere™ Equipment with the Latest Technology from CDS-John Blue Company

CDS-John Blue Company has developed the following kits to make it easier to use CDS-John Blue products on your John Deere Planter.



Kits for converting the 1770NT John Deere Port Manifold System to the CDS-John Blue Flow Divider (for planters built 2012 and after).

Part Number	Description
116098 (16 row)	Kit includes 16 outlet Flow Divider, (16) 1 psi Check Valves and all necessary plumbing.
116099 (12 row)	Kit includes 12 outlet Flow Divider, (12) 1 psi Check Valves and all necessary plumbing.

*VisaGage II's are available, see pages 14-15.

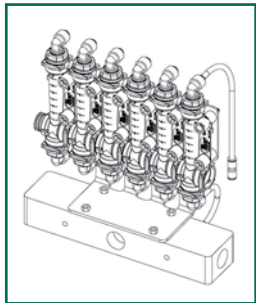

VisaGage II Kits when just adding flow monitors to your 1770NT John Deere Planter (planters built 2012 and after). Kits will bolt directly to your manifold.

Part Number	Description
NEW 116150 (24 row)	Kit includes (6) sets of 4 Flow Monitor Assemblies, backing plate, mounting bracket, tubing and all necessary plumbing.
116107 (16 row)	Kit includes (4) Sets of 4 Flow Monitor Assemblies, backing plates, mounting brackets, tubing and all necessary plumbing.
116108 (12 row)	Kit includes (3) Sets of 4 Flow Monitor Assemblies, backing plates, mounting brackets, tubing and all necessary plumbing.
NEW 116151 (8 row)	Kit includes (2) sets of 4 Flow Monitor Assemblies, backing plate, mounting bracket, tubing and all necessary plumbing.

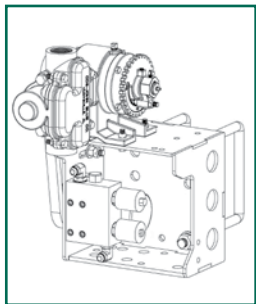

Variable Rate Hydraulic (VRH) Drive Kits for John Deere Planters

Part Number	Description
VRH-JD-10	VRH Kit for John Deere CANbus Planters Using GreenStar™ GS2 and GS3. Kit includes: mounting bracket, chain, sprockets, hydraulic motor, PWM flow control manifold, custom adaptor harness and setup instructions with parts listing for obtaining off-the-shelf components to complete installation. Other applications may work, but CANbus wiring must be present.
VRH-JD-15	Multi-Section VRH Drive Kit for John Deere CANbus Planters using GreenStar™ GS2 and GS3. Kit includes same as above except for harness to control up to 7 section valves. Other applications may work, but CANbus wiring must be present.

Visit www.cds-johnblue.com for complete instruction/installation manuals.



Upgrade your existing LM Piston Pump with the proven NGP Piston Pump. Plus we offer new dual adjustable rate pumps, apply two products at two rates with one pump – perfect for starter fertilizer and nitrogen applications, see pages 6-11.



New 6 Outlet Flow Divider complements our newly revised 12 and 20 outlet flow dividers. The 6-outlet is ideal for sectional shut-off. Also available is our new Flow Divider Adjustable Spring Kits for balancing multiple flow dividers. See pages 16-17 for more details.



New Serviceable Poly delivery line Check Valves. The CDS-John Blue Check Valves stop unwanted drips, directly replaces existing check valves and are cleanable in the field. More consistent opening pressures than most other check valves. Select your desired end connections including push connect fittings, see page 17.



Oval-Shaped Tube with Built-in Backing Plate Squeeze Tube Pump

Oval-shaped tubes with built-in backing plate insure accurate rates. The positive shut-off is due to the positive sealing tubes.

Sealed-for-life bearings require no lubrication.

Rubber-coated rollers are easily replaced in the field, plus non-metallic roller surfaces reduce abrasion, resist corrosion and etching by fertilizers.

Heavy-duty PVC manifolds are ideal for all fertilizers including acid-based products.

Sturdy, all metal frame.

8-48 outlets are available. Outlets can be doubled for higher rates.

Pump shaft lets you drive the unit from either side.

Multiple-coned sprockets come standard allowing for seven different delivery rates.

Round Hose with Patented Spring Loaded Back Plate Squeeze Tube Pump

Patented spring loaded back plate insures accurate rates.

Positive shut-off when pump stops.

6-16 outlets are available.

Fittings can be relubricated to flush out contamination.

Heavy cast iron frame.

Choice of optional individual sprockets or complete cluster sets.

See our complete line of CDS-John Blue Squeeze Pumps on pages 22-23.



Squeeze Pump Specifications

Hose Size	Maximum Output Per Hose	Maximum Speed	Maximum Pressure	Rate Range GPA
Oval Shaped Tube With Built-in Backing Plate Squeeze Pump				
3/8"	.63 gpm	100	6 psi	1.5-25*
5/8"	1.26 gpm	100	6 psi	3-50*

Round Hose Spring Loaded Back Plate Squeeze Pump				
5/16"	.58 gpm	125	6 psi	3-23**
1/2"	1.4 gpm	125	6 psi	7-55**

*Maximum GPA rating based on 5 MPH, 30 inch rows. Minimum is based on 24 pulses per minute.
**Maximum rating based on 5 MPH, 30 inch rows. Minimum is based on 48 pulses per minute.

Models Available for Oval-shaped Squeeze Tube Pump with Built-in Backing Plate

Standard Models					
Part Number	Number of Rows	Metering Hose Size	GPA	Discharge Hose Size	Suction Hose Port
8B-1	8	3/8"	1.5-25	3/8"	1 1/4" FPT
8L	8	5/8"	3-50	1/2"	1 1/4" FPT
12B-1	12	3/8"	1.5-25	3/8"	1 1/4" FPT
12L	12	5/8"	3-50	1/2"	1 1/4" FPT
16B-1	16	3/8"	1.5-25	3/8"	1 1/4" FPT
16L	16	5/8"	3-50	1/2"	1 1/4" FPT
24B-1	24	3/8"	1.5-25	3/8"	1 1/4" FPT

Hydraulic Models					
8B-IH	8	3/8"	1.5-25	3/8"	1 1/4" FPT
8L-H	8	5/8"	3-50	1/2"	1 1/4" FPT
12B-IH	12	3/8"	1.5-25	3/8"	1 1/4" FPT
12L-H	12	5/8"	3-50	1/2"	1 1/4" FPT
16B-IH	16	3/8"	1.5-25	3/8"	1 1/4" FPT
16L-H	16	5/8"	3-50	1/2"	1 1/4" FPT

Combination Pump Models					
8B-1/8L	16	3/8 & 5/8"	1.5-50	3/8 & 1/2"	1 1/4" FPT
8L-H	8	5/8"	3-50	1/2"	1 1/4" FPT

Double Pump Models					
24LD	24	5/8"	3-50	1/2"	1 1/4" FPT
32BD-1	32	3/8"	1.5-25	3/8"	1 1/4" FPT
40BD-1	40	3/8"	1.5-25	3/8"	1 1/4" FPT
48BD-1	48	3/8"	1.5-25	3/8"	1 1/4" FPT

Note: B-1 Pumps have stainless steel fittings.
L Pumps have plastic fittings.
Combination Pumps have B-1 Pump at front (input drive end).

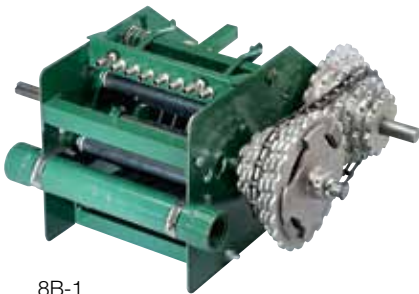

8B-1

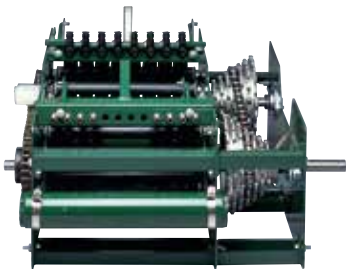

Combination Pump 8B-1/8L

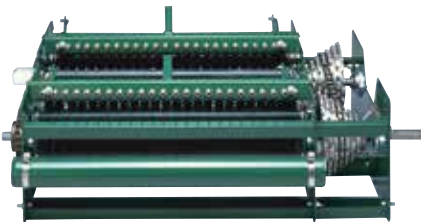

Double Pump 48BD-1

Models Available for Round Hose Spring Loaded Back Plate Squeeze Tube Pump

Standard Models					
Part Number	Number of Rows	Metering Hose Size	GPA	Discharge Hose Size	Suction Hose Size
L-6-C	6	1/2"	7-55	1/2"	1"
L-8-C	8	5/16"	3-23	3/8"	1"
L-8LC	8	1/2"	7-55	1/2"	1 1/4"
L-12-SC	12	5/16"	3-23	3/8"	1 1/4"
L-12-C	12	1/2"	7-55	1/2"	1 1/4"
L-16-C	16	5/16"	3-23	3/8"	1 1/4"

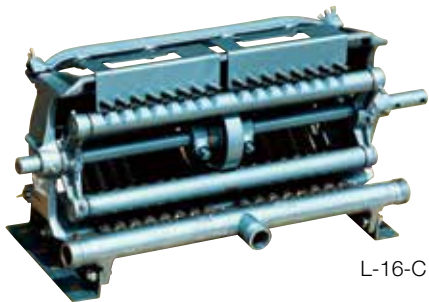

L-16-C

Pump Drives and Optional Accessories - Also see pages 12-13

Standard Models	
Part Number	Description
L-4512	Sprocket Package - Base: includes (2) L-1414 & (2) L-4414; 10T, 15T, 20T, 22T & 26T sprockets.
L-4513	Sprocket Package - Complete: includes L-1414 & L-4414; 8T, 9T, 10T, 15T, 22T, 23T, 26T, 30T & 31T sprockets.
114272	Sprocket Cluster for the round tube squeeze pump containing 10T, 15T, 20T, 22T, 26T sprockets.

Miscellaneous Components

Part Number	Description	Part Number	Description
111698-01	Hub Adaptor-4 Hole	L-1383	8 Tooth Sprocket
111699-02	Hub Adaptor-5 Hole	L-1384	9 Tooth Sprocket
112612-01	Hub Adaptor-6 Hole	L-1385	10 Tooth Sprocket
L-1414	Sprocket Adaptor - 7/8" Bore	L-1386	15 Tooth Sprocket
L-1414-1	Sprocket Adaptor - 1" Bore	L-1381	20 Tooth Sprocket
L-1414-2	Sprocket Adaptor - 3/4" Bore	L-1387	22 Tooth Sprocket
L-4414	Sprlcket Retainer - 7/8" Bore	L-1388	23 Tooth Sprocket
L-4414-1	Sprocket Retainer - 1" Bore	L-1389	26 Tooth Sprocket
L-4414-2	Sprocket Retainer - 3/4" Bore	L-1390	30 Tooth Sprocket
112838	Sprocket Retainer - 7/8" Hex	L-1391	31 Tooth Sprocket
112839	Sprocket Adaptor - 7/8" Hex	L-1392	32 Tooth Sprocket
114565-91	35 Tooth Split Sprocket for 7/8" Hex Shaft	114936-91	32 Tooth Split Sprocket for 7/8" Hex Shaft

See our complete line of ground drives on pages 12-13.

Repair Parts Available on Page 69-70.



113983



114015



113934



114382

Features of the Stainless Manifolds:

- The CDS-John Blue manifold can be used with clear liquids for even distribution when used with proper size orifices for high pressure distribution systems such as orifices, coulter injection or nozzles.
- By interchanging the orifice size you can adjust the application range.
- The CDS-John Blue manifolds are constructed of domestic investment cast stainless steel, which will last for many years.
- Heavy duty, cast iron manifolds are also available.

Manifolds and Mounts

Part Number	Description	Number of Outlets	Rating PSI	Construction	Inlet	Outlet
113983	NH3 Manifold w/ Flow Diffusor	12	150	304 SS	1" FPT	1/4" FPT
113934	Liquid Manifold	12	250	304 SS	1" FPT	1/4" FPT
114015	Liquid Manifold	4	250	304 SS	1 1/2" FPT	3/4" FPT
114382	Liquid Manifold	16	250	304 SS	1" FPT	1/4" FPT
102175	NH3 Manifold	24	N/A	Cast Iron	1" FPT	1/4" FPT
A-526-L	Liquid Manifold	8	N/A	Cast Iron	3/4" FPT	1/4" FPT
A-1402-L	Liquid Manifold	12	N/A	Cast Iron	3/4" FPT	1/4" FPT
L-1730	Liquid Manifold	3	N/A	Polyethylene	3/4" FPT	3/8" FPT
113989	Manifold Mount for 113934, 113983 and 114382	N/A	N/A	N/A	N/A	N/A
114106	Manifold Mount for 114015	N/A	N/A	N/A	N/A	N/A

Features of the CDS-John Blue In-Line Strainers:

- In-line strainers clean foreign materials and large particles from pesticides and fertilizer solutions to ensure good distribution whether spraying or applying below the surface.
- Heavy duty cast iron body and stainless steel screens means a long life.
- Provides a well-mixed solution, clear of clogging particles and debris.

In-line Strainers

Part Number	Description	Mesh Size	Inlet	Outlet
L-1116	For use with L-1094	30 Mesh	1 1/4" Hose	1 1/4" Hose
L-4001	For use with L-4400, LM-4450 and LM-2450	30 Mesh	1 1/2" Hose	1 1/2" Hose
L-3120	For use with LM-4950	30 Mesh	2" Hose	2" Hose
L-3422	Nylon Strainer	40 Mesh	3/4" FPT	3/4" FPT

Check Valves - Used with Flow Dividers and Manifolds

Part Number	Description
NS-3030	Stainless steel - 1/4" FPT with nozzle cap
NS-3032	Stainless Steel - 1 1/16" Female threads with nozzle cap
NS-3035	Nylon, in-line - 3/8" hose x 3/8" hose
113827	Nylon, in-line 1/2" hose x 1/2" hose
CV-1101	Poly Check Valve, 1/4" NPT Female Inlet and Outlet, 1 psi
CV-1101-B14	Poly Check Valve, 1/4" Hose Barbs Inlet and Outlet, 1 psi, replaces 115284-01
CV-1101-B38	Poly Check Valve, 3/8" Hose Barbs Inlet and Outlet, 1 psi, replaces 115285-01
CV-1101-B12	Poly Check Valve, 1/2" Hose Barbs Inlet and Outlet, 1 psi, replaces 115286-01

Hose Barbs - Used with Flow Dividers and Manifolds

Part Number	Description	MPT Size	Hose Size
A-94	Hose coupling, steel	1/4"	1/4"
A-94-A	Hose coupling	1/4"	3/8"
A-94-AS	Hose coupling, stainless steel	1/4"	3/8"
A-94-S	Hose couple	1/8"	1/4"
A-7786	Hose coupling, steel	1/4"	1/2"
S-2927	Hose coupling, nylon	1/4"	3/8"
T-2207	Hose insert, nylon	1/4"	1/2"



For the complete line of CDS-John Blue Piston Pumps see pages 6-11.



The CDS-John Blue Impellicone is a flow divider designed for Anhydrous Ammonia (NH₃). It distributes NH₃ to multiple rows across an applicator with the accuracy and flexibility you have come to expect from CDS-John Blue Products. Impellicone's name comes from the unique shaped needle, which spins and mixes the liquid and gas phases distributing them evenly to the number of outlets you need. The CDS-John Blue Impellicone can be used for all NH₃ applications at normal rates, while also offering the flexibility to plug unused outlets without sacrificing accuracy. A simple design allows for ease of service without removing the distribution lines, however it is recommended that proper handling techniques for NH₃ be used at all times. The Impellicone's superior accuracy allows better control of targeted rates greatly reducing the over-application of NH₃. This will result in less nitrogen leaching, lower crop yield variability and ultimately lowering overall application costs.

After extensive testing through Iowa State, field trials and a lengthy approval process, CDS-John Blue Company is proud to offer patented technology in three models, IP-0600 (6-outlet), IP-1300 (13 outlet) and IP-1800 (18 outlets).

CDS-John Blue Impellicone Flow Dividers			
Part Number	Description	Inlet Size	Outlet Size
NEW IP-0600	6 Outlet NH ₃ Flow Divider	1" NPT	1/4" NPT
IP-1300	13 Outlet NH ₃ Flow Divider	1" NPT	1/4" NPT
IP-1800	18 Outlet NH ₃ Flow Divider	1" NPT	1/4" NPT

CDS-John Blue Splitter Distribution Manifold,
a Precision Manifold for Anhydrous Ammonia



NEW IPS-6 Splitter

The CDS-John Blue Precision Splitters should be used when three, four or six CDS-John Blue Impellicones are used in parallel.

Anhydrous Ammonia Splitters and Manifolds						
Part Number	Type	Description	Number of Outlets	Inlet	Outlet	Gauge Port
IPS-3		3-Port Impellicone Splitter	3	1 1/4" FPT	1" NPT	
IPS-4		4-Port Impellicone Splitter	4	1 1/4" FPT	1" NPT	
NEW IPS-6		6-Port Impellicone Splitter	6	1 1/4" FPT	1" FPT	
113989		Manifold Mount				
113983	Plain Manifold	Inlet Flow Diffuser, 304 SS Construction	12	1" FPT	1/4" FPT	N/A
A-3744-B	Plain Manifold	Inlet Flow Diffuser, Cast Iron Construction	13	1" FPT	1/4" FPT	N/A
102175	Plain Manifold	Inlet Flow Diffuser, Cast Iron Construction	24	1" FPT	1/4" FPT	N/A



A-720C-4



A-720C-4S



A-460BC-3

A-Series Stainless Steel Tubes on Heavy Duty Knives

Features:

- Heat-treated after coating to assure strength and wearability.
- High carbon 1080 steel makes the knife strong and tough.
- Plain tube or 304 stainless steel tube.
- Available with extremely hard boride coating for long wear life.
- Largest toe section on any knife in the industry.

NH3 Liquid Blades						
Part Number	Blade Type	Number of Tubes	Tube Material	Tube Size	Sealer	Boride Coating
A-460BC-3	Back Swept	Single	Stainless Steel	3/8"	No	Yes
A-460BC-3S	Back Swept	Single	Stainless Steel	3/8"	Yes	Yes
A-460BC-3SP	Back Swept	Single	Plain	3/8"	Yes	Yes
A-460BC-4	Back Swept	Single	Stainless Steel	1/2"	No	Yes
A-460BC-4P	Back Swept	Single	Plain	1/2"	No	Yes
A-720-3	Front Swept	Single	Stainless Steel	3/8"	No	Yes
A-720-3P	Front Swept	Single	Plain	3/8"	No	No
A-720-3S	Front Swept	Single	Stainless Steel	3/8"	Yes	No
A-720-3SP	Front Swept	Single	Plain	3/8"	Yes	No
A-720-4	Front Swept	Single	Stainless Steel	1/2"	No	No
A-720-4P	Front Swept	Single	Plain	1/2"	No	No
A-720-4S	Front Swept	Single	Stainless Steel	1/2"	Yes	No
A-720-4SP	Front Swept	Single	Plain	1/2"	Yes	No
A-720C-3	Front Swept	Single	Stainless Steel	3/8"	No	Yes
A-720C-3P	Front Swept	Single	Plain	3/8"	No	Yes
A-720C-3S	Front Swept	Single	Stainless Steel	3/8"	Yes	Yes
A-720C-3SP	Front Swept	Single	Plain	3/8"	Yes	Yes
A-720C-4	Front Swept	Single	Stainless Steel	1/2"	No	Yes
A-720C-4P	Front Swept	Single	Plain	1/2"	No	Yes
A-720C-4S	Front Swept	Single	Stainless Steel	1/2"	Yes	Yes
A-720C-4SP	Front Swept	Single	Plain	1/2"	Yes	Yes
AD-720C	Front Swept	Dual	Stainless Steel	(1) 3/8" front & (1) 1/2" rear	No	Yes
AD-720C-3	Front Swept	Dual	Stainless Steel	3/8"	No	Yes
AD-720C-4	Front Swept	Dual	Stainless Steel	1/2"	No	Yes



R-481

R-Series CDS-John Blue Replacement Knives:

- High strength ductile knife.
- Easy to replace (R-483) tube.
- Hard facing to protect the tube.
- Easy replacement - only one pin is needed to replace (R-482) toe, no cutting or welding is required.

Replaceable Knife and Components		
Part Number	Blade Type	Description
R-481	Front Swept	Heavy Duty Blade - Super Ductile Iron With Replaceable Toe & Tube
R-482	Front Swept	Replaceable Toe - Ductile Iron, Replacement for R-473 & R-481 Blades
R-483	Front Swept	Replaceable Tube - 1/8" Steel, Replacement for R-481 & R-484 Blades

“CDS-John Blue Company is an industry leader with significant name recognition and a superb reputation in the field. Our customers demand CDS-John Blue Pumps because they have proven to be a reliable and effective tool for the agricultural industry.”

Ed Wunsch
Vice President
Big W Sales, CA

CDS-John Blue Products Deliver the Features and Durability
You Can Depend On - Year After Year!



CDS-John Blue Centrifugal Pumps
Are Designed To Outlast Your Equipment

For over 125 years, CDS-John Blue Company has been committed to creating pumps that deliver uncommon performance, quality and value. We are committed to using new technologies, materials and engineering techniques that lead to breakthroughs in pump performance and handling. **Let us show you the CDS-John Blue Centrifugal Pumps that can be run dry without damaging the seal - at a price you can afford.**



Features:

- Patented Vac-U-Seal impeller design creates a vacuum between the impeller and mechanical seal. Lack of pressure on the seal face minimizes seal wear and results in a longer seal life.
- Double wet seal design provides for continuous lubrication of the seal faces. This wet seal design allows the pump to be run dry for extended periods with no damage to the mechanical seal faces.
- Closed impeller design minimizes thrust loading on the drive motor extending the life of the drive motor. Impeller wear actually increases performance - CDS-John Blue Centrifugal Pumps get better with use!
- Extra thick cast walls provide extra strength and extend the life of the unit due to abrasion and corrosion.

2 Year Unconditional Warranty on Pumps
Who Else Can Do This?



SP-3320-BS



SP-3320-G13H



S-3220-E

Part Number	Pump Type*	Max Capacity GPM	Max Pressure PSI	Max Speed RPM	Max Power** HP	Inlet & Outlet FPT
Pumps For Gasoline Engines - Note: A Base Mounting for Engine Required***						
S-3220	2" Straight, 3/4" Shaft	197	39	3500	5	2"
S-3320	3" Straight, 1 1/8" Shaft	365	60	3500	10	3"
SP-3220	2" Self-Priming, 3/4" Shaft	152	42	3500	5	2"
SP-3320	3" Self-Priming, 1 1/8" Shaft	308	65	3500	10	3"
S-3320-BS	3" Straight, 1" Shaft	365	60	3500	10	3"
SP-3320-BS	3" Self-Priming, 1" Shaft	308	65	3500	10	3"

- NEW LCT Engines available in 5 HP recoil start and 13 HP electric start.
- NEW Keyed shaft clamp standard on 3" -BS gasoline engine pumps.
- NEW Carbide seals available on 2" and 3" pumps, add -C after part number.

Pumps Coupled To Gasoline Engines						
S-3220-G5H	2" Straight, 5 HP Honda Engine With Base	197	39	3500	5	2"
SP-3220-G5H	2" Self-Priming, 5 HP Honda Engine With Base	152	42	3500	5	2"
SP-3320-G13H	3" Self-Priming, 13 HP Honda, Electric Start, Engine With Base	308	65	3500	13	3"

- NEW LCT Engines available. 5 HP engine add -G5LCT after part number. 13 HP engine add -G13LCT after part number.

Pumps for Electric Motors						
S-3220-E	2" Straight, 3/4" Shaft	197	39	3500	5	2"
S-3320-E	3" Straight, 1 1/8" Shaft	365	60	3500	10	3"
SP-3220-E	2" Self-Priming, 3/4" Shaft	152	42	3500	5	2"
SP-3320-E	3" Self-Priming, 1 1/8" Shaft	308	65	3500	10	3"

* Pump size given in inches refers to inlet and outlet sizes.
** Power based on electric motor with full voltage and pumping water.
*** 2" base order S-3321, 3" base order S-3336

Repair parts available on Page 68.

Flanges now available on CDS-John Blue Centrifugal Pumps see page 32.

Centrifugal Pumps

Irrigation Injection Pumps



SP-3320-E15TB



SP-3320-P



SP-3220-PH



NEW SP-3320-FLG

Part Number	Pump Type*	Max Capacity GPM	Max Pressure PSI	Max Speed RPM	Max Power** HP	Inlet & Outlet FPT
Pumps Coupled To Electric Motors						
S-3220-E5D3	2" Straight, 5 HP 3 Phase	197	39	3500	5	2"
S-3320-E10T	3" Straight, 10 HP Electric TEFC, 3 Phase	365	60	3500	10	3"
S-3320-E15T	3" Straight, 15 HP Electric TEFC, 3 Phase	365	60	3500	15	3"
SP-3220-E5D3B	2" Self-Priming 5 HP Electric Drip Proof, 3 Phase With Base	152	42	3500	5	2"
SP-3220-E5T3B	2" Self-Priming 5 HP Electric TEFC, 3 Phase With Base	152	42	3500	5	2"
SP-3320-E10TB	3" Self-Priming 10 HP Electric TEFC, 3 Phase	308	65	3500	10	3"
SP-3320-E10TB-1	3" Self-Priming 10 HP Electric TEFC, 1 Phase	308	65	3500	10	3"
SP-3320-E15TB	3" Self-Priming 15 HP Electric 3 Phase With Base	308	65	3500	15	3"
Pumps With Pedestal Mount						
S-3220-P	2" Straight, 3/4" Shaft	197	39	3500	5	2"
S-3320-P	3" Straight, 1 1/8" Shaft	365	60	3500	10	3"
S-3325-P	3" Straight Truck Pump, 1 1/8" Shaft	463	99	4500	16.5	3"
SP-3220-P	2" Self-Priming, 3/4" Shaft	152	42	3500	5	2"
SP-3320-P	3" Self-Priming, 1 1/8" Shaft	308	65	3500	10	3"
SP-3325-P	3" Self-Priming Truck Pump 1 1/8" Shaft	308	65	3500	10	3"
Pumps Coupled To Hydraulic Motors (includes hydraulic motor)						
S-3220-PH	2" Straight Hydraulic Drive	197	39	3500	10	2"
S-3325-PH	3" Straight Truck Pump Hydraulic Drive	365	60	3500	10	3"
SP-3220-PH	2" Self-Priming Hydraulic Drive	152	42	3500	5	2"
SP-3325-PH	3" Self-Priming Truck Pump Hydraulic Drive	308	65	3500	10	3"

- **NEW** Low flow hydraulic motors are available on Hydraulic Truck Pumps Straight 3" (S-3325-PHL) and Self-priming 3" Hydraulic Truck Pump (SP-3325-PHL).
- Standard motors require 25 GPM for full pump flow and low flow motors require 14 GPM.

NEW Miscellaneous
Flanges available on all centrifugal pumps: Add -FLG after model part number.
Flange Adapters Ductile Iron, 2", NPT to 220 Series: 116001-01
Flange Adapters Ductile Iron, 3" NPT to 300 Series: 116002-01

* Pump size given in inches refers to inlet and outlet sizes.
** Power based on electric motor with full voltage and pumping water.

Compact, Durable Small Range Pump Units

Reaching New Heights in Quality and Performance

Install a CDS-John Blue Irrigation Pump and you install a pump backed by more than 125 years of manufacturing expertise. CDS-John Blue Company offers the most advanced technology for accurately metering fertilizers and chemicals through irrigation systems - drip, pivot, turf and nursery applications. All CDS-John Blue Irrigation Pumps are designed for accuracy, built for durability and proven in the field.

Our broad range of injection pumps are available in both simplex and duplex models. All wetted internal parts exposed to agricultural products are made from 316 stainless steel, chemically resistant polypropylene and the highest quality seals available today.

When irrigation injection of fertilizers and chemicals demands an accurate injection rate, maximum dependability and long-term reliability, then choose the CDS-John Blue Irrigation Injection Pumps that have been engineered with you in mind.

Pumping cylinders can be mounted in parallel for large volume applications or for injection of two non-compatible products.

A simple change of stroke length sets the precise flow to be injected.



Maximum pressure 150 psi.



E-Z Meter Pumps with the double ball, built-in check valves provide better performance by virtually eliminating air locking. Available in 316 stainless steel or Teflon® cylinders.



The latest state of the art technology is used in the CDS-John Blue piston cup seals. The upgraded seals are more forgiving when the pump is run dry between supply tank refills. The special CDS-John Blue piston cup shape provides a positive seal without the need for future adjustments. Piston cups can be changed in the field with standard tools.

Reaching New Heights in Quality and Performance!

Pump models have a range of application from 1.6 to 114 GPH or all the way up to 6 to 470 GPH.

All wetted parts are constructed with corrosion resistant stainless steel to ensure optimum performance over many years of service.

All working parts are totally enclosed for maintenance free service.

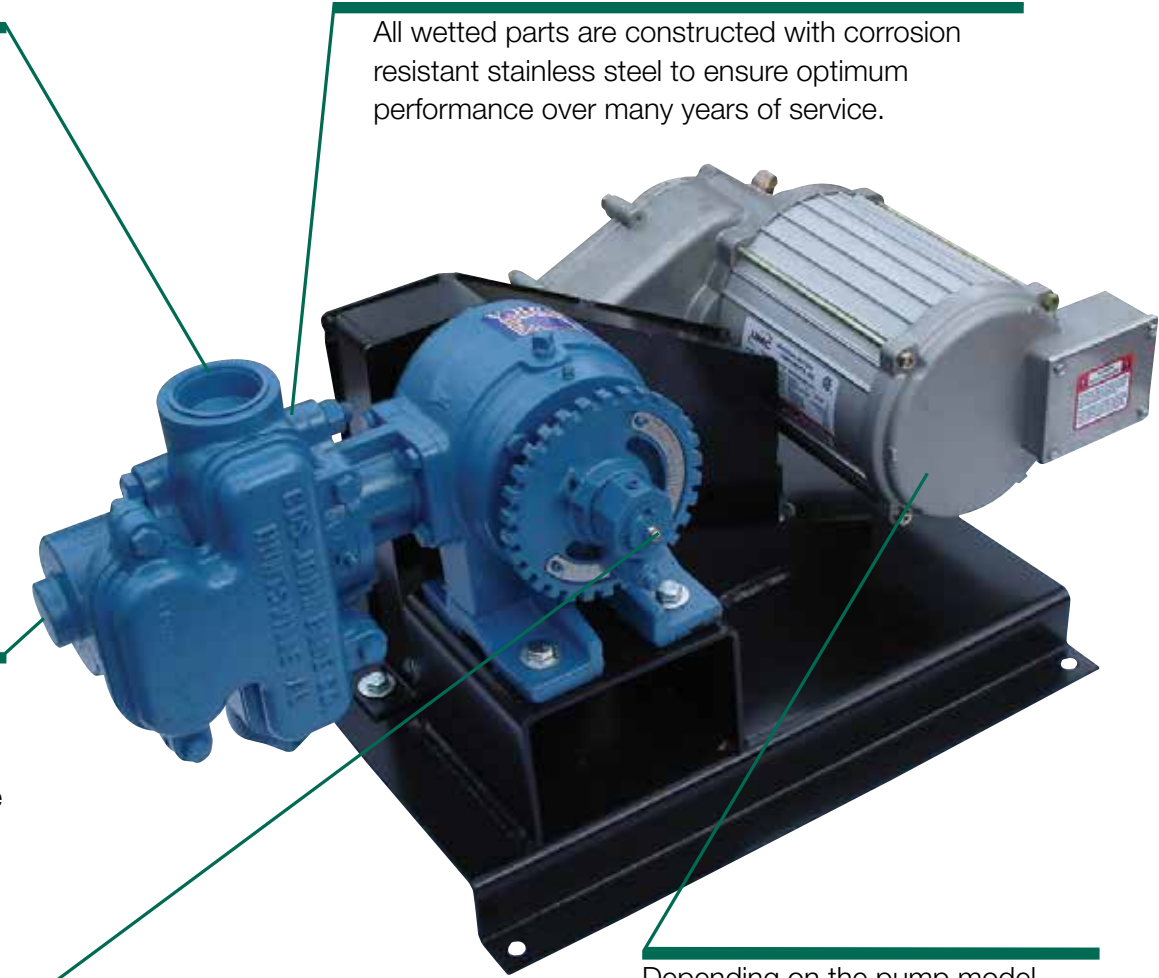

Rates are easily adjusted with the dial pointer located on the side of the pump, which changes the length of the stroke.

Depending on the pump model, units are available with ¾ or 1 ½ HP motor and gearbox.



115026-HS



CV-1310

NEW Injection Check Valve

- 200 gph maximum capacity continuous flow (duplex).
- 100 gph maximum capacity (simplex).
- More uniform distribution of products.
- Prevents backflow, siphoning and bleed through of product.
- Easy to install and maintain.
- All Viton seals.
- 316 stainless steel spring, ball and injection tube.
- 10 psi spring.
- Bodies available in either polypropylene (CV-1310) or 316 stainless steel (115026-HS).

E-Z Meter Pumps*

Maximum Pressure 150 PSI

316 Stainless Steel Cylinder Models



02633

Power Source	5-30 GPH	10-100 GPH	5-30 5-30 GPH	5-30 10-100 GPH	10-100 10-100 GPH
110-220 1ph	10620	11630	10622	10623	10633
220-440 3ph	20620	21630	20622	20623	20633
Belt Drive	01620	01630	01622	01623	01633
Honda Engine	02620	02630	02622	02623	02633
12V DC Motors	30620	30630	30622	30623	30633

*-1 after the part number indicates pumps with Teflon cylinders, ideal for acid applications. For stainless steel check valves contact the factory.

CDS-John Blue Full Range Fertilizer Injection Units



IN-23530-NGP

Model Number	Phase	Model Type	Low Range GPH	High Range GPH	Max PSI	Motor Size	GPH Range
IN-11610	Single	Simplex Duplex	2.6-26.2 5.2-52.4	5.9-59 11.7-117.4	120 120	1 1/2 1 1/2	2.6-117
IN-11630	Three	Simplex Duplex	1.6-15.5 3.1-31	5.7-57 11.4-114	120 120	3/4 3/4	1.6-114
IN-23510-NGP	Single	Simplex Duplex	5.5-55 11-108	12-122 24-242	120 120	1 1/2 1 1/2	5.5-242
IN-23530-NGP	Three	Simplex Duplex	3-32 6-64	12-119 24-235	120 120	3/4 3/4	3-235
IN-47010-NGP	Single	Simplex Duplex	8.2-81.9 16.2-162	18.4-183.8 36.3-363	120 120	1 1/2 1 1/2	8.2-363
IN-47030-NGP	Three	Simplex Duplex	6-64.8 12-128	24-238 48-470.2	120 120	1 1/2 1 1/2	6-470

E-Z Meter Field Conversion Parts and Options

Model Number	Description
50520	Duplex Field Conversion 5-30 GPH E-Z Meter Pump
50530	Duplex Field Conversion 10-100 GPH E-Z Meter Pump
115026-HS	1/4" FNPT inlet x 1/4" MNPT outlet (with tube) 316 SS Backflow Check Valve for Irrigation Line
115030	1/4" MNPT inlet x 1/4" FNPT outlet Backflow Check Valve for Irrigation Line
NEW CV-1310	1/4" FNPT inlet x 1/2" MNPT outlet (with tube) Poly Check Valve for Irrigation Line

*Pumps produced prior to 2005 can only be duplexed if originally supplied with a dual output shaft gearbox used on 10-100 units, gasoline or belt drive pumps.

E-Z Meter Power Sources:

5-30, 10-100 and 10-200 GPH Pumps

115/208-230V Single Phase, 60 HZ.

1/2 HP, 1725 RPM, 115/208-220V, FLA 8.8/4.4, 56C Frame, HZ 60 single phase, SFA 9.4/4.7, service factor, 1.15 ball bearings. (50 HZ motors available upon request).

208-230/440V Three Phase, 60 HZ.

1/2 HP, 1725 RPM, 208-230/440V, FLA is 2.1-2.0/1.0, 56C Frame, HZ 60, three phase, SFA 2.5-2.4/1.2, service factor, 1.25 ball bearings. (50 HZ motors available upon request).

Honda Gasoline Engine Driven (GED)

4 cycle, 7.2 CID with 4 HP at 3600 RPM, fuel capacity .66 US gallons.

12 Volt

1/2 HP, 1800 full load RPM, 12 Volts DC F.L. AMPS 40, 24 Volts DC 20 F.L. AMPS, Class F insulation, linear speed/torque, NEMA 56C frame, ball bearings. Manufacturer reserves the right to make changes to specifications.

All CDS-John Blue Irrigation Pumps
are backed by our Unconditional Guarantee:
“Guaranteed to Do the Job”

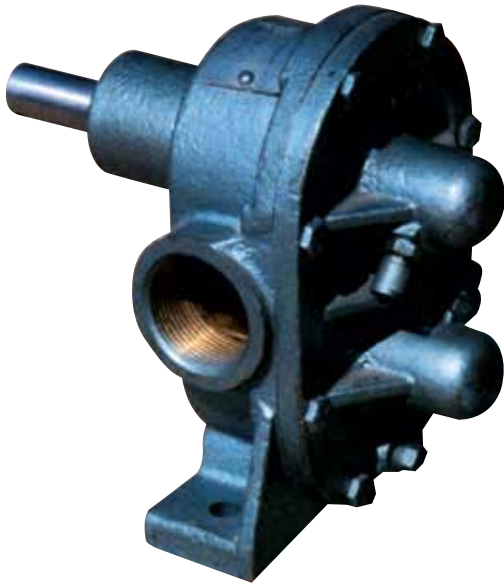

This positive displacement brass gear pump with the shear pin design and stainless steel shaft is ideal for sprayer applications. The CDS-John Blue Brass Gear Pump maintains even pressure and is designed to be run at 540-600 RPM.

Brass Gear Pump - Model 113778	
Shear Pin Design	Inlet - 1 1/4"
Solid Brass Pump Case	Outlet - 1 1/4"
Solid Brass Cover Plate	Maximum Pressure - 250 PSI
Maximum Capacity - 18 GPM	Maximum Speed - 600 RPM

Model Available:

113778 Brass Gear Pump



CDS-John Blue Company
Built on a Tradition of Quality

CDS-John Blue Low Pressure Poly Pump Series

CDS-John Blue Low Pressure Poly Pumps are an excellent choice for all spraying applications, including agriculture, horticulture, lawn care, nursery, car wash, air blast orchard/vineyard and poultry house sprayers. These Diaphragm Pumps are highlighted by the Poly Millennium Series. Three, four, five and six piston semi-hydraulic Diaphragm Pumps assure a smooth and quiet operation even with high volume flow. So when you want a Diaphragm Pump that will handle acid and highly corrosive products, the only company capable of handling your special needs is CDS-John Blue Company with the Poly Millennium Series.

Benefits of the CDS-John Blue Low Pressure Poly Pumps

- All fluid end components are polypropylene and 316 stainless steel, offering amazing reliability and service for even the most aggressive chemicals.
- CDS-John Blue self-lubricating cast iron piston sleeves provide a unique “oil-thrust-pad” design.
- Bronze connecting rods and diaphragms constructed from resistant elastomers provide economical and trouble free service.
- The heads are designed with a new patented technology that includes an aluminum die-cast core inside a polypropylene structure offering superior strength.
- Pre-deformed diaphragms in a specially formulated chemical resistant material, 316 stainless steel washer and diaphragm bolt offer strength and resistance to chemical attack.
- Pre-deformed diaphragm allows for reduced deflection and longer life.
- Reduced piston stroke decreases diaphragm deflection providing long life operation.
- Other benefits of Poly Pumps include low maintenance costs and interchangeability of heads, diaphragms and associated components across most of the Poly Pump line.
- Convenient visual oil-level indicator.
- Pumps can be run dry.
- Individual suction and pressure manifolds for smoother flow through the pump.

“We can sell a poly pump in any application. It doesn’t require my salespeople to have knowledge of the products going through the pump – the pump will work”

Mark Kennedy, Partner and Vice President of Green Rubber - Kennedy Ag, LP, Salinas, CA.

Patented Technology

Exclusive technology:

- Pumps come standard with internal pressure dampener.
- Standard, interchangeable parts for reduced inventory and best service.
- Full range: 2,3,4,5,6 diaphragms available.

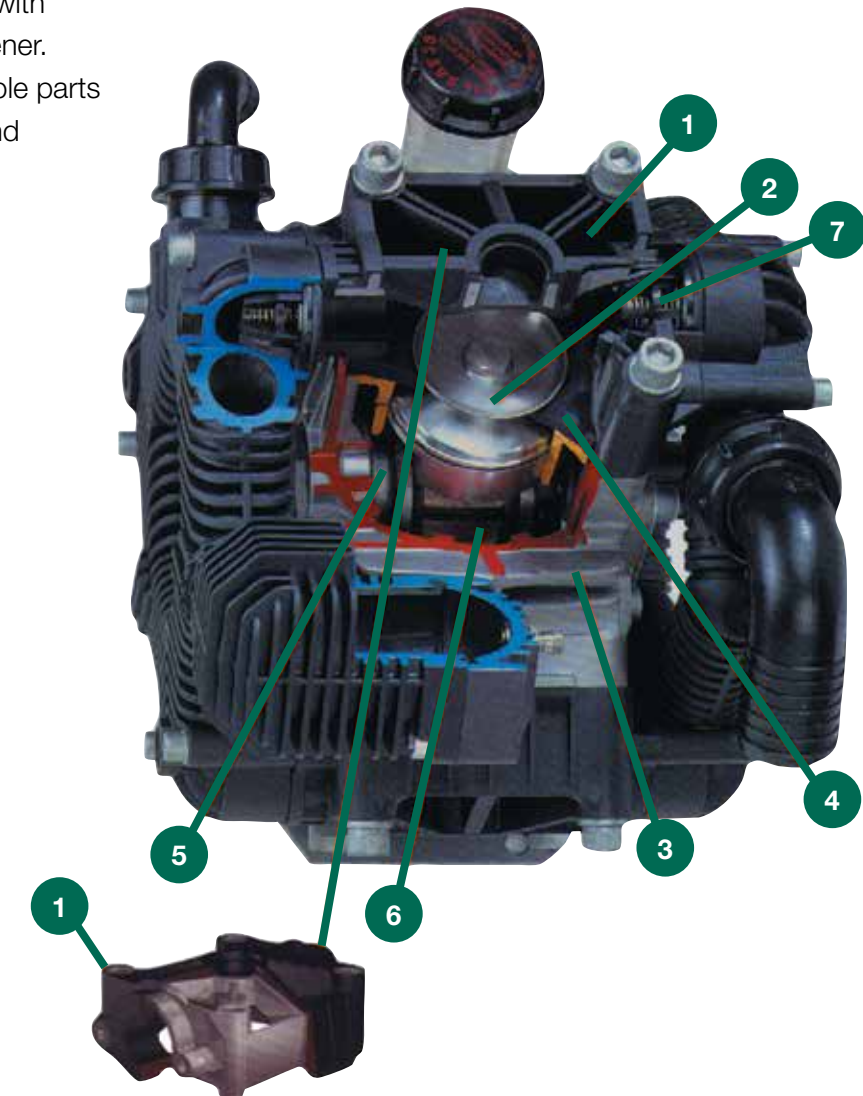

- 1 The heads are designed with a patented technology that includes an aluminum die-cast core inside a polypropylene structure offering superior strength.
- 2 Washers and diaphragm bolts in 316 stainless steel, an exclusive feature.
- 3 Die cast crankcase incorporating a new cooling system.
- 4 New chemically resistant diaphragm material pre-deformed to reduce the amount of deflection, increasing diaphragm life. The diaphragm material is compatible with most of the corrosive chemicals on the market today.
- 5 A short crankshaft stroke means the longest life possible.
- 6 New connecting rods in special bronze alloy offer economical and trouble free service.
- 7 316 stainless steel and polypropylene inlet and outlet check valves.

CDS-John Blue Poly Pumps

DP-193-PP

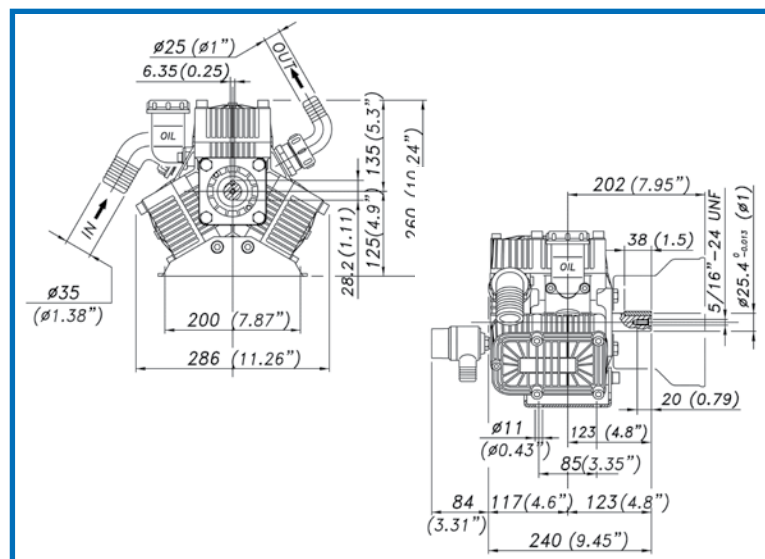

DP-193-PP

- Maximum Flow: 19.8 gpm
- Maximum Pressure: 218 psi
- Maximum Speed: 550 rpm
- Maximum Power: 2.8 hp
- Weight: 24.2 lbs.
- Diaphragms: 3
- Negative Pressure – Max: 4.9 ft.
Intermittent: 9.8 ft.

- Suction Hose Diameter: 1 1/2" Hose
- Discharge Hose Diameter: 1" NPT
- Max Temperature: 140°F
- Lubricating Oil Type: 30 SAE
- Drive Shaft: 1" diameter (one side only)

Recommended Accessories:

- Control Units: SC-2420-3, SC-2660-3
- Gearbox for 5 HP gasoline engine with 3/4" shaft: DP-318874
- Hydraulic Adapter (SAE "B") : DP-31874997

DP-193-PP Performance								
Pressure	RPM							
	400		450		500		550	
	gpm	hp	gpm	hp	gpm	hp	gpm	hp
29	14.4	0.3	16.2	0.3	18.0	0.4	19.8	0.4
73	14.2	2.7	16.0	0.8	17.8	0.9	19.6	1.0
145	13.8	1.4	15.6	1.5	17.3	1.7	19.0	1.9
218	13.5	2.0	15.1	2.3	16.8	2.5	18.5	2.8

DP-282-P

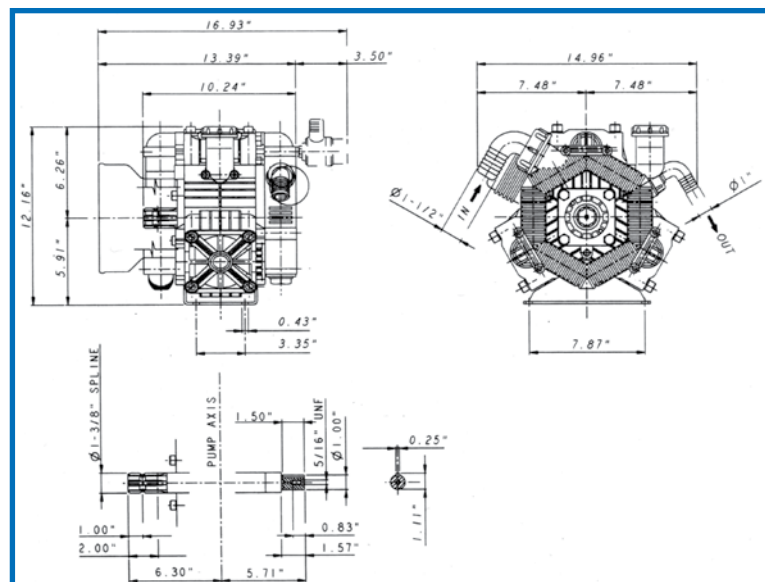

DP-282-P

- Maximum Flow: 28.2 gpm
- Maximum Pressure: 218 psi
- Maximum Speed: 550 rpm
- Maximum Power: 4.1 hp
- Weight: 41.8 lbs.
- Diaphragms: 3
- Negative Pressure – Max: 4.9 ft.
Intermittent: 9.8 ft.

- Suction Hose Diameter: 1 1/2" Hose
- Discharge Hose Diameter: 1" NPT
- Max Temperature: 140°F
- Lubricating Oil Type: 30 SAE
- Through input shaft: 1" diameter one end, 1 3/8" 6-spline opposite end.

Recommended Accessories:

- Control Units: SC-2420-3, SC-2660-3
- Gearbox for 5 HP gasoline engine with 3/4" shaft: DP-318874 must use DP-31155907 spacer and (4) bolts DP-86357500.
- Hydraulic Adapter (SAE "B"): DP-31874997 must use (1) DP-31155907 spacer and (4) bolts DP-86357500.

DP-282-P Performance								
Pressure	RPM							
	400		450		500		550	
	gpm	hp	gpm	hp	gpm	hp	gpm	hp
29	20.6	0.4	23.1	0.5	25.7	0.5	28.3	0.6
73	20.4	1.0	22.9	1.1	25.5	1.3	28.0	1.4
145	20.2	2.0	22.5	2.3	25.2	2.5	27.7	2.8
218	20.0	3.0	15.1	3.3	25.0	3.7	27.5	4.1

DP-332-P

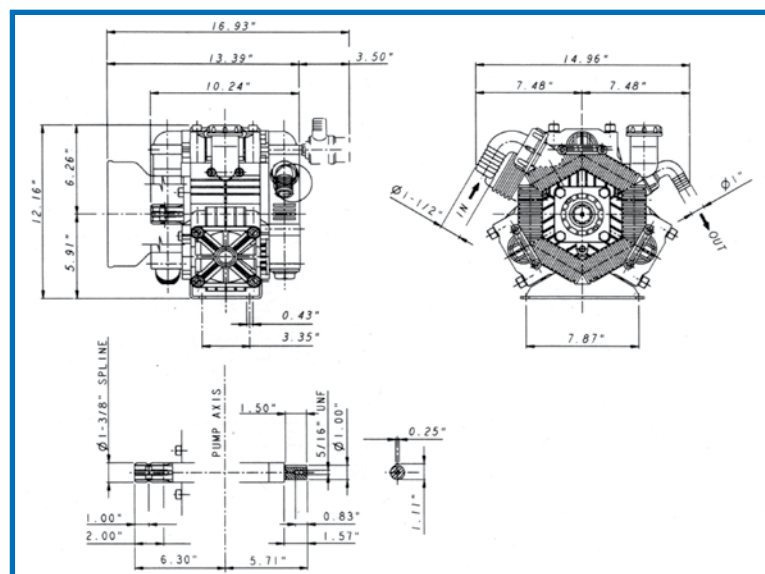

DP-332-P

- Maximum Flow: 33.3 gpm
- Maximum Pressure: 218 psi
- Maximum Speed: 550 rpm
- Maximum Power: 4.8 hp
- Weight: 41.8 lbs.
- Diaphragms: 3
- Negative Pressure – Max: 4.9 ft.
Intermittent: 9.8 ft.

- Suction Hose Diameter: 1 1/2" Hose
- Discharge Hose Diameter: 1" NPT
- Max Temperature: 140°F
- Lubricating Oil Type: 30 SAE
- Through input shaft: 1" diameter one end, 1 3/8" 6-spline opposite end.

Recommended Accessories:

- Control Units: SC-2420-3, SC-2660-3
- Gearbox for 5 HP gasoline engine with 3/4" shaft: DP-318874 and requires the DP-31155907 spacer and (4) DP-86357500 bolts.
- Hydraulic Adapter (SAE "B"): DP-31874997 must use (1) DP-31155907 spacer and (4) bolts DP-86357500.

DP-332-P Performance								
Pressure	RPM							
	400		450		500		550	
	gpm	hp	gpm	hp	gpm	hp	gpm	hp
29	24.2	0.5	27.2	0.5	30.3	0.6	33.3	0.7
73	24.0	1.2	27.0	1.3	30.0	1.5	33.0	1.6
145	23.8	2.4	26.8	2.7	29.8	3.0	32.8	3.3
218	23.4	3.5	26.4	3.9	29.3	4.4	32.2	4.8

DP-448-P

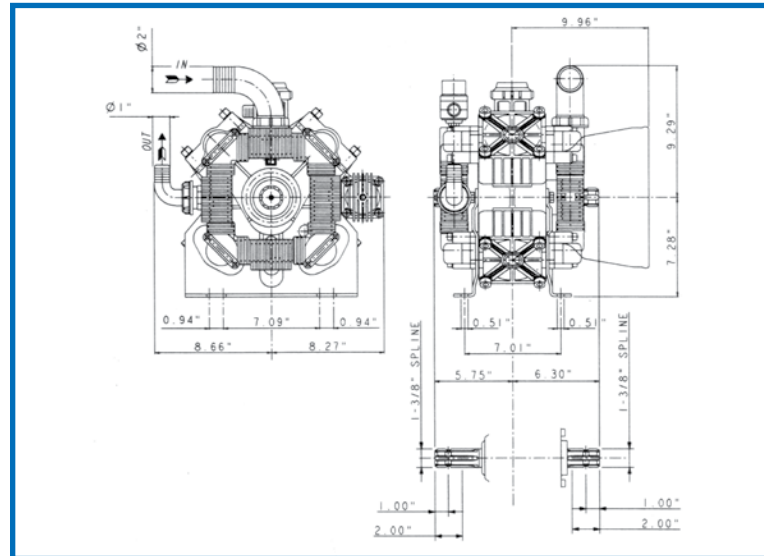

DP-555-P

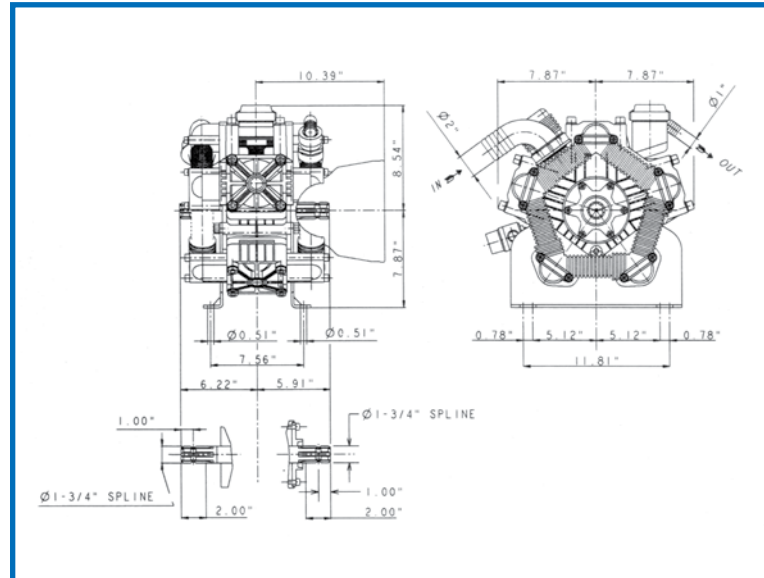

DP-605.2-P

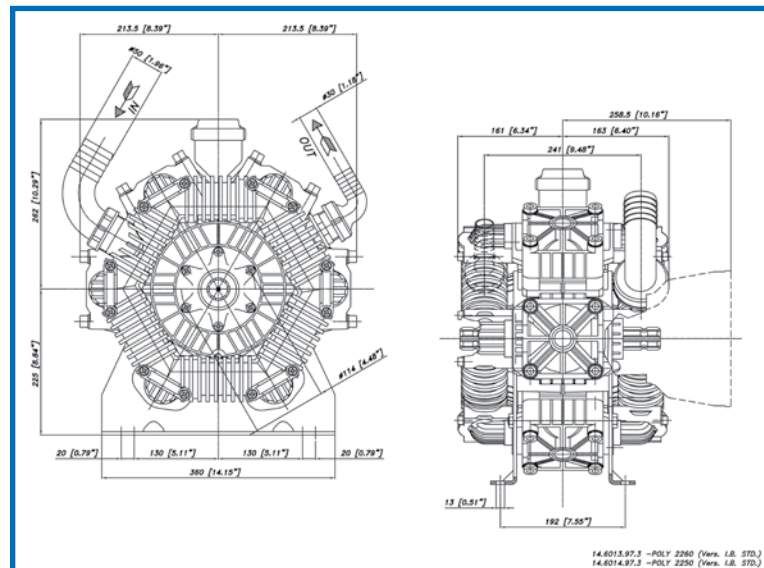

DP-448-P

- Maximum Flow: 44.9 gpm
- Maximum Pressure: 218 psi
- Maximum Speed: 550 rpm
- Maximum Power: 6.5 hp
- Weight: 57.2 lbs.
- Diaphragms: 4
- Negative Pressure – Max: 4.9 ft. Intermittent: 9.8 ft.
- Suction Hose Diameter: 2" Hose
- Discharge Hose Diameter: 1" NPT
- Max Temperature: 140°F
- Lubricating Oil Type: 30 SAE
- Through shaft: 1 3/8" 6-spline both ends

Recommended control unit:

- SC-2660-3

DP-448-P Performance

Pressure	RPM							
	400		450		500		550	
	gpm	hp	gpm	hp	gpm	hp	gpm	hp
29	32.7	0.6	36.7	0.7	40.8	0.8	44.9	0.9
73	32.5	1.6	36.5	1.8	40.6	2.0	44.6	2.2
145	32.1	3.2	36.1	3.6	40.1	4.0	44.1	4.4
218	31.7	4.7	35.7	5.3	39.6	5.9	43.6	6.5

DP-555-P

- Maximum Flow: 55.5 gpm
- Maximum Pressure: 218 psi
- Maximum Speed: 550 rpm
- Maximum Power: 8.0 hp
- Weight: 72.6 lbs.
- Diaphragms: 5
- Negative Pressure – Max: 4.9 ft. Intermittent: 9.8 ft.
- Suction Hose Diameter: 2" Hose
- Discharge Hose Diameter: 1" NPT
- Max Temperature: 140°F
- Lubricating Oil Type: 30 SAE
- Through shaft 1 3/8" 6-spline opposite end

Recommended control unit:

- SC-2660-3

DP-555-P Performance

Pressure	RPM							
	400		450		500		550	
	gpm	hp	gpm	hp	gpm	hp	gpm	hp
29	40.4	0.8	45.4	0.9	50.4	1.0	55.5	1.1
73	40.0	2.0	45.0	2.2	50.0	2.5	55.0	2.7
145	39.6	3.9	44.5	4.4	49.5	4.9	54.4	5.4
218	39.2	5.8	44.1	6.6	49.0	7.3	53.9	8.0

DP-605.2-P

- Maximum Flow: 67.1 gpm
- Maximum Pressure: 218 psi
- Maximum Speed: 550 rpm
- Maximum Power: 9.4 hp
- Weight: 85.8 lbs.
- Diaphragms: 6
- Negative Pressure – Max: 4.9 ft. Intermittent: 9.8 ft.
- Suction Hose Diameter: 2" Hose
- Discharge Hose Diameter: 1 1/4" NPT
- Max Temperature: 140°F
- Lubricating Oil Type: 30 SAE
- Through shaft 1 3/8" 6-spline opposite end

Recommended control unit:

- SC-2660-3

DP-605.2-P Performance

Pressure	RPM							
	400		450		500		550	
	gpm	hp	gpm	hp	gpm	hp	gpm	hp
29	51.6	1.0	56.8	1.1	61.9	1.2	67.1	1.3
73	50.8	2.5	55.9	2.8	61.0	3.0	66.1	3.3
145	49.8	4.9	54.8	5.4	59.8	5.9	64.7	6.4
218	48.8	7.3	53.7	8.0	58.5	8.7	63.4	9.4

Advantages of the CDS-John Blue Low Pressure Poly Diaphragm Pumps

- Low Pressure Diaphragm Pumps operate to 4.3 gpm with pressure ratings to 290 psi.
- Cast iron piston sleeves for longer wear.
- Convenient visual oil-level indicator.
- Oil drain in crankcase.

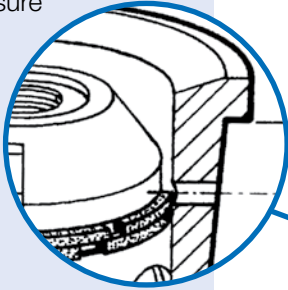

CDS-John Blue Low Pressure Poly Diaphragm Pumps



External Poly Manifolds

¼ turn check valve removal for inspection.

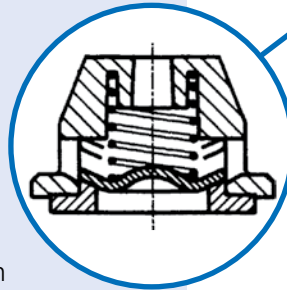

- Stainless steel check valve design ensures perfect sealing performance due to its unique spherical shaped poppet and conical seat.
- Three bearings on the crankshaft.
- Pumps can be run dry.

Mini Poly Pumps have total chemical resistance to harsh chemicals and fertilizers.

DP-43-P

- Maximum Flow: 4.3 gpm @ 550 rpm and 290 psi.
- Maximum Pressure: 290 psi
- Maximum Speed: 650 rpm
- Maximum Power: 1.0 hp @ 550 RPM and 290 psi.
- Weight: 12.32 lbs.
- Diaphragms: 2
- Suction Hose Diameter: 3/4" Hose
- Discharge Hose Diameter: 1/2" NPT
- Max Temperature: 140°F
- Lubricating Oil Type: 30 SAE
- Can be PTO, gasoline engine or electric motor driven

Recommended Accessories:

- Pressure Regulator: SC-1066-2.
- Gearbox for 3.5 and 5 HP engines: DP-318697.
- Pump equipped with crankshaft flange, must order shaft separately: DP-318793 (¾") solid shaft or DP-318590 (1") solid shaft.

Optional Accessories:

- DP-310088 Female 1 3/8" shaft kit
- DP-310049 Male 1 3/8" shaft kit
- DP-31874897 Hydraulic adaptor kit SAE "B"

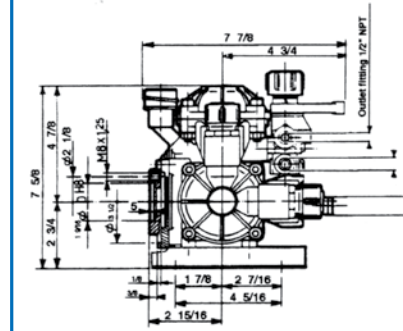

DP-43-P

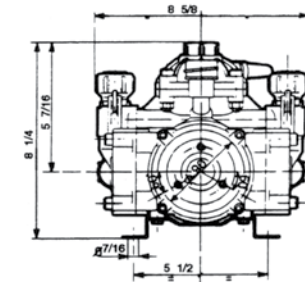

DP-43-GRIP
DP-43-GRIP2.2

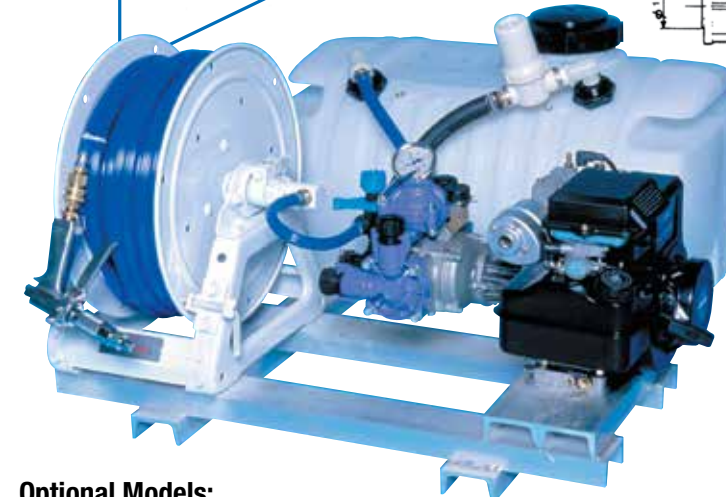
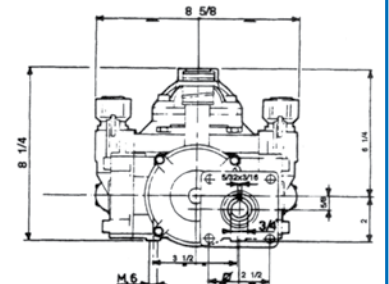
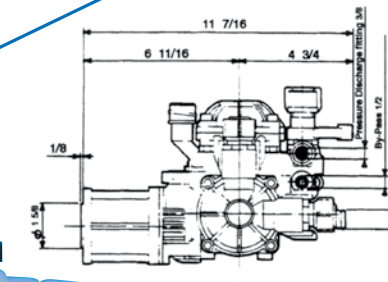

“ We like the DP-43 because it is lightweight, easy to maintain and capable of high enough pressures for spraying hard to reach places ”

Ellis Jones, Equipment Manager, Oldham Chemicals Company, Inc., Memphis, TN

Optional Models:

- DP- 43-GRIP Poly Pump includes gearbox for 3.5 and 5 HP engines and regulator with (2) outlets and shut-off valve.
- DP-43-GRIP-2.2 Poly Pump includes gearbox for 2.2 HP Honda engine with (2) outlets and shut-off valve.
- DP-43-P New DP-43-P Mini Poly Pump - total chemical resistance to harsh chemicals and fertilizers. Has ¾" solid shaft.
- DP-43-GRP New DP-43-GRP Mini Poly Pump includes gearbox for 3.5 and 5 HP engines, has a ¾" solid shaft and does not include a regulator. Poly Pump guarantees total chemical resistance to harsh chemicals and fertilizers.

DP-43 Performance								
Pressure	RPM							
	500		550		600		650	
	gpm	hp	gpm	hp	gpm	hp	gpm	hp
29	4.38	.09	4.8	0.10	5.28	1.1	5.73	0.13
145	4.0	.48	4.38	0.52	4.78	0.57	5.1	0.60
218	3.96	.71	4.3	0.78	4.73	0.85	5.07	0.90
290	3.93	.94	4.3	1.0	4.7	1.13	5.0	1.2

Miscellaneous kits are available on page 61.

All Available in Poly

Medium Pressure Diaphragm Pumps



Features of CDS-John Blue Medium Pressure Pumps

- Medium Pressure Diaphragm Pumps perform from 7.4 to 18.5 gpm with pressure ratings from 0 to 580 psi.
- Each piston has two piston rings for improved piston seal to keep a film of oil between the piston and diaphragm.
- Exclusive stainless steel check valve design (right drawing) ensures perfect sealing performance due to its unique spherical shaped poppet and conical seat.
- The pump's design delivers high volumetric efficiencies and more pumping capacity.
- Three-piston semi-hydraulic diaphragm pumps ensure a smoother, quieter operation.
- Convenient visual oil-level indicator.
- Pumps can be run dry.

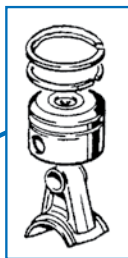

Benefits:

- Ball bearings on the crankshaft for increased life.
- Features a uniquely shaped piston to reduce wear against the diaphragm.

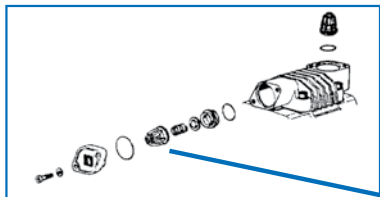

“The CDS-John Blue Diaphragm Pumps run smoother and are much more heavily built than previous pumps. We have used CDS-John Blue Pumps for years and have found the quality of the pumps to be superior.”

**Mickey O'Neill, Vice President Sales and Marketing of
Wylie Manufacturing, Petersburg, TX**



DP-74.1

- Maximum Flow: 7.4 gpm
- Maximum Pressure: 580 psi
- Maximum Speed: 550 rpm
- Maximum Power: 2.5 hp
- Weight: 16 lbs.
- Diaphragms: 3
- Suction Hose Diameter: 1" Hose
- Discharge Hose Diameter: 1/2" NPT
- Max Temperature: 140°F
- Lubricating Oil Type: 30 SAE
- Can be PTO mounted, gasoline engine, hydraulic motor or electric motor driven

DP-74.1 Performance

Pressure	RPM							
	500		550		600		650	
	gpm	hp	gpm	hp	gpm	hp	gpm	hp
29	6.70	0.14	7.40	0.16	8.00	0.17	8.70	0.18
145	6.50	0.70	7.10	0.77	7.66	0.80	8.20	0.88
290	6.30	1.37	7.00	1.5	7.50	1.60	8.10	1.75
580	6.20	2.0	6.90	2.2	7.40	2.4	7.90	2.5

Recommended Accessories:

- Pressure regulator: SC-1132-2 or SC-1240-3.
- Gearbox for 3.5 and 5 HP engines: DP-318697.
- Pump equipped with crankshaft flange, must order shaft separately: DP-318793 (3/4") solid shaft or DP-318590 (1") solid shaft.

Optional Models:

DP-74.1-GRI

Includes gearbox for 3.5 and 5 HP engines and regulator with (2) outlets and shut-off valve.

Optional Accessories:

DP-318343
DP-310049
DP-31874897

Female 1 3/8" shaft kit
Male 1 3/8" shaft kit
Hydraulic adaptor kit SAE "B"

DP-74.1

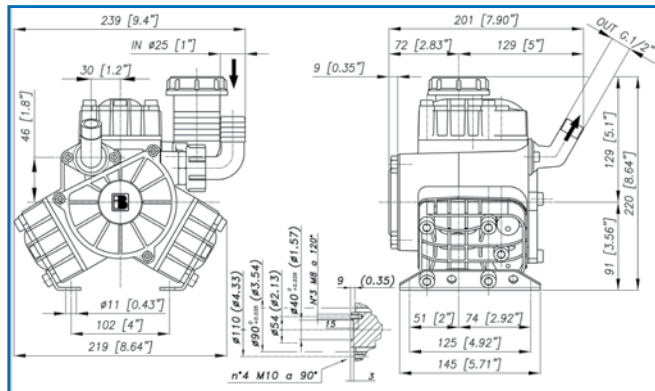

DP-90.1

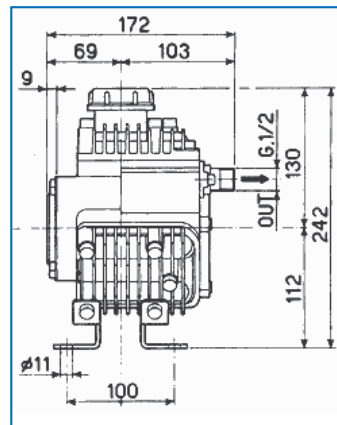

DP-90.1

- Maximum Flow: 9 gpm @ 550 RPM, 10.6 gpm @ 650 rpm
- Maximum Pressure: 580 psi
- Maximum Speed: 650 rpm
- Maximum Power: 4.0 hp
- Weight: 17 lbs.
- Diaphragms: 3
- Suction Hose Diameter: 1" Hose
- Discharge Hose Diameter: 1/2" NPT
- Max Temperature: 140°F
- Lubricating Oil Type: 30 SAE
- Can be PTO mounted, gasoline engine, hydraulic motor or electric motor driven.

DP-90.1 Performance

Pressure	RPM							
	500		550		600		650	
	gpm	hp	gpm	hp	gpm	hp	gpm	hp
29	8.2	0.12	9.0	0.14	9.8	0.15	10.6	0.15
290	7.7	1.2	8.5	1.3	9.2	1.4	9.8	1.5
435	7.5	1.7	8.3	1.9	9.1	2.1	9.6	2.2
580	7.4	2.4	8.2	2.5	9.0	2.8	9.5	2.9

Recommended Accessories:

- Pressure regulator: SC-1132-2 or SC-1240-3.
- Gearbox for 3.5 and 5 HP engines: DP-318697.
- Pump equipped with crankshaft flange, must order shaft separately: DP-318793 (3/4") solid shaft or DP-318590 (1") solid shaft.

Optional Models:

DP-90.1-GRI

Includes gearbox for 3.5 and 5 HP engine and regulator with (2) outlets and shut-off valve.

Optional Accessories:

DP-318343
DP-310049
DP-31874897

Female 1 3/8" shaft kit
Male 1 3/8" shaft kit
Hydraulic adaptor kit SAE "B"

CDS-John Blue Medium Pressure Pumps

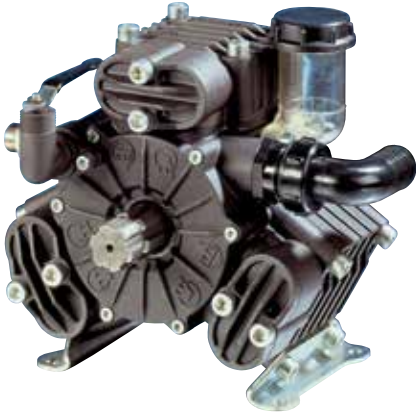

- DP-139**
 - Maximum Flow: 13.9 gpm @ 550 and 145 psi
 - Maximum Pressure: 580 psi
 - Maximum Speed: 550 rpm
 - Maximum Power: 5.6 hp
 - Weight: 30.8 lbs.

- Diaphragms: 3
 - Suction Hose Diameter: 1 1/4" Hose
 - Discharge Hose Diameter: 1/2" NPT
 - Max Temperature: 140°F
 - Lubricating Oil Type: 30 SAE

DP-139 Performance								
RPM								
Pressure	400		450		500		550	
	gpm	hp	gpm	hp	gpm	hp	gpm	hp
145	10.04	1.05	11.30	1.19	12.55	1.32	13.90	1.46
290	10.04	2.11	11.30	2.38	12.55	2.64	13.70	2.89
435	9.93	3.13	11.17	3.53	12.40	3.92	13.60	4.30
580	9.80	4.13	11.04	4.64	12.28	5.17	13.50	5.60

Recommended Accessories:

- Pressure regulator: SC-1132-2 or SC-1240-3.
- Gearbox for 3.5 and 5 HP engines: DP-318697 and DP-318724 for 8 and 11 HP engines.
- Pump has crankshaft flange on one side, 1 3/8" spline shaft opposite side, must order solid shaft separately: DP-318793 (3/4") solid shaft or DP-318590 (1") solid shaft.

Optional Accessories:

DP-31874897 Hydraulic adaptor kit SAE "B"

DP-139

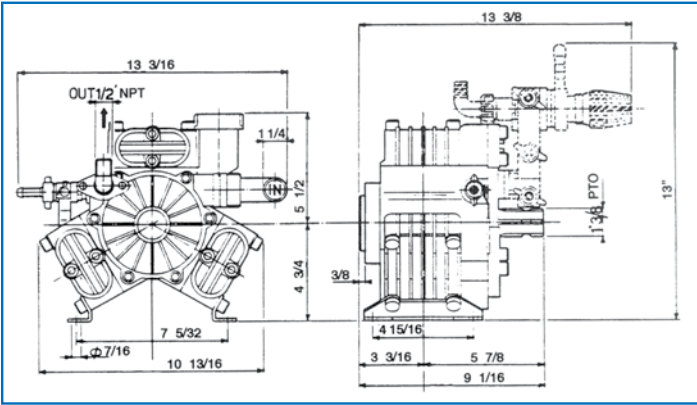

- DP-185.1**
 - Maximum Flow: 18.5 gpm @ 145 psi
 - Maximum Pressure: 580 psi
 - Maximum Speed: 550 rpm
 - Maximum Power: 7.4 hp
 - Weight: 33 lbs.

- Diaphragms: 3
 - Suction Hose Diameter: 1 1/4" Hose
 - Discharge Hose Diameter: 3/4" NPT
 - Max Temperature: 140°F
 - Lubricating Oil Type: 30 SAE

DP-185.1 Performance								
RPM								
Pressure	400		450		500		550	
	gpm	hp	gpm	hp	gpm	hp	gpm	hp
145	13.79	1.4	15.30	1.6	16.90	1.7	18.50	1.9
290	13.47	2.8	15.00	3.16	16.60	3.5	18.20	3.8
435	13.20	4.1	14.80	4.6	16.40	5.1	17.90	5.6
580	12.90	5.4	14.50	6.1	16.10	6.7	17.70	7.4

DP-185.1

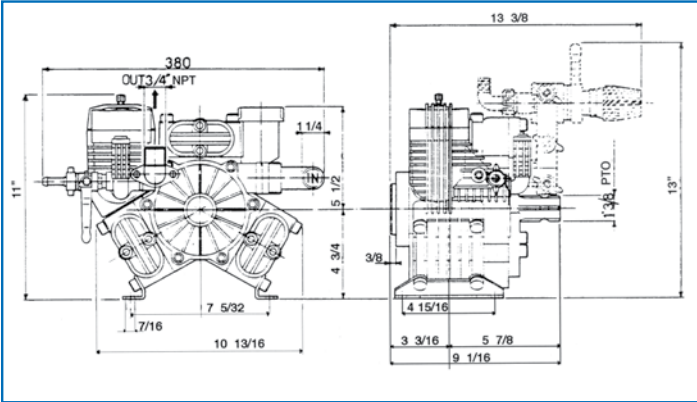

Recommended Accessories:

- Pressure regulator: SC-1240-3.
- Gearbox DP-318724 for 8 and 11 HP engines.
- Pump has crankshaft flange on one side, 1 3/8" spline shaft opposite side, must order solid shaft separately: DP-318793 (3/4") solid shaft or DP-318590 (1") solid shaft.

Optional Accessories:

DP-31874897 Hydraulic adaptor kit SAE "B"

CDS-John Blue High Pressure Pumps

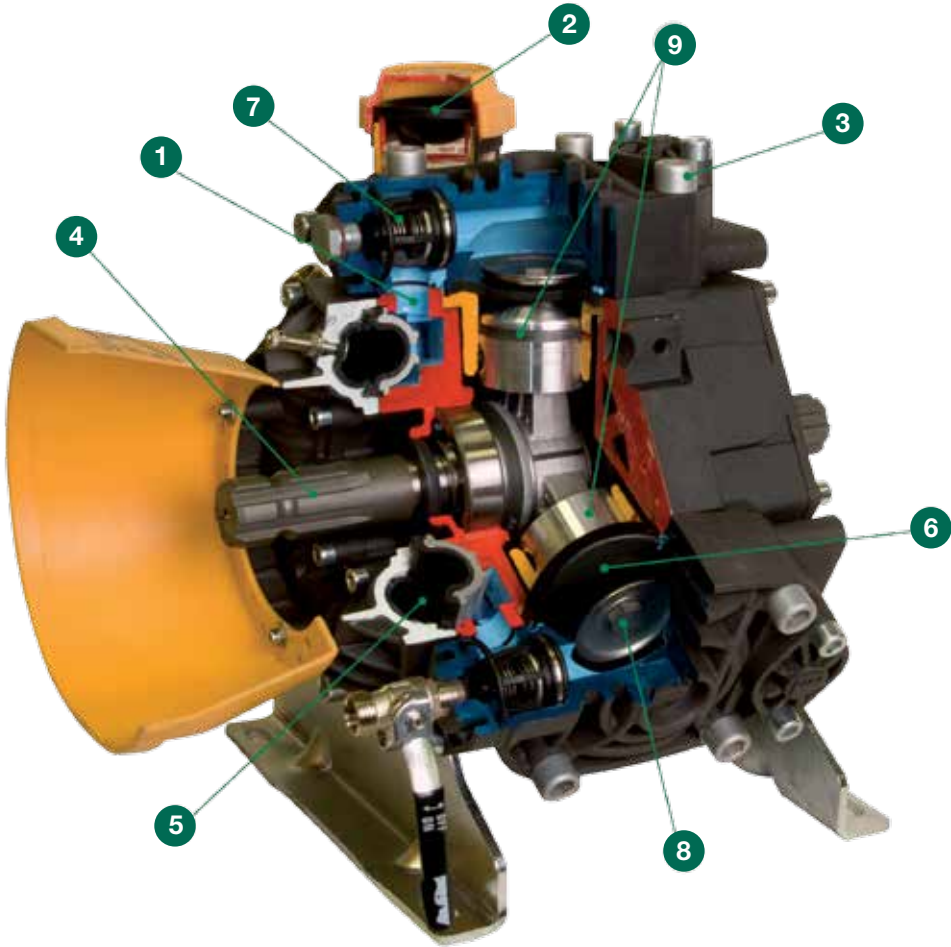

- 1
Oversized and separate suction and pressure circuits that create a smooth flow of the liquid without any pressure loss.

2
Convenient visual oil-level sight indicator. The oil tank is fitted with a pre-deformed diaphragm that ensures correct oil level.

3
Special Dacromet® treatment on the head bolts and mounting rails provide superior corrosion resistance and no maintenance.

4
Reduced stroke length increases diaphragm life because the diaphragms are not stressed.

5
Unique pulsation damper system absorbs pressure on all circuits resulting in a smoother flow of product. This unique technology provides dampening on 32 circuits instead of one, which reduces
- 6
Four diaphragm material options are available, contact factory.

7
New check valve design – unique spherical shaped poppet and conical seat made of stainless steel ensures perfect sealing while delivering high volumetric efficiencies and more pumping capacity.

8
Pre-set diaphragm bolt and diaphragm washer are made of 316 stainless steel. This exclusive feature of the CDS-John Blue Diaphragm High Pressure Pumps results in better chemical resistance and longer life of the pump.

9
Each piston has two piston rings for improved piston seal to keep a film of oil between the piston and diaphragm.



Recommended Accessories:

- Pressure regulator: SC-1480-3.

DP-230.1

- Maximum Flow: 23.0 gpm @ 29 psi
- Maximum Pressure: 725 psi
- Maximum Speed: 550 rpm
- Maximum Power: 11.6 hp
- Weight: 55.6 lbs.
- Diaphragms: 3
- Suction Hose Diameter: 1 1/2" Hose
- Discharge Hose Diameter: 3/4" NPT
- Max Temperature: 140°F
- Lubricating Oil Type: 30 SAE
- Through shaft with 1 3/8" spline both ends.

DP-230.1 Performance								
Pressure	RPM							
	400		450		500		550	
	gpm	hp	gpm	hp	gpm	hp	gpm	hp
29	16.64	1.7	18.76	1.9	20.90	2.1	23.00	2.3
290	16.40	3.4	18.50	3.8	20.60	4.3	22.70	4.7
580	16.10	6.6	18.23	7.5	20.30	8.4	22.45	9.3
725	16.10	8.3	18.23	9.4	20.30	10.6	22.45	11.6

DP-230.1

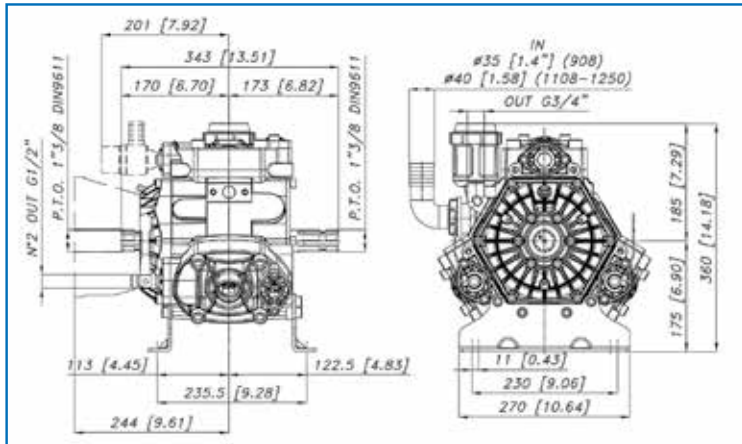

DP-392.1 Performance								
Pressure	RPM							
	400		450		500		550	
	gpm	hp	gpm	hp	gpm	hp	gpm	hp
29	29.3	0.60	32.7	0.68	36.2	0.76	39.6	0.80
290	28.8	6.0	32.2	6.80	35.6	7.5	39.1	8.2
580	28.5	12.0	31.7	13.3	35.2	14.8	38.6	16.2
725	28.3	14.8	31.4	16.5	34.8	18.3	38.3	20.1

DP-392.1

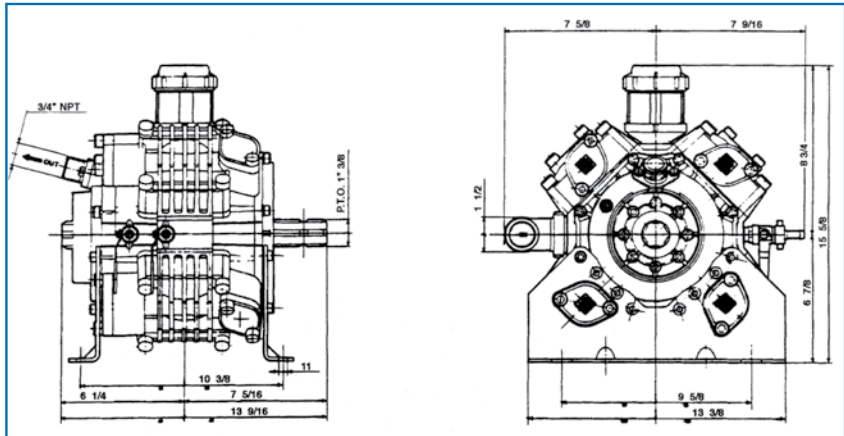

DP-392

- Maximum Flow: 39.2 gpm
- Maximum Pressure: 725 psi
- Maximum Speed: 550 rpm
- Maximum Power: 20.1 hp
- Weight: 105 lbs.
- Diaphragms: 4
- Suction Hose Diameter: 1 1/2" Hose
- Discharge Hose Diameter: 3/4" NPT
- Max Temperature: 140°F
- Lubricating Oil Type: 30 SAE
- Through shaft with 1 3/8" spline both ends.

Recommended Accessories:

- Pressure regulator: SC-1480-3

CDS-John Blue High Pressure “Golden” Brass Pumps

The CDS-John Blue High Pressure Golden Pumps are an ideal fit for orchard sprayers and flexible enough for any applications requiring high pressures. All pumping surfaces that come into contact with the pumped liquid are made from brass and the diaphragm washers are 316 stainless steel. The brass parts include the heads and manifolds, which make the CDS-John Blue Golden Pump fully protected against corrosion from commonly used products. The manifolds, which are positioned exterior to the crankcase, ensure that the pumps can be run safely and also help to extend the life of the pump. The ease of maintaining the Golden Pump is unmatched in the industry, due to the simplicity of servicing the valves.

Benefits of the CDS-John Blue High Pressure Golden Pump

- Heavy duty bronze three or five piston semi-hydraulic diaphragm pumps.
- Reliable long life.
- Ease of maintenance.
- Highly corrosion resistant to harsh herbicides and pesticides.
- Less pulsations.
- Easy to service
- Convenient visual oil-level sight indicator.
- Pumps can be run dry.



DP-291-B

- Maximum Flow: 29.1 gpm
- Maximum Pressure: 725 psi
- Maximum Speed: 550 rpm
- Maximum Power: 13.6 hp
- Weight: 85.6 lbs.
- Diaphragms: 3
- Suction Hose Diameter: 1 1/2" Hose
- Discharge Hose Diameter: 3/4" Straight Pipe
- Max Temperature: 140°F
- Lubricating Oil Type: 30 SAE
- Through shaft – 1 3/8" spline both ends.

Recommended Accessories:

- Pressure regulator: SC-1480-3
- One Outlet Pressure Regulator: SC-1480-1

DP-291-B Performance								
Pressure	RPM							
	400		450		500		550	
	gpm	hp	gpm	hp	gpm	hp	gpm	hp
29	20.6	0.4	23.2	0.5	25.8	0.5	28.4	0.6
290	20.4	4.1	23.0	4.6	25.6	5.1	28.1	5.6
580	20.2	8.1	22.8	9.1	23.3	10.1	27.8	11.1
725	20.0	10.0	22.5	11.2	25.0	12.5	27.6	13.7

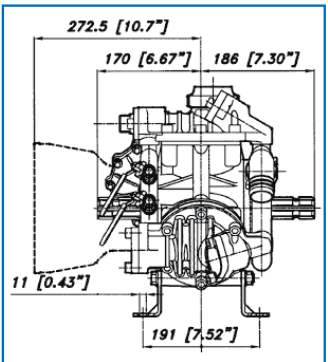
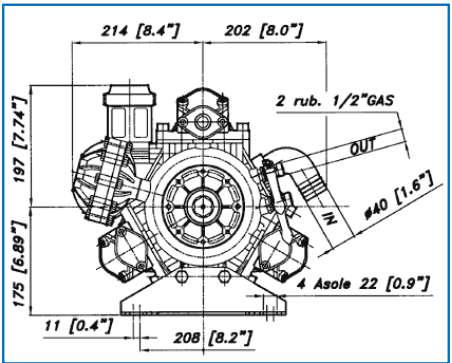

Spray Control Units and Miscellaneous Accessories are available on pages 57-61.

DP-375-B, DP-428-B, DP-481-B



DP-375-B

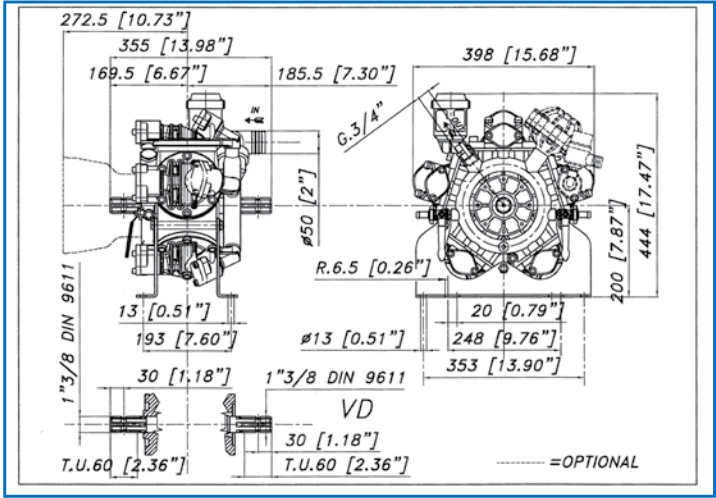

- DP-375-B**
- Maximum Flow: 37.5 gpm
 - Maximum Pressure: 725 psi
 - Maximum Speed: 550 rpm
 - Maximum Power: 17.8 hp
 - Weight: 119.9 lbs.
 - Diaphragms: 5
 - Suction Hose Diameter: 1 1/2" Hose
 - Discharge Hose Diameter: 3/4" Straight Pipe
 - Max Temperature: 140°F
 - Lubricating Oil Type: 30 SAE

DP-375-B Performance								
RPM								
Pressure	400		450		500		550	
	gpm	hp	gpm	hp	gpm	hp	gpm	hp
29	30.6	0.6	34.4	0.7	38.3	0.8	42.1	0.8
290	30.3	6.0	34.1	6.8	37.9	7.5	41.7	8.3
580	30.0	11.9	33.8	13.4	37.5	14.9	41.3	16.4
725	29.7	14.8	33.4	16.6	37.1	18.5	40.9	20.3

- Recommended Accessories:**
- Pressure regulator: SC-1480-3
 - One Outlet Pressure Regulator: SC-1480-1

- DP-428-B**
- Maximum Flow: 42.8 gpm
 - Maximum Pressure: 725 psi
 - Maximum Speed: 550 rpm
 - Maximum Power: 20.2 hp
 - Weight: 119.9 lbs.
 - Diaphragms: 5
 - Suction Hose Diameter: 2" Hose
 - Discharge Hose Diameter: 3/4" Straight Pipe
 - Max Temperature: 140°F
 - Lubricating Oil Type: 30 SAE

DP-428-B Performance								
RPM								
Pressure	400		450		500		550	
	gpm	hp	gpm	hp	gpm	hp	gpm	hp
29	26.4	0.5	29.7	0.6	33.0	0.7	36.3	0.7
290	26.1	5.2	29.4	5.8	32.7	6.5	36.0	7.1
580	25.9	10.3	29.1	11.6	32.4	12.9	35.6	14.2
725	25.6	12.7	28.8	14.3	32.0	15.9	35.2	17.5

- Recommended Accessories:**
- Pressure regulator: SC-1480-3
 - One Outlet Pressure Regulator: SC-1480-1

- DP-481-B**
- Maximum Flow: 48.1 gpm
 - Maximum Pressure: 725 psi
 - Maximum Speed: 550 rpm
 - Maximum Power: 22.8 hp
 - Weight: 119.9 lbs.
 - Diaphragms: 5
 - Suction Hose Diameter: 2" Hose
 - Discharge Hose Diameter: 3/4" Straight Pipe
 - Max Temperature: 140°F
 - Lubricating Oil Type: 30 SAE

DP-481-B Performance								
RPM								
Pressure	400		450		500		550	
	gpm	hp	gpm	hp	gpm	hp	gpm	hp
29	34.2	0.7	38.4	0.8	42.7	0.8	47.0	0.9
290	33.7	6.7	37.9	7.5	42.1	8.4	46.3	9.2
580	33.2	13.2	37.3	14.8	41.5	16.5	45.6	18.1
725	32.7	16.2	36.8	18.3	40.8	20.3	44.9	22.3

- Recommended Accessories:**
- Pressure regulator: SC-1480-3
 - One Outlet Pressure Regulator: SC-1480-1

CDS-John Blue Piston Spray Pumps

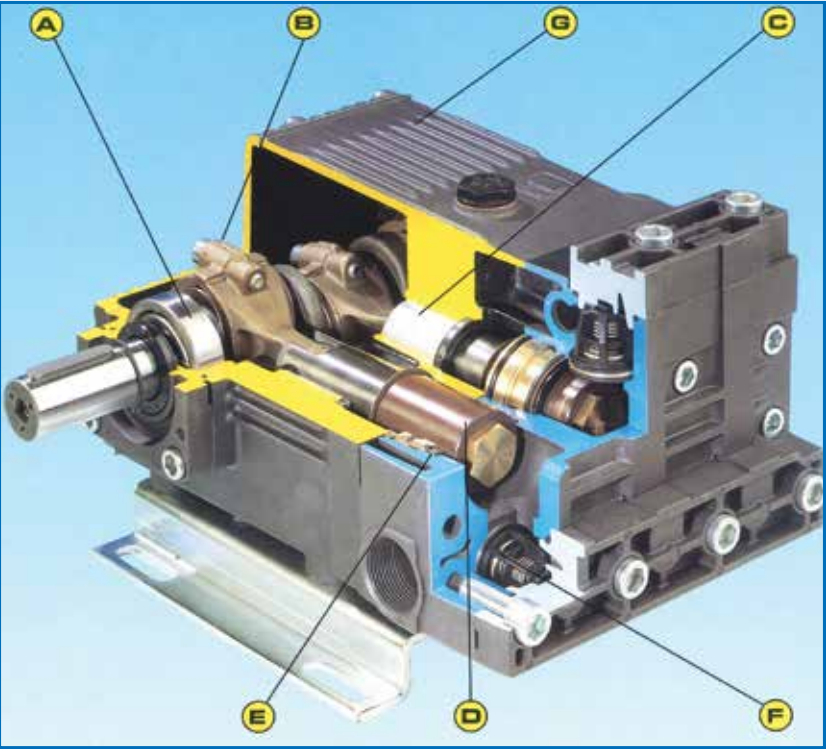

Features of the CDS-John Blue Piston Spray Pumps

- A. Premium oversized roller bearings provide extended life under extreme working conditions.
- B. Interlocking “self-aligning” connecting rods in high quality materials guarantee perfect alignment, ultimately reducing friction, heat, wear and noise.
- C. Patented du-dry plunger rod bushing coated in a Poly-Teflon material greatly reduces friction for smoother operation.
- D. Highly polished solid ceramic plungers reduce friction and prolong seal life.
- E. The double V-type seals separate the spray end from the crank case end, the same feature made popular on the CDS-John Blue Ground Driven Piston Pumps.
- F. The valves, poppets and seats are made from stainless steel. Separately interchangeable inlet-outlet valves assure the greatest volumetric efficiency and suction capability.
- G. Compact diecast aluminum crankcase for high strength and is anodized for corrosion resistance.

Spray Control Units are on Pages 57-61.

Select the Best CDS-John Blue Piston Spray Pump to Fit Your Needs

CDS-John Blue Piston Spray Pumps



Recommended control unit:
Control unit: SC-1240-3

PP-76

- Maximum Flow: 7.6 gpm
- Maximum Pressure: 725 psi
- Maximum Speed: 1450 rpm
- Power Requirement: 4 hp
- Weight: 25 lbs.
- Pistons: 3
- Suction Hose Diameter: 3/4" 90° Hose Barb
- Discharge Hose Diameter: 1/2" NPT
- Through Input Shaft: 1" (one side only)
- Max Temperature: 160°F
- Lubricating Oil Type: 30 SAE

PP-76 Performance									
RPM									
Pressure	800		1000		1200		1450		
	gpm	hp	gpm	hp	gpm	hp	gpm	hp	
29	4.4	0.1	5.5	0.1	6.6	0.1	7.9	0.2	
435	4.2	1.3	5.2	1.6	6.3	1.9	7.6	2.3	
580	4.0	1.6	5.0	2.0	6.0	2.4	7.3	2.9	
725	3.8	1.9	4.8	2.4	5.8	2.9	7.0	3.5	

PP-76

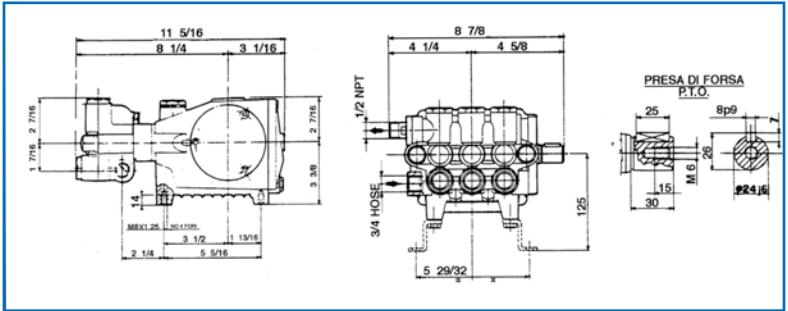

Recommended control unit:
Control unit: SC-1240-3

PP-134-1x1.25

- Maximum Flow: 13.4 gpm
- Maximum Pressure: 725 psi
- Maximum Speed: 550 rpm
- Power Requirement: 7 hp
- Weight: 44 lbs.
- Pistons: 3
- Suction Hose Diameter: 1" 90° Hose
- Discharge Hose Diameter: 1/2" NPT
- Through Input Shaft: 1" one end, 1 1/4" opposite end
- Max Temperature: 160°F
- Lubricating Oil Type: 30 SAE

PP-134-1x1.25 Performance									
RPM									
Pressure	400		450		500		550		
	gpm	hp	gpm	hp	gpm	hp	gpm	hp	
29	9.7	0.2	10.9	0.2	12.2	0.2	13.4	0.3	
435	9.7	2.9	10.9	3.2	12.1	3.6	13.3	4.0	
580	9.6	3.8	10.9	4.3	12.1	4.8	13.3	5.3	
725	9.6	4.8	10.8	5.4	12.0	6.0	13.2	6.6	

PP-134-1x1.25

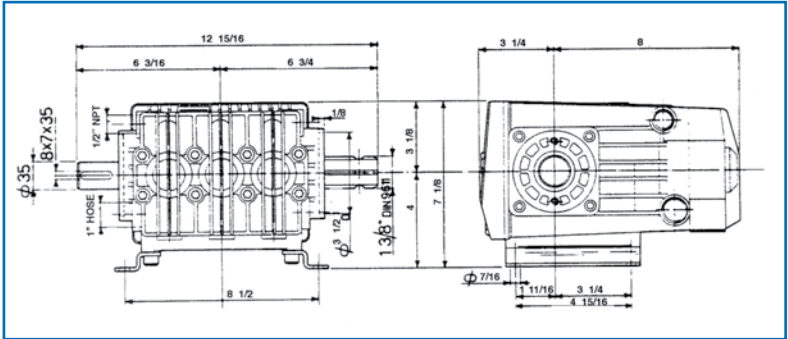

Recommended control unit:
Control unit: SC-1240-3

PP-238

- Maximum Flow: 23.8 gpm
- Maximum Pressure: 1015 psi
- Maximum Speed: 700 rpm
- Power Requirement: 18 hp
- Weight: 57 lbs.
- Pistons: 3
- Suction Hose Diameter: 1 1/4" 90° Hose
- Discharge Hose Diameter: 3/4" NPT
- Through Input Shaft: 1 3/8" splined shaft both sides
- Max Temperature: 160°F
- Lubricating Oil Type: 30 SAE

PP-238 Performance									
RPM									
Pressure	500		550		600		650		
	gpm	hp	gpm	hp	gpm	hp	gpm	hp	
29	17.3	0.3	19.0	0.4	20.7	0.4	24.2	0.5	
435	17.1	5.1	18.8	5.6	20.6	6.1	24.0	7.1	
725	17.0	8.4	18.7	9.3	20.4	10.1	23.8	11.8	
1015	16.8	11.7	18.5	12.8	20.2	14.0	23.5	16.3	

PP-238

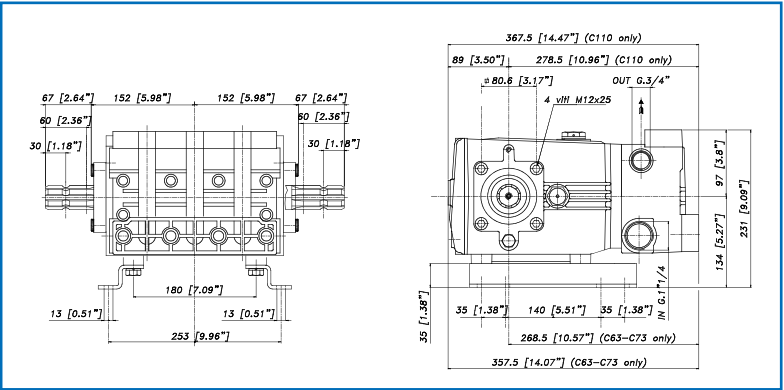

Recommended control unit:
Control unit: SC-1480-1 and
SC-1480-3

PP-280

- Maximum Flow: 27.7 gpm
- Maximum Pressure: 725 psi
- Maximum Speed: 550 rpm
- Power Requirement: 14.5 hp
- Weight: 57 lbs.
- Pistons: 3
- Suction Hose Diameter: 1 1/2" 90° Hose
- Discharge Hose Diameter: 3/4" NPT
- Through Input Shaft: 1 3/8" Splined Shaft both sides
- Max Temperature: 160°F
- Lubricating Oil Type: 30 SAE

PP-280 Performance									
RPM									
Pressure	400		450		500		550		
	gpm	hp	gpm	hp	gpm	hp	gpm	hp	
29	20.2	0.4	22.7	0.5	25.2	0.5	27.7	0.6	
435	19.8	5.9	22.3	6.6	24.8	7.4	27.2	8.1	
725	19.6	9.7	22.0	10.9	24.5	12.2	26.9	13.4	

PP-280

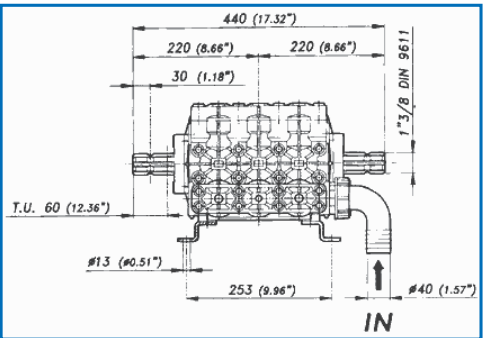
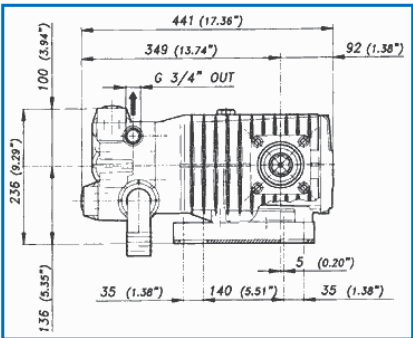



Recommended control unit:
Control unit: SC-1480-1, SC-1480-3

- PP-475**

 - Maximum Flow: 47.5 gpm
 - Maximum Pressure: 1015 psi
 - Maximum Speed: 700 rpm
 - Power Requirement: 35 hp
 - Weight: 86 lbs.
 - Pistons: 6
- Suction Hose Diameter: (2) 1 1/4" 90° Hose
 - Discharge Hose Diameter: (2) 3/4" NPT
 - Through Input Shaft: 1 3/8" Splined Shaft Both Sides
 - Max Temperature: 160°F
 - Lubricating Oil Type: 30 SAE

PP-475 Performance								
Pressure	RPM							
	500		550		600		650	
	gpm	hp	gpm	hp	gpm	hp	gpm	hp
29	34.6	0.7	38.1	0.8	41.5	0.8	48.4	1.0
435	34.2	10.2	37.6	11.2	41.0	12.2	47.9	14.3
725	34.0	16.9	37.4	18.6	40.8	20.2	47.6	23.6
1015	33.6	23.3	37.0	25.7	40.3	28.0	47.0	32.7

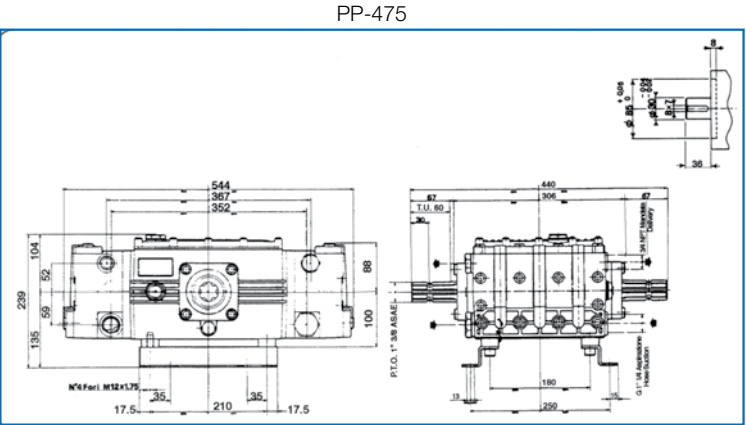

Recommended control unit:
Control unit: 2540-3

- PP-584**

 - Maximum Flow: 58.4 gpm
 - Maximum Pressure: 725 psi
 - Maximum Speed: 550 rpm
 - Power Requirement: 29 hp
 - Weight: 86 lbs.
 - Pistons: 6
- Suction Hose Diameter: (2) 1 1/2" 90° Hose
 - Discharge Hose Diameter: (2) 3/4" NPT
 - Through Input Shaft: 1 3/8" Splined Shaft Both Sides
 - Max Temperature: 160°F
 - Lubricating Oil Type: 30 SAE

PP-584 Performance								
Pressure	RPM							
	400		450		500		550	
	gpm	hp	gpm	hp	gpm	hp	gpm	hp
29	40.7	0.8	45.8	0.9	50.9	1.0	56.0	1.1
435	40.4	12.0	45.4	13.5	50.4	15.0	55.5	16.5
580	40.2	16.0	45.2	17.9	50.2	19.9	55.2	21.9
725	40.0	19.8	45.0	22.3	50.0	24.8	55.0	27.3

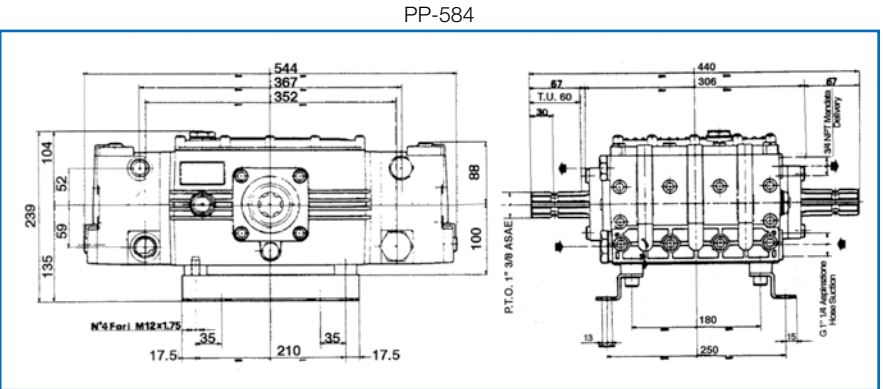

CDS-John Blue Spray Control Units



SC-1066-2

Recommended Accessories:
DP-318784
Remote Mounting Kit

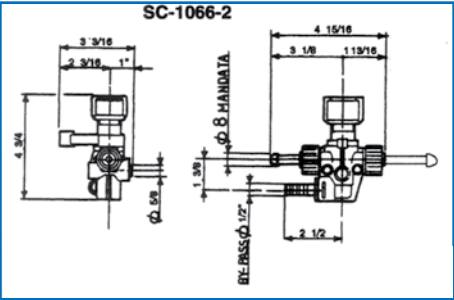

SC-1066-2 Series	
Flow Rate - 6.6 gpm	By-Pass Hose Diameter - 1/2" Hose
Maximum Pressure - 290 psi	Discharge Pressure Hose Diameter - 3/8" Hose
Unit Weight - 4 lbs	

The Pressure Regulator model SC-1066-2 can be mounted directly to the DP-43 Low Pressure Diaphragm Pump. The SC-1066-2 is designed to adjust to the liquid flow from the pump. Maximum operating pressure is 290 psi. It is constructed from polypropylene for excellent corrosion resistance. The valve, with double seals improves liquid velocity. This manual regulator is equipped with a main shut off/bypass lever, it is fitted for a port for a pressure gauge (optional) and has 1/2" NPT inlet and (2) 3/8 outlet barbs.



SC-1132-2

Recommended Accessories:
DP-318911
Remote Mounting Kit

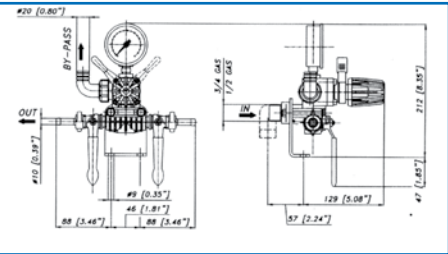

SC-1132-2 Series	
Flow Rate - 13.2 gpm	By-Pass Hose Diameter - 3/4" Hose
Maximum Pressure - 600 psi	Discharge Pressure Hose Diameter - 3/8" Hose
Unit Weight - 2 lbs	

Pressure Regulator model SC-1132-2 can be fitted directly to the pump or remote mounted to Pump DP-74.1. It is designed to provide gradual and smooth regulation of pressure up to 600 psi. The body is manufactured from reinforced plastic material with extra large valve passages to minimize pressure loss. A diaphragm seals off operating parts from contact with chemicals, which provides vibration resistance. Modular regulation, the glycerine filled pressure gauge is included. The remote control kit (available separately) is equipped with an inlet threaded connector 1/2" gas, straight or 90° to fit hositails from 10 to 19 mm. The manual bypass shut off lever is included. Available with two adjustable discharge ball valves on/off 1/2" gas threads.



SC-1240-3

Recommended Accessories:

- DP-318785 Remote mounting kit, 1/2" NPT inlet
- DP-318786 Remote mounting kit, 3/4" NPT inlet
- DP-318788 Remote mounting kit, 1/2" NPT 90°
- DP-318789 Remote mounting kit, 3/4" NPT inlet

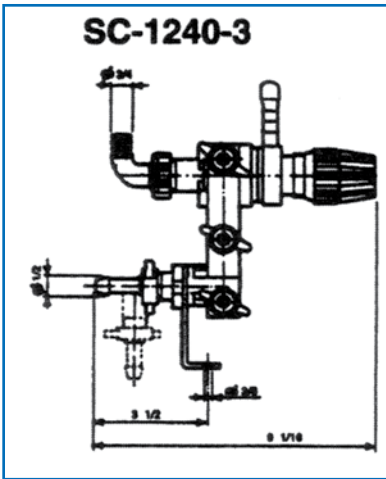

SC-1240-3

The Pressure Regulator model SC-1240-3 can be mounted directly or remote mounted to pumps DP-74.1 and DP-185.1. The SC-1240-3 is designed to provide gradual and smooth regulation of pressures up to 725 psi. The inlet body is constructed of aluminum with extra large passages, which helps to keep to a minimum pressure loss. The Buna-N diaphragm prevents the operating parts from coming into contact with the chemicals being applied, improving vibration resistance. The SC-1240-3 is equipped with a complete quick by-pass lever, pressure gauge, 3/4" NPT inlet and (3) 1/2" outlets.

SC-1240-3 Series

Flow Rate - 24.0 gpm	Suction Hose Diameter - 3/4" NPT
Maximum Pressure - 725 psi	Discharge Pressure Hose Diameter - 1/2" NPT
Unit Weight - 5 lbs	



NEW SC-1241-2

Recommended Accessories:

- DP-318911 Remote Mounting kit

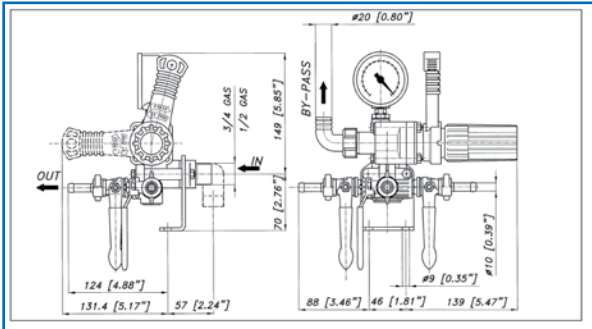

The **NEW** Sting Pressure Regulator model SC-1241-2 can be mounted directly or remotely to DP-74.1, DP-90.1 and DP-139. The Sting valve has an ergonomic adjusting knob resulting in gradual and smooth regulation of pressures up to 580 psi. The manual by-pass/shut off

lever is designed to shut off pressure and for immediate start-up. The valve body is constructed of heavy-duty polyamide. The valve seat and poppet are made of ceramic that helps to ensure a long life, even with aggressive chemicals. The SC-1241-2 is equipped with a pressure gauge and (2) 3/8" hose barbs.

SC-1241-2 Series

Flow Rate - 24.0 gpm	By-Pass Hose Diameter - 3/4" NPT
Maximum Pressure - 580 psi	Discharge Pressure Hose Diameter - 3/8" Hose
Unit Weight - 4 lbs	



SC-1480-3

Recommended Accessories:

- DP-318788 Remote mounting kit, 1/2" NPT 90°
- DP-318789 Remote mounting kit, 3/4" NPT inlet

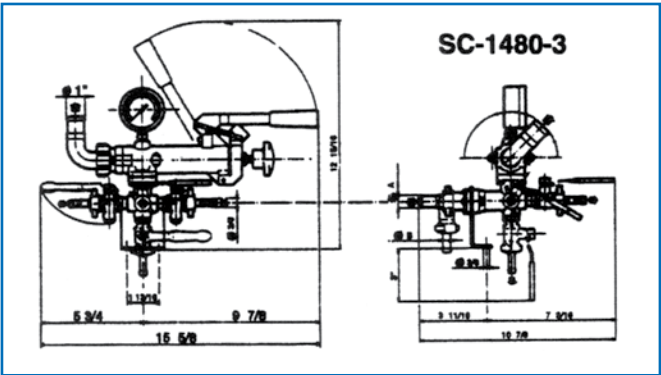

SC-1480-3

Pressure Regulator model SC-1480-3 can be mounted directly to the DP-230 and DP-392 or remote mounted to pumps with large flow rates up to 48 gpm. The SC-1480-3 is designed to provide gradual and smooth regulation of

pressures up to 725 psi. The inlet body is constructed of aluminum with extra large passages, which helps to keep to a minimum pressure loss and to handle large volumes. The SC-1480-3 is equipped with a complete quick by-pass lever, pressure gauge, 3/4" NPT inlet and (3) 1/2" hose barb outlets.

SC-1480-3 Series

Flow Rate - 48.0 gpm	Suction Hose Diameter - 3/4" NPT
Maximum Pressure - 725 psi	Discharge Pressure Hose Diameter - 1/2" NPT
Unit Weight - 5 lbs	



SC-2420-3

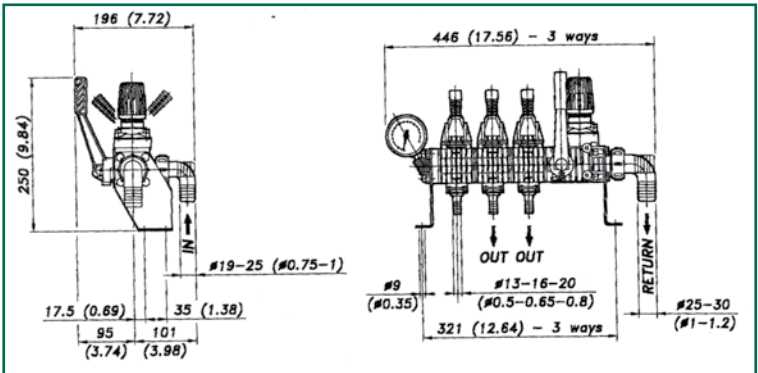

The remote control spray valve model SC-2420-3 is recommended for all pumps with flow rates less than 40 gpm (see pressure restrictions). The SC-2420-3 includes (3) 3/4"

outlets with individual shut-off and a ball valve main shut-off. A pressure relief valve is included. Three outlets come standard on the SC-2420-3, extra modular outlets are available separately through seven sections.

Note: When using with DP-177 use a 3/4" inlet.

SC-2420-3 Series

Flow Rate - 42.0 gpm	Suction Hose Diameter - 1" Hose
Maximum Pressure - 290 psi	Discharge Pressure Hose Diameter - 3/4" NPT
Unit Weight - 8 lbs	



SC-2540-3

The SC-2540-3 is a high-pressure (725-psi) remote spray control valve. This control valve has (3) outlets for boom sections. The valve is rated up to 54 gpm and has a ball valve main shut off. This positive shut-off diverts all flow to bypass, completely unloading the pressure. The SC-2450-3 has an exclusive **anti-drip system** that prevents the nozzles from dripping, without nozzle check valves, when the main shut off is closed.

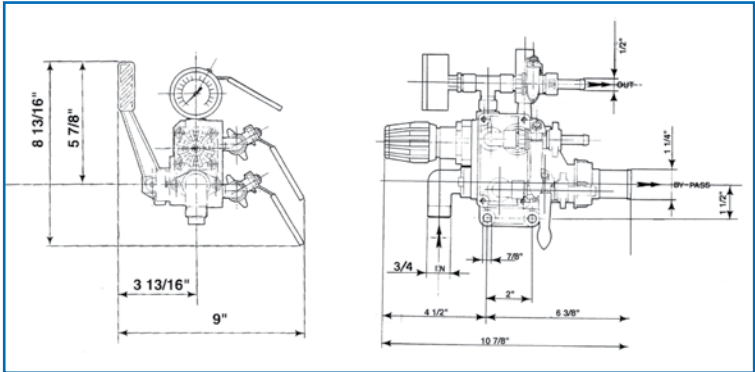

SC-2540-3 Series

Flow Rate - 54.0 gpm	Suction Hose Diameter - 3/4" Hose
Maximum Pressure - 725 psi	Discharge Pressure Hose Diameter - 1/2" NPT
Unit Weight - 8 lbs	

EXCLUSIVE
ANTI-DRIP
FEATURE



SC-2660-3

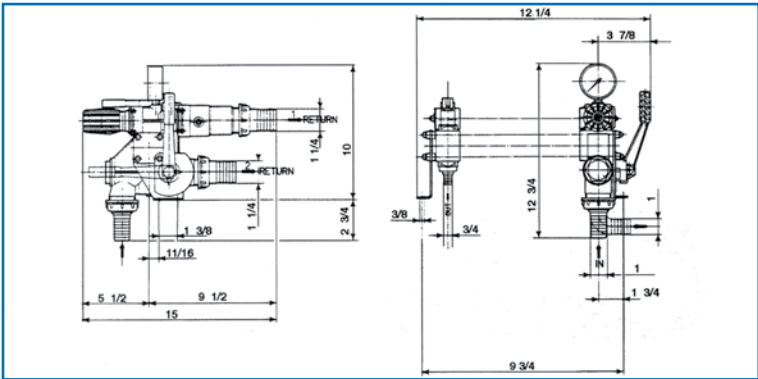

The SC-2660-3 is a remote control valve with a **volumetric control**, which maintains the spray rate per acre at varying ground speeds when using a ground speed controlled positive displacement pump.

The volume per acre is constant; pressure will vary as ground speed varies.

Each boom section has a metered bypass system to allow an individual boom section to be closed without adjusting the **volumetric control valve**. This control valve has a ball valve main shut-off, which provides a positive shut-off. The SC-2660-3 control valve has an **exclusive anti-drip** system that prevents the nozzles from dripping when the main shut-off is closed. There is no need for nozzle check valves.

SC-2660-3 Series

Flow Rate - 66.0 gpm	Suction Hose Diameter - 1" Hose
Maximum Pressure - 145 psi	Discharge Pressure Hose Diameter - 1/2" NPT
Unit Weight - 18 lbs	

VOLUMETRIC
CONTROL

EXCLUSIVE
ANTI-DRIP
FEATURE



SR-220

The SR-220 is a Poly and 316 stainless steel spray pressure regulator with brackets. Equipped with a 1" inlet, 1" outlet and 3/4" pressure regulated bypass. The SR-220 does not have a shut-off valve.

SR-220 Series

Flow Rate - 42.0 gpm	Suction & Discharge Hose Diameter - 1" Hose
Maximum Pressure - 290 psi	Pressure Regulated Bypass Hose Diameter - 3/4" Hose

Miscellaneous Kits	
Model Number	Description
DP-318508	Remote Mount Kit for SC-1132-2, 1/2" NPT Inlet
DP-318784	Remote Mount Kit for SC-1066-2
DP-318785	Remote Mount Kit for SC-1240-3, 1/2" NPT inlet
DP-318786	Remote Mount Kit for SC-1240-3 and SC-1480-3, 3/4" NPT inlet
DP-318788	Remote Mount Kit for SC-1240-3, 90°, 1/2" NPT inlet
DP-318789	Remote Mount Kit for SC-1240-3 and SC-1480-3, 90°, 3/4" 80NPT inlet
DP-318697	6:1 Gearbox Reduction Kit for DP-43, DP-74.1, DP-139, and DP-185.1, fits 3.5 and 5 HP gasoline engines
DP-318724	6:1 Gearbox Reduction Kit for DP-139, DP-185.1, fits 8 and 11 HP gasoline engines
DP-318874	Gearbox for DP-193-PP and DP-280-PP, use with 1" pump shaft and 3/4" engine shaft. Must use (1) DP-31155907 spacer and (4) DP-86357500 bolts when using DP-282-P and DP-332-P.
DP-310088	1 3/8" Female Shaft Kit for DP-43
DP-318343	1 3/8" Female Shaft Kit for DP-74.1 and DP-124
DP-310049	1 3/8" Male PTP Shaft Kit for DP-74.1 and DP-124
DP-318793	3/4" Solid Shaft Kit for DP-43 and DP-74.1
DP-318590	1" Solid Shaft Kit
DP-31874897	Hydraulic Adapter for DP-43, DP-74.1, DP-124 and DP-139
DP-31874997	Hydraulic Adapter for DP-280-1, DP-280-PP, DP-193-PP, DP-282-P and DP-332-P
DP-318086	PTO Kit for Diaphragm Pump
115559-91	Electric Motor Conversion Kit for pumps with a gearbox. For use with DP-43-GRI, DP-43-GRSP, DP-43-GRP and DP-74.1-GRI only.

Spray Guns



The SC-0400 spray gun has two possible spray adjustments. By operating the handle it controls the spray angle from cone spray to a straight stream.



The SC-1300 is a stainless steel washing spray gun.



CDS-John Blue Low Volume, High Pressure Guns and Lances



Spray Gun SC-2900



Spray Gun SC-4200

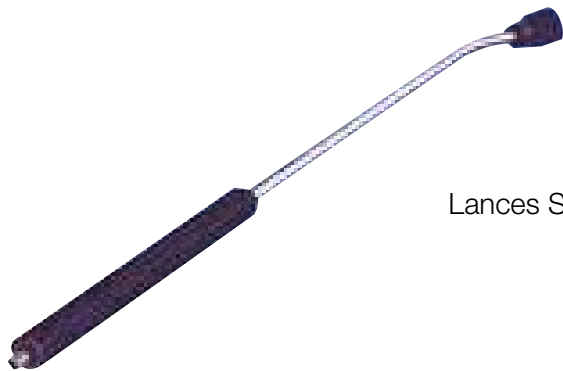

Lances SC-28100

Low Volume, High Pressure Guns and Lances							
Part Number	Description	Inlet Straight Gas Pipe Thread	Outlet Straight Gas Pipe Thread	Max Pressure	Max Flow	Max Temp	Length
SC-2900	Spray Gun Without Extensions	3/8"	1/4"	2900 psi	7.9 gpm	302°	n/a
SC-4200	Spray Gun Professional Without Extensions	3/8"	1/4"	4200 psi	10.6 gpm	302°	n/a
SC-28100	Lances With Melted Handle & Nozzle Head	1/4"	1/4" NPT-F	4200 psi	10.6 gpm	302°	n/a
SC-36200	Lances With Melted Handle & Nozzle Head	1/4"	1/4" NPT-F	4200 psi	10.6 gpm	302°	36"

CDS-John Blue Foam Markers

The Most Economical, Accurate & Dependable Foam Markers

The CDS-John Blue Foam Markers are a simple, reliable solution to visually mark the edge of your sprayed area through deposits of foam balls. It's the most common and economical way to avoid double coverage or lack of coverage during application of chemicals and fertilizers. The CDS-John Blue Foam Markers are easy to install and operate. The system creates a highly visible foam line in the field that correctly marks your position. Mixing water with an inert foaming concentrate liquid in a 1.5 to 3 percent solution creates the foam and is both environmentally friendly while economical.

Foam is generated at the end of the boom. This eliminates the foam breaking down in the boom as well as decreasing the waiting period for the foam to travel to the end of the boom. This makes changing sides more efficient.

All CDS-John Blue Foam Marker Kits consist of a 12-volt compressor, a solution tank, control box and parts necessary for installation on any type of spraying equipment or whenever precision applications are needed.

CDS-John Blue Foam Markers								
Part Number	Applicator Sprayer	Boom Size	Tank Size	Refill Time (Approx.)		Output (Balls/min)		Foam Nozzles
				Max Rate	Min Rate	Max Rate	Min Rate	
FM-150	Ag Sprayer	Up to 100 ft.	15 gal	4 hrs	7.5 hrs	23	17	2 Horizontal Switching
FM-64	Ag Sprayer	Up to 65 ft.	6.4 gal	2 hrs	2.5 hrs	31	18	2 Vertical Switching
FM-40	Golf/Turf	Up to 40 ft.	4 gal	2 hrs	3 hrs	25	18	2 Horizontal Switching
FM-40-1	Golf/Turf		4 gal	2 hrs	3 hrs	25	18	2 Vertical Switching
FM-10	ATV Sprayer	Up to 12 ft.	1 gal	1 hrs	3 hrs	22	12	2 Vertical Switching
FM-10-WB	Walk behind spreaders		1 gal	1 hrs	3 hrs	22	12	1 Vertical

Foam Marker Kits



FM-150 includes:

- Factory mounted compressor on the tank.
- 118 ft. of liquid and air tubing.
- Air tube: 5/16" diameter.
- Liquid tube: 1/4" diameter.
- 15 ft. of cable to connect the remote switch to the compressor.
- 6 ft. of power cable to connect remote switch to power supply.

Optional Kits:

- Foam nozzle extension used to generate small foam stripes.
- 150 ft. of air and liquid tubing for booms larger than 100 ft.



FM-64 includes:

- Compressor is mounted separately from the tank.
- 82 ft. of liquid and air tubing.
- Air tube: 1/4" diameter.
- Liquid tube: 1/4" diameter.
- 15 ft. of cable to connect the remote switch to the compressor.
- 6 ft. of power cable to connect remote switch to power supply.



FM-40 and FM-40.1 Golf/Turf Foam Markers:

- FM-40 has 52 ft. of liquid and air tubing (for end of boom discharge).
- FM-40-1 has 15 ft. of liquid and air tubing (for center discharge).
- Air tube: 1/4" diameter.
- Liquid tube: 1/4" diameter.
- 15 ft. of cable to connect the remote switch to the compressor.

Optional Kit:

- Switch Box Kit: Allows foam to be discharged from both ends at the same time.
- 6 ft. of power cable to connect remote switch to power supply.



FM-10 ATV Foam Marker:

- 2 x 10 ft. of liquid & air tubing.
- Air tube: 1/4" diameter.
- Liquid tube: 1/4" diameter.
- 10 ft. of cable to connect the remote switch to the tank.
- 6 ft. of power cable connecting remote switch to power supply.



FM-10-WB:

- 7 ft. of liquid & air tubing.
- Air tube: 1/4" diameter.
- Liquid tube: 1/4" diameter.
- Rechargeable battery and charger included (approximately 2 1/2 hours per charge).

All CDS-John Blue Foam Marker Kits consist of a 12-volt compressor, a solution tank, control box and necessary parts for installation.

All CDS-John Blue Foam Marker Kits consist of a 12-volt compressor, a solution tank, control box and necessary parts for installation.



CDS-John Blue 12-Volt Pumps

The CDS-John Blue 12-Volt Pump is the only 12-Volt pump on the market today totally protected against weather, dust and overspray – it’s weatherproof tested. Three models are available with capacities of 2.2, 3.6 and 4.8 gpm.



Features:

- Weatherproof tested- the only 12-Volt Pump to be totally protected against weather, dust and overspray.
- Four piston diaphragm for a smoother flow.
- Quick connect ports system means it’s faster to install, requires fewer parts and connections while reducing the number of potential leak points.
- Integral pressure switch is fully sealed.
- Low current draw results in a longer battery life.
- Maximum operating pressure – 45 psi.
- Automatic demand.
- Chemical resistant construction suitable for most fertilizers and chemicals.
- Santoprene® diaphragms and valves.
- Viton® seals.
- Glass-filled polypropylene housing.
- Strainer is made from polycarbonate, 316 stainless steel 50 mesh screen.
- 1-year unconditional warranty.

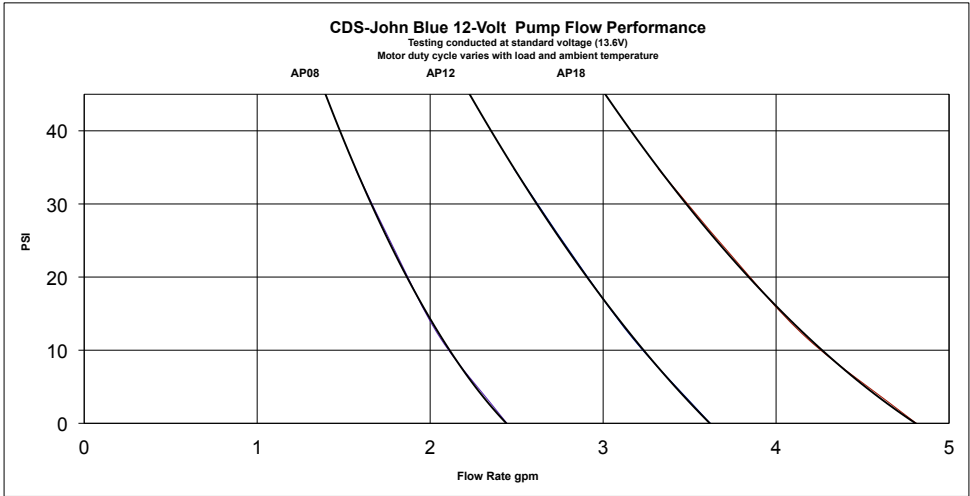

12-Volt Pumps and Accessories	
Part Number	Description
AP0816W	2.2 gpm, max amp draw 7 amps, weight 5.3 lbs., inlet/outlet ports 15 mm quick connect ports including clear sight-glass strainer, 5 hose barb quick connect fittings, min wire size 14 AWG.
AP0819W	2.2 gpm, max amp draw 7 amps, weight 5.3 lbs., inlet/outlet ports ½" NPT male, min wire size 14 AWG.
AP1216W	3.6 gpm, max amp draw 12 amps, weight 5.3 lbs., inlet/outlet ports 15 mm quick connect ports including clear sight glass strainer, 5 hose barb quick connect fittings, min wire size 12 AWG.
AP1219W	3.6 gpm, max amp draw 12 amps, weight 5.3 lbs., inlet/outlet ports ½" NPT male, min wire size 12 AWG.
AP1816W	4.8 gpm, max amp draw 13 amps, weight 6.4 lbs., inlet/outlet ports 15 mm quick connect ports including clear sight glass strainer, 5 hose barb quick connect fittings, min wire size 12 AWG.
AP1819W	4.8 gpm, max amp draw 13 amps, weight 6.4 lbs., inlet/outlet ports ½" NPT male, min wire size 12 AWG.
AK1317W	Universal Microswitch kit
AK1322W	Universal pump head
AK1323W	Universal inlet strainer 90 degrees
AK1584W	Quick connect ½" barb
AK1591W	Quick connect ½" barb elbow
AK1592W	Quick connect ¾" barb elbow

CDS-John Blue 12-Volt Speed Controllers



The CDS-John Blue 12-Volt Speed Controller regulates motor speed on any 12-volt pump to vary the output. It provides accuracy over a wide range of RPM's. The 12-Volt Controller coupled with the CDS-John Blue 12-volt pump is ideal for low volume fertilizer applications.

NEW to the CDS-John Blue 12-volt controller line up is the Digital Display Model. With the digital model no pressurized fertilizers or chemicals can get in the cab of the tractor. The remote sending unit includes ¼" NPT fittings and 25 foot wiring harness (optional 15 foot extension harness is available). The model includes an illuminated easy to read digital display.

Features:

- Rheostat manual speed control for 12-Volt Pumps.
- Reverse polarity protection.
- Built-in circuit breaker.
- On/off control switch with power indicator lamp.
- Models available with or without integrated stainless steel pressure gauge. Optional digital pressure gauge models available.
- Mounts in the tractor cab for easy access.
- Run/hold feature on 25A and 35A models, works with limit switch or hall-effect sensor.
- Heavy gauge wiring.
- Metal enclosure with mounting flanges.
- All CDS-John Blue 12-Volt Controllers are backed by a 1-year warranty.

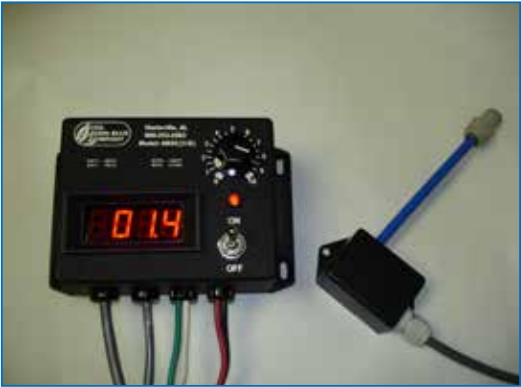

AKSC35-07

Available Plumbing Kit for Gauge and No Gauge Models:

- 10 feet input wire
- 20 feet output wire
- 20 feet tubing (for stainless steel gauge units)
- ¼" NPT tubing fittings

12-Volt Controllers and Accessories	
Part Number	Description
AKSC10-00	10 AMP with wiring kit and no gauge
AKSC10-01	10 AMP with wiring/plumbing kit and stainless steel ammonia gauge
AKSC10-03	10 AMP with wiring/plumbing kit less gauge
AKSC10-05	10 AMP controller only, no gauge
AKSC10-06	10 AMP controller only with stainless steel ammonia gauge
AKSC25-00	25 AMP with wiring kit and no gauge
AKSC25-01	25 AMP with wiring/plumbing kit and stainless steel ammonia gauge
AKSC25-02	25 AMP with plumbing kit and digital gauge
AKSC25-03	25 AMP with wiring/plumbing kit less gauge
AKSC25-05	25 AMP controller only, no gauge
AKSC25-06	25 AMP controller only with stainless steel ammonia gauge
AKSC25-07	25 AMP controller only with digital gauge
AKSC35-00	35 AMP with wiring kit and no gauge
AKSC35-01	35 AMP with wiring/plumbing kit and stainless steel ammonia gauge
AKSC35-02	35 AMP with plumbing kit and digital gauge
AKSC35-03	35 AMP with wiring/plumbing kit less gauge
AKSC35-05	35 AMP controller only, no gauge
AKSC35-06	35 AMP controller only with stainless steel ammonia gauge
AKSC35-07	35 AMP controller only with digital display
AKSCP-017	20 ft. output wiring harness extension cable (fits 10A, 25A and 35A models)
AKSCP-021	15 ft. digital pressure sensor extension cable

Miscellaneous Drive Components For Pump Drives see page 12-13.	
Part Number	Description
LA-1341-HA	Hub Sprocket Adaptor - 4 Bolt
106190-01	Hub Sprocket Adaptor - 5 Bolt
A-1341-HA	Hub Sprocket Adaptor - 6 Bolt
A-1342-BP	50 Tooth Roller Chain Sprocket (50)
A-1342-AP	60 Tooth Roller Chain Sprocket (50)
A-1502-P	80 Tooth Roller Chain Sprocket (50)
114565-91	35 tooth split sprocket for 7/8" hex shaft, for piston and squeeze pumps.
114936-91	32 tooth split sprocket for 7/8" hex shaft, for piston and squeeze pumps.

Seal & Gasket Repair Kits for Centrifugal Pumps For Centrifugal Pumps see pages 34-36.	
103274	Seal & Gasket Repair Kit - 1 1/2" and 2" Straight Centrifugal, Double Seal Viton
103276	Seal & Gasket Repair Kit - 2" Self-Priming Centrifugal Pump
103277	Seal & Gasket Repair Kit - 3" Straight Centrifugal, Double Seal Viton
103278	Seal & Gasket Repair Kit - 3" Self-Priming Centrifugal, Double Seal Viton
110128	Seal & Gasket Kit - S-3325 and S-3325-DS (Ceramic)
110130	Seal & Gasket Kit - S-3330 and S-3330-DC (Silicon Carbide)

Seal Kits for Centrifugal Pumps For Centrifugal Pumps see pages 34-36.	
S-3756	Seal Kit - 1 1/2" and 2" Straight and Self-Priming Centrifugal, Double Seal Viton
S-3757	Seal Kit - 3" Straight and Self-Priming Centrifugal, Double Seal Viton
103839-91	Seal Kit - S-3680 and S-3681 Hydraulic Motor
110127	Seal Kit - S-3325, S-3325-DS and SP-3325 Truck Pump
110129	Seal Kit - S-3350 and S-3330-DS Truck Pump

Repair Kits for Pumps and Fittings	
F-592	Gasket Repair Kit - For Acid Pumps FA-500 and FA-501
F-592-U	Gasket Repair Kit - For Fumigant Pumps FA-500-U, FA-500 and FAC-500-U
109414	Gasket Repair Kit - For Acid Pumps FA-550 and FA-551
109415	Gasket Repair Kit - For Fumigant Pumps FU-550 and FU-551
104120	Gasket Repair Kit - For A-1610 N-Serve Pump
113604	Gasket Repair Kit - For A-1610-A Pump
L1095-B	Gasket Repair Kit - For L-1094 Pump (for SN Above 2100) and L-905 Pump
L-3090	Gasket Repair Kit - For L-3000-SS, L-4900, L-4905 and L-4910 Pumps
L-4090	Gasket Repair Kit - For L-4000-SS, L-4400, and L-4409 Pumps
L-4090-U	Gasket Repair Kit - For L-4400 Fumigant Pump
L-5065	Gasket Repair Kit - For L-5000 Pump
106029	Gasket Repair Kit - For L-5100 Pump
S-555-Q	Gasket Repair Kit - For "Blue" Quad Spray Pump
S-555-T	Gasket Repair Kit - For "Blue" Twin Spray Pump
115036	Gasket Repair Kit - For LM-1255 Pump
113717	Gasket Repair Kit - For LM-2450 Pump
111953	Gasket Repair Kit - For LM-4450 and L-4400-HS Pumps
111947	Gasket Repair Kit - For LM-4950 and L-4900-HS Pumps
115788	Gasket Repair Kit - For NGP-6050
115688	Gasket Repair Kit - For NGP-7050
115789	Gasket Repair Kit - For NGP-8050
115689	Gasket Repair Kit - For NGP-9050

Repair Kits for Pumps and Fittings	
Part Number	Description
113842	Fumigant Kit - For LM-2450 Pump
114638	Fumigant Kit - For LM-4450 and L-4400-HS Pumps
114899	Fumigant Kit - For LM-4950 and L-4900-HS Pumps
113016	Repair Kit - For L-4600 Pump
115041	Repair Kit - For Low Volume Irrigation Injection Unit
115404	Repair Kit - IN-1716-SA/SF, IN-1000-SA/SF
115283-91	Repair Kit - Pumping End Only - IN-1716-SA/SF, IN-1000-SA/SFO
106531	Repair Kit - For 105429 Hydraulic Control

*Gasket Repair Kit includes all gaskets and rubber seals; o-rings, piston seals, rod seals and crankshaft seals

Anhydrous Ammonia Meter Gasket Repair Kits and N-Serve Check Valve	
104507	Gasket Repair Kit - For 104390 Electric Control for A-3310
104508	Gasket Repair Kit - For 104445 Electric Control for A-3910 and A-3911
104532	Gasket Repair Kit - For A-3300 Body
104533	Gasket Repair Kit - For 102926 Manual Control for A-3300
104534	Gasket Repair Kit - For A-3900 Body
104535	Gasket Repair Kit - For 103230 Manual Control for A-3900 and A-3901
110795	Gasket Repair Kit - For A-3901 and A-3911 Body
115143-91	N-Serve Check Valve has a seal that is compatible with N-Serve and anhydrous ammonia: prevents backflow of anhydrous ammonia into the N-Serve pumping system.

Includes all rubber seals.

Squeeze Pump Hoses and Miscellaneous Parts Squeeze Pumps are on pages 25-27.	
L-1265	Squeeze Pump Hose Kit - 6 Hose Set, 1/2" Hose
LA-1265	Squeeze Pump Hose Kit - 8 Hose Set, 5/16" Hose
87249	Squeeze Pump Hose - 1 Hose, 1/2" Hose
87250	Squeeze Pump Hose - 1 Hose, 5/16" Hose
A-3127-G	Gasket for Fill Valve
08-0010	3/8" Diameter Squeeze Tube for "B" Model Pump
08-0020	5/8" Diameter Squeeze Tube for "L" Model Pump
08-0015	Inlet Fitting Stainless Steel "B" Pump
08-0013	Outlet Fitting Stainless Steel "L" Pump
08-0021	Inlet Fitting Stainless Steel "L" Pump
08-0022	Outlet Fitting Plastic "L" Pump

Strainers and Strainer Components	
L-1116	Strainer - Fertilizer 1 1/4" Hose Barbs, Cast Iron
L-4001	Strainer - Fertilizer 1 1/2" Hose Barbs
L-1118	Strainer Screen - 30 Mesh, for L-1116 and L-4001
L-1118-12	Strainer Screen - 12 Mesh, for L-1116 and L-4001
L-3084-10	Strainer Screen - 10 Mesh, Small
L-3084	Strainer Screen - 30 Mesh, Small
L-3085	Strainer Screen - 10 Mesh, Large
A-3758-A	Sleeve Gasket - For A-3900 and A-3901
A-3238-A	Gasket - For A-3300
101266-01	Gasket Cap - For L-3080, L-3080-12, L-3120 and L-2120-12
101267-01	Gasket Cap - For L-1116 and L-4001
L-3120	Strainer - For LM-4950, Cast Iron, 30 Mesh, 2" Hose Barbs
L-3422	Strainer - Nylon, 30 Mesh

Operator Kits
(Includes Manuals and Slide Rules)

Part Number	Description
115390	Operators Kit - LM 1255 Piston Pump
115391	Operators Kit - LM 2450 Series Piston Pump
115392	Operators Kit - L-4400 Series Piston Pump
115393	Operators Kit - LM-4450 Series Piston Pump
115394	Operators Kit - LM-4950 Series Piston Pump
115280-91	Mounting Kit for LM and L Series Piston Pumps
115787	Operators Kit - NGP Series Piston Pump

Conversion Kits

105429	Hydraulic Throwout Conversion Kit - For L-4400, LM-4450 and LM-4950 Series Pumps
113647	Hydraulic Throwout Conversion Kit - For LM-2450 Series Pumps
114103	Electric Conversion Kit - For LM-2450 Series Pumps
114104	Electric Conversion Kit - For LM-4450 Series Pumps
115155-91	Electric Conversion Kit - For LM-4950 Series Pumps (Must use LM-4955 Pump)

Miscellaneous Planter Kits

115189-91	Grain Drill Mount Only for Diaphragm, Piston and Squeeze Pumps (includes mounting hardware)
115190-91	Countershaft without sprockets for 115189-01 Grain Drill Mount

Sprockets for Pumps without Clutch

114516-01	12 Tooth Sprocket - RC 40, 1" Bore
113905-01	18 Tooth Sprocket - RC 40, 1" Bore
115156-01	18 Tooth Sprocket - RC 40, 7/8" Hex
114517-01	23 Tooth Sprocket - RC 40, 1" Bore
114932-01	32 Tooth Sprocket - RC 40, 1" Bore
114936-91	32 Tooth Sprocket - RC 40 Split for 7/8" Hex
114565-91	35 Tooth Sprocket - RC 40 Split for 7/8" Hex
113611-01	11 Tooth Sprocket - RC 50, 1" Bore
114677-01	14 Tooth Sprocket - RC 50, 1" Bore
113685-01	16 Tooth Sprocket - RC 50, 1" Bore
106532-01	18 Tooth Sprocket - RC 50, 1" Bore
115157-01	18 Tooth Sprocket - RC 50, 7/8" Hex
112773	24 Tooth Sprocket - RC 50, 1" Bore
105482-01	32 Tooth Sprocket - RC 50, 1" Bore
112774	36 Tooth Sprocket - RC 50, 1" Bore

“CDS-John Blue Company is an industry leader with significant name recognition and a superb reputation in the field. Our customers demand CDS-John Blue Pumps because they have proven to be a reliable and effective tool for the agricultural industry.”

Ed Wunsch
Vice President
Big W Sales, CA

“We have come to use the word quality when we think of CDS-John Blue Company. From the irrigation injection pumps to the 3” cast iron centrifugal pumps, we believe they have the best products on the market today. The sales and service department they have are second to none. When we do have problems and can’t answer questions their staff has always been willing and able to go the extra mile to help our customers get back in the field.”

Darren Zerr
Store Manager
Schaben Industries, Kansas

“Southeast Farm Equipment Company has been an authorized sales and service dealer for CDS-John Blue Company for many years. We have been privileged to offer our customers the best liquid metering pumps and equipment the industry has to offer. CDS-John Blue Company offers dependable equipment with over 125 years of history. In addition to the excellent equipment the sales support staff in Huntsville is tops in the industry with knowledge and reliable service. Being part of the CDS-John Blue team is important to our organization as we grow in the future.”

Charles L. Liles
President
Southeast Farm Equipment Company, NC

“We have been buying pumps from the CDS-John Blue Company for over 30 years. They have never given us a reason to look anywhere else because we never have to question the quality, durability and service we get from the pumps at CDS-John Blue. They are also a very progressive company that is not afraid to make the needed changes to keep their equipment at the top of the industry. Whether it is a piston, E-Z meter or centrifugal pump, CDS-John Blue is usually the pump that our customers demand.”

Mickey O’Neill
Vice President Sales & Marketing
Wylie Manufacturing, TX



For Fast, Convenient and up-to-date information, call CDS-John Blue Company at:

Order Department and Technical Support

Phone US and Canada Toll-Free: 800-253-2583

Phone Outside US and Canada: 256-895-9936

Company Headquarters: 256-721-9090

FAX: 256-721-9091

Visit our website at cds-johnblue.com or better yet contact your local dealer to find out why CDS-John Blue continues to set the standard in the agricultural applicator pump industry.



Follow us on Facebook

CDS-John Blue Company

Division of Advanced Systems Technology
PO Box 1607 • Huntsville, Alabama 35807
290 Pinehurst Drive • Huntsville, Alabama 35806

www.cds-johnblue.com

E-mail: info@cds-johnblue.com

ISO 9001 Certified