

## FIG. 7001-2

### Standard Flexible Coupling

Gruvlok® introduces new 2-piece large diameter standard groove couplings in both rigid and flexible styles

- Uses standard grooves (conforming to AWWA C-606)
- No special grooves or grooving tools needed
- Pressures to 350 P.S.I. on cut or roll grooved pipe with a wall thickness of 0.250" or greater
- No special fittings needed
- No special valves needed
- Up to 23% less weight than competitive models
- Sizes: 14" through 24" in Flexible: Figure 7001-2



### MATERIAL SPECIFICATIONS

#### ANSI BOLTS & HEAVY HEX NUTS:

Heat treated, oval neck track head bolts conforming to ASTM A 183 Grade 2 with a minimum tensile strength of 110,000 psi and heavy hex nuts of carbon steel conforming to ASTM A 563 Grade A or Grade B, or J995 Grade 2. Bolts and nuts are provided zinc electroplated as standard.

#### STAINLESS STEEL BOLTS & NUTS:

Stainless steel bolts and nuts are also available. Contact an Anvil Representative for more information.

#### HOUSING:

Ductile Iron conforming to ASTM A 536, Grade 65-45-12

#### COATINGS:

- ☐ Rust inhibiting paint – Color: ORANGE (standard)
  - ☐ Hot Dipped Zinc Galvanized (optional)
  - ☐ Other Colors Available (IE: RAL3000 and RAL9000)
- For other Coating requirements contact an Anvil Representative.

#### GASKETS: Materials

Properties as designated in accordance with ASTM D 2000

- ☐ Grade "EP" EPDM (Green and Red color code) Standard  
-40°F to 250°F (Service Temperature Range)(-40°C to 121°C)  
Recommended for water service, diluted acids, alkalis solutions, oil-free air and many other chemical services.  
NOT FOR USE IN PETROLEUM APPLICATIONS.

For hot water applications the use of Gruvlok Extreme Temperature lubricant is recommended.

- ☐ Grade "T" Nitrile (Orange color code)  
-20°F to 180°F (Service Temperature Range)(-29°C to 82°C)  
Recommended for petroleum applications. Air with oil vapors and vegetable and mineral oils.  
NOT FOR USE IN HOT WATER OR HOT AIR
- ☐ Grade "O" Fluoro-Elastomer (Blue color code)  
20°F to 300°F (Service Temperature Range)(-29°C to 149°C)  
Recommended for high temperature resistance to oxidizing acids, petroleum oils, hydraulic fluids, halogenated hydrocarbons and lubricants.

#### GASKET TYPE:

- ☐ Flush Gap (Standard)

#### LUBRICATION:

- ☐ Standard
- ☐ Gruvlok Xtreme™

#### WORKING PRESSURE, END LOAD, PIPE END SEPARATION & DEFLECTION FROM CENTER LINE:

Based on standard wall steel pipe with cut or roll grooves in accordance with Gruvlok specifications. See technical data section for design factors.

PROJECT INFORMATION		APPROVAL STAMP
Project:		<input type="checkbox"/> Approved
Address:		<input type="checkbox"/> Approved as noted
Contractor:		<input type="checkbox"/> Not approved
Engineer:		Remarks:
Submittal Date:		
Notes 1:		
Notes 2:		

**FIG. 7001-2**  
Standard Flexible Coupling

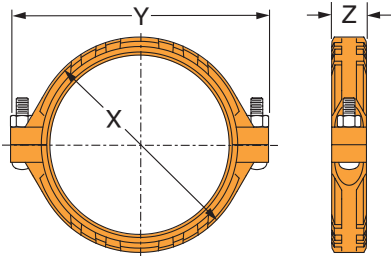

FIGURE 7001-2 STANDARD FLEXIBLE COUPLING														
Nominal Size	O.D.	Max. Work. Pressure	Max. End Load	Range of Pipe End Separation	Deflection from C		Coupling Dimensions			Bolt Dimensions*		Specified Torque S		Approx. Wt. Ea.
					Per Coupling	of Pipe	X	Y	Z	Qty.	Size	Min.	Max.	
In./DN(mm)	In./mm	PSI/bar	Lbs./kN	In./mm	Degrees(°)-Minutes(')	In./ft-mm/m	In./mm	In./mm	In./mm		In./mm	Ft.-Lbs/N-m		Lbs./kg
14	14.000	350	53,878	0-3/32	0° 23'	0.08	16 1/4	19 3/4	3	2	7/8 x 5 1/2	180	220	36.0
350	355.6	24.1	239.66	0-2.38		6.7	413	502	76		—	245	300	16.3
16	16.000	350	70,372	0-3/32	0° 20'	0.07	18 5/16	22	3	2	1 x 5 1/2	250	300	45.0
400	406.4	24.1	313.03	0-2.38		5.9	465	558	76		—	340	408	20.4
18	18.000	350	89,064	0-3/32	0° 18'	0.06	20 3/4	24 1/4	3 1/8	2	1 x 5 1/2	250	300	60.0
450	457.2	24.1	396.18	0-2.38		5.2	527	615	79		—	340	408	27.2
20	20.000	350	109,956	0-3/32	0° 16'	0.06	23	27 7/8	3 1/8	2	1 1/8 x 5 1/2	375	425	72.5
500	508.0	24.1	489.11	0-2.38		4.7	582	691	79		—	510	578	32.9
24	24.000	350	158,336	0-3/32	0° 13'	0.05	27 1/4	31 1/8	3 3/16	2	1 1/8 x 5 1/2	375	425	90.0
600	609.6	24.1	704.31	0-2.38		3.9	688	791	81		—	510	578	40.8

Range of Pipe End Separation and Angular Deflection values are for roll grooved pipe and may be doubled for cut groove pipe.  
See Installation & Assembly directions on page 155.