

Fig. 103

Offset Pipe Clamp

Size Range: 3/4" through 8"
Material: Carbon steel
Finish: ☐ Plain or ☐ Galvanized
Service: For use in supporting piping away from wall or floor.
Maximum Temperature: Plain 650° F, Galvanized 450° F
Ordering: Specify pipe size, figure number, name and finish
Service: For use in supporting horizontal piping away from the wall or floor (not to be used as a riser type support)

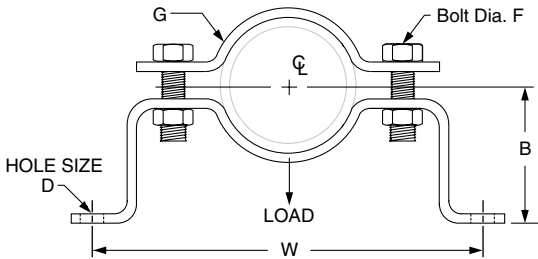

FIG. 103: LOADS (LBS) • WEIGHT (LBS) • DIMENSIONS (IN)							
Pipe Size	Max Load	Weight	W	B	D	Bolt Dia. F	G Width
3/4	190	1.50	8 3/4	2 1/2	7/16	3/8	1 1/4
1		1.60	9 1/4	2 5/8			
1 1/4		1.70	9 3/4	2 13/16			
1 1/2		1.80	10	2 15/16			
2	420	2.70	11 1/4	3 3/16	9/16	1/2	1 1/2
2 1/2		2.90	11 3/4	3 7/16			
3		3.20	12 7/8	3 3/4			
4	610	4.60	13 7/8	4 1/4	1 1/16	5/8	2
5		7.30	15 5/8	4 3/4			
6	870	7.80	16 3/4	5 5/16	1 1/16	5/8	2
8		9.00	18 3/4	6 5/16			

PROJECT INFORMATION		APPROVAL STAMP	
Project:		<input type="checkbox"/> Approved	
Address:		<input type="checkbox"/> Approved as noted	
Contractor:		<input type="checkbox"/> Not approved	
Engineer:		Remarks:	
Submittal Date:			
Notes 1:			
Notes 2:			