

Fig. 261

Extension Pipe or Riser Clamp

Size Range: 3/4" through 24"

Material: Carbon steel

Finish: ☐ Plain, ☐ Galvanized or ☐ Epoxy coated

Service: For support of stationary steel pipe risers, cast iron pipe or conduit. This product is not intended for use with hanger rods. For this application refer to Fig. 40 Riser Clamp, page 43.

Maximum Temperature: Plain 650° F, Galvanized and Epoxy 450° F

Approvals: Complies with Federal Specification A-A-1192A (Type 8) WW-H-171-E (Type 8), ANSI/MSS SP-69 and MSS SP-58 (Type 8). UL, ULC Listed (Sizes 1 1/2" - 8").

Installation: Clamp is fitted and bolted preferably below a coupling, hub or welded lugs on steel pipe. Bolt torques should be per industry standards (see page 233). Clamp is designed for standard steel pipe O.D. and this must be considered in sizing the riser for other types of piping.

Ordering: Specify pipe size, figure number, name and finish.



Note: Refer to Technical Data Section for cast iron soil pipe data.

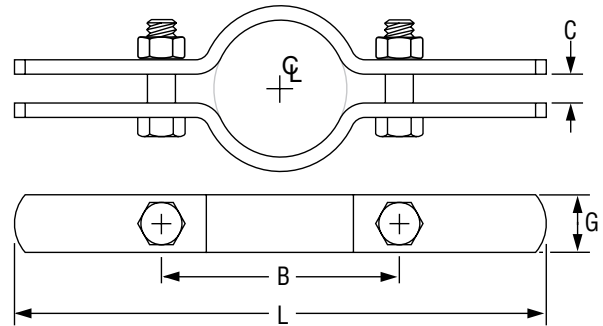

FIG. 261: LOADS (LBS) • WEIGHT (LBS) • DIMENSIONS (IN) • TORQUE (FT-LBS)

Pipe Size	Max Load	Weight	L	G Width	B	C	Bolt Diameter	Torque Values	
¾	220	1.1	8⅞	1	2⅞	⅜	⅜	21	
1		1.1			3⅛				
1¼		250			1.6				3½
1½	1.6		3⅞						
2	300	1.7	10¼		4¼	½	⅞ ₁₆	32	
2½	400	1.9			4¾				
3	500	1.9	11⅜		5½				½
3½	600	2.3	12⅞		6½				
4	750	2.4		7					
5	1,500	3.6	13¾	1½	8	½	½	46	
6	1,600	4.0			14¾				9
8	2,500	7.6			18½				12
10		2,700	11.1	2	13¾	⅝	⅝	100	
12			16.5		22¾				15¾
14	17.7		24		17¼				
16	2,900	30.4	26	2½	19¾	¾	¾	150	
18		33.8	28		21¾				
20		35.0	30		23¾				
24	3,200	82.0	36¾	3	30	1	⅞	190	

PROJECT INFORMATION

APPROVAL STAMP

Project:	<input type="checkbox"/> Approved
Address:	<input type="checkbox"/> Approved as noted
Contractor:	<input type="checkbox"/> Not approved
Engineer:	Remarks:
Submittal Date:	
Notes 1:	
Notes 2:	