

G43 Clevis Slip Hook (Red)

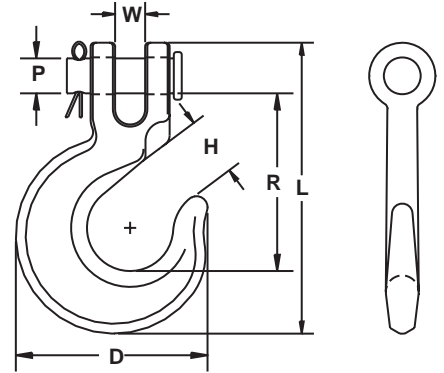

- Heat treated pins
- Hooks are heat treated and tempered
- Designs' ultimate strength equals 3 times working load limit, matching NACM specifications
- Hook embossed with trace code providing traceability through manufacturing and testing process to heat of steel
- Not to be used for overhead lifting



Size	Working Load Limit	Product Code (Red)	Dimensions						Weight
			W	D	H	L	R	P	
Imperial									
in.	lb.		in.	in.	in.	in.	in.	in.	lb.
1/4	2,600	66192	0.36	2.33	0.72	2.27	2.32	0.31	0.35
5/16	3,900	66292	0.42	2.72	0.77	4.13	2.56	0.38	0.63
3/8	5,400	66392	0.50	3.20	0.86	4.81	3.04	0.44	1.02
7/16	7,200	-	0.58	3.91	1.02	5.56	3.50	0.50	1.56
1/2	9,200	66592	0.61	4.16	1.12	6.31	4.15	0.55	2.27

G43 Eye Slip Hook with Latch (Zinc)



- Heat treated pins
- Hooks are heat treated and tempered
- Designs' ultimate strength equals 3 times working load limit, matching NACM specifications
- Hook embossed with trace code providing traceability through manufacturing and testing process to heat of steel
- Not to be used for overhead lifting

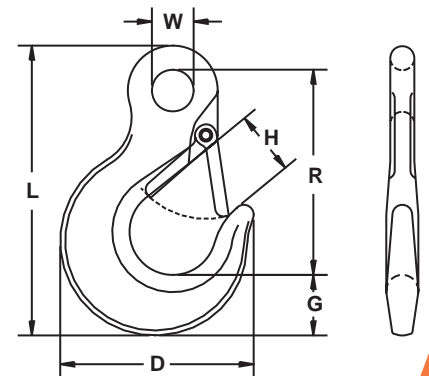

Size	Working Load Limit	Product Code (Zinc)	Dimensions						Weight
			W	D	H	L	R	G	
Imperial									
in.	lb.		in.	in.	in.	in.	in.	in.	lb.
1/4	2,600	75143	0.53	2.47	0.73	3.69	2.61	0.81	0.38
5/16	3,900	75243	0.69	2.88	0.81	3.98	2.70	0.91	0.57
3/8	5,400	75343	0.75	3.25	0.87	4.56	3.17	1.13	0.83
1/2	9,200	75543	1.03	4.25	1.21	6.13	4.20	1.50	1.95