

*NOTE:
ADDITIONAL CLEARANCE REQ'D
FOR SCREEN REMOVAL: 8"

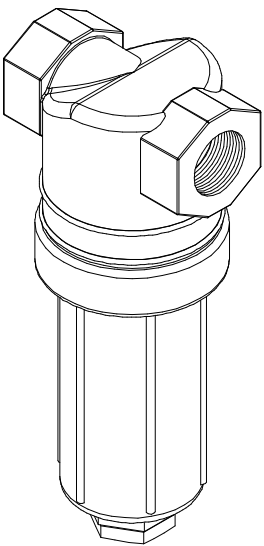

| Parts List | | | |
|------------|-----|----------|-------------------|
| Item | Qty | Part No. | Description |
| 1 | 1 | LST150B | T STRAINER BOWL |
| 2 | 1 | LSQ200R1 | PLUG ORING |
| 3 | 1 | LST150G | T STRAINER GASKET |
| 4 | 1 | LSQ200PL | DRAIN PLUG |
| 5 | 1 | LST150H | T STRAINER HEAD |
| 6 | 1 | LST1530 | STRAINER SCREEN |

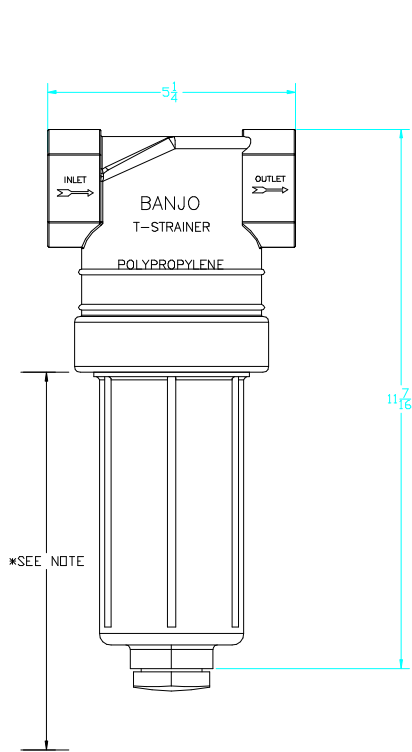
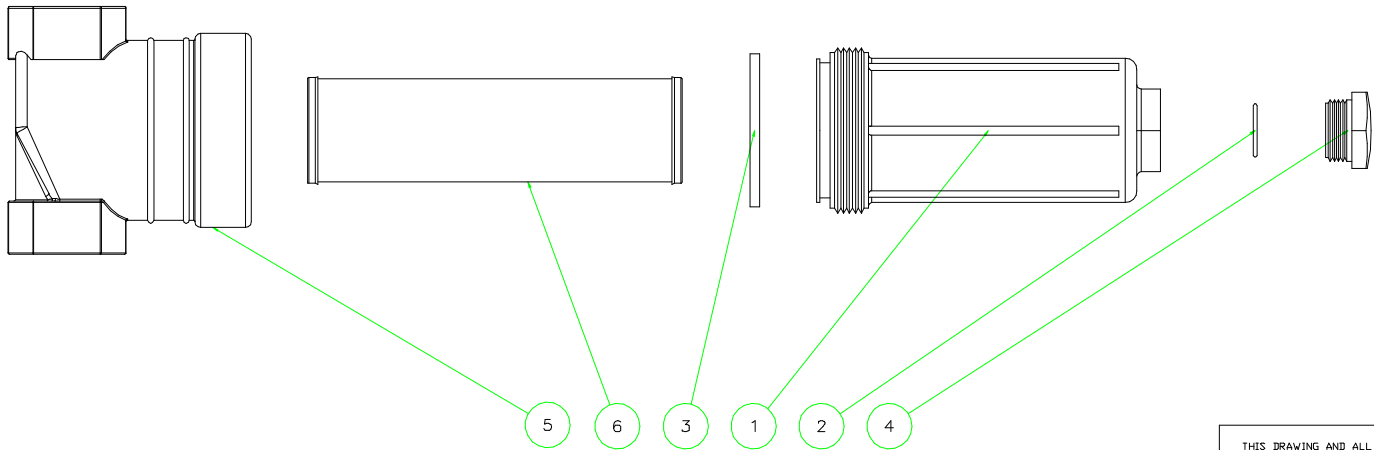

| | |
|---|--|
| BANJO CORPORATION 150 BANJO DR. * CRAWFORDSVILLE, IN 47933 | |
| PART NO. | LST150-30 |
| TITLE | *T* STRAINER ASSEMBLY W/ #30 MESH SCREEN |

THIS DRAWING AND ALL INFORMATION
CONTAINED THEREIN ARE THE EXCLUSIVE
PROPERTY OF BANJO CORPORATION.
UNLESS SPECIFICALLY NOTED, THIS
DRAWING AND ITEMS SHOWN IN THIS
DRAWING ARE SUBJECT TO CHANGE
AT ANY TIME.