



# Curb Boxes

## ARCH & MINNEAPOLIS PATTERNS



**A.Y. McDonald Mfg. Co.**

<b>CURB BOXES</b>	Page
Arch Pattern .....	4
Minneapolis Pattern .....	5-7
Curb Box w/Foot Piece .....	8
5700 Series .....	9

<b>LIDS, RODS, &amp; ACCESSORIES</b>	Page
Lids & Rods .....	10
Accessories .....	11

We recommend that the length of curb box used for a specific bury be six inches longer than final grade. *Example:* If final grade is five foot, we recommend a 5 1/2" foot maximum extended length curb box. This will allow 6" for grade change in either direction.

- Steel upper sections telescope up/down within the base casting by 12".
- Available lengths shown are listed at maximum extension.
- When curb box is supplied with stationary shut-off rods, the rods are 18" shorter than the Curb Box, at its maximum extension.
- Base sections and lids are made of cast gray iron.
- All pentagon plugs have a 27/32" point to flat size.

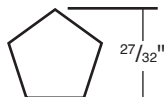

- Upper sections are held in the desired position by a strong clip ring located inside the top of the base casting.
- A swaged lug at bottom of upper section fits into a cast slot in the base casting to prevent upper section from turning when removing lid or pentagon plug.
- Curb Boxes and Accessories are black dip coated inside and out.
- Curb Boxes are shipped in the retracted position.

Our curb boxes are manufactured in Dubuque, IA with components from Canada. (MODEL 5601, 5607, 5614, & 5615) are also available with components made only in the USA.

## Arch Pattern Curb Boxes

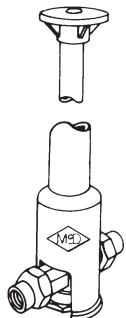

The "Arch" or "Y" base casting covers the Curb Stop without being mechanically connected. When required, a stationary shut-off rod is attached (via cotter pin) to the tee head of the Curb Stop and remains in place inside the Curb Box. The top of the shut-off rod is formed in such a manner that it centers the top of the rod inside the upper section of the 1" Curb Box.

Stationary shut-off rods are furnished with Curb Boxes having 1" upper sections and are also available separately.

## Minneapolis Pattern Curb Boxes



Minneapolis Pattern Curb Boxes have female threads machined into the bottom of the base casting that screw onto the male threads on top of all Minneapolis pattern Curb Stops. Threading the Curb Stop into the Curb Box gives a unified valve/box assembly. This arrangement assures alignment between the two.

Shut-off rod information noted above is also true when used with Minneapolis Pattern Curb Boxes with 1" upper section.

The charts below identify size of threads in base casting A.Y. McDonald Curb Boxes and Curb Stops.

Ball Style Minneapolis Valve Curb Stops		
Curb Box Base Tapped	1 1/2"	2"
A.Y. McDonald Ball Valve Size	3/4", 1" or 1 1/4" x 1" x 1 1/4"	1 1/2", 2" or 1 1/4" x 1 1/2" x 1 1/4"

Inverted Plug Type Minneapolis Curb Stops					
Curb Box Base Tapped	1 1/2"	1 1/2"	1 1/2"	2"	2 1/2"
A.Y. McDonald Inverted Plug Valve Size	1/2"	5/8"	3/4"	1"	1 1/4"

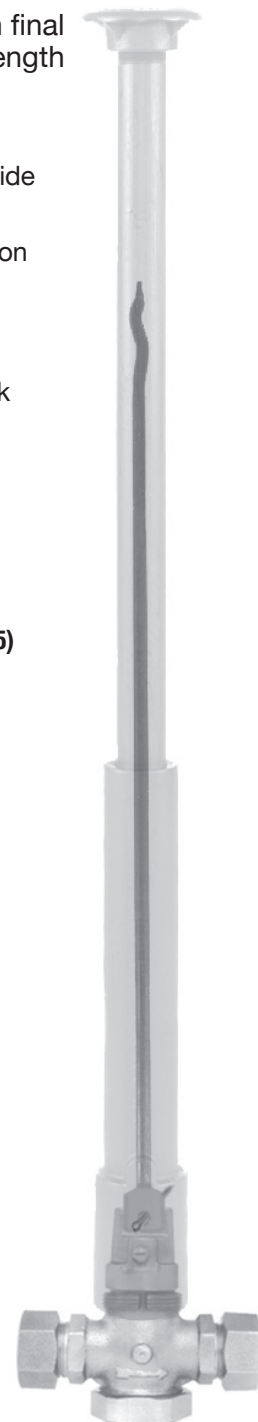

A.Y. McDonald Mfg. Co. offers high quality cast iron service boxes with a wide range of options. Service boxes can be adjusted to the full range called out in the model number. The 2 1/2" service box is designed for use with 3/4" through 1 1/4" curb stops, as well as up to 2" curb stops with the use of the enlarged base. Boxes do not include rod or centering ring (ordered separately).

- Extension lengths are listed with other model information on page 9.
- Available with water, sewer, and gas lids
- Quality cast gray iron construction ASTM A48, Class 25
- Arch-style base
- Brass pentagon bolt locking lid
- May be ordered as assembly or components

## Screw Style - Model 5700

Screw Style Service Boxes (Buffalo Style) are designed with threaded or screw style castings. Top section "threads" onto bottom section and adjusts to desired height. Top section includes water lid as standard. Centering ring, rods, and other lids are optional. Standard base will cover A.Y. McDonald Curb Stops to 1 1/4" size.

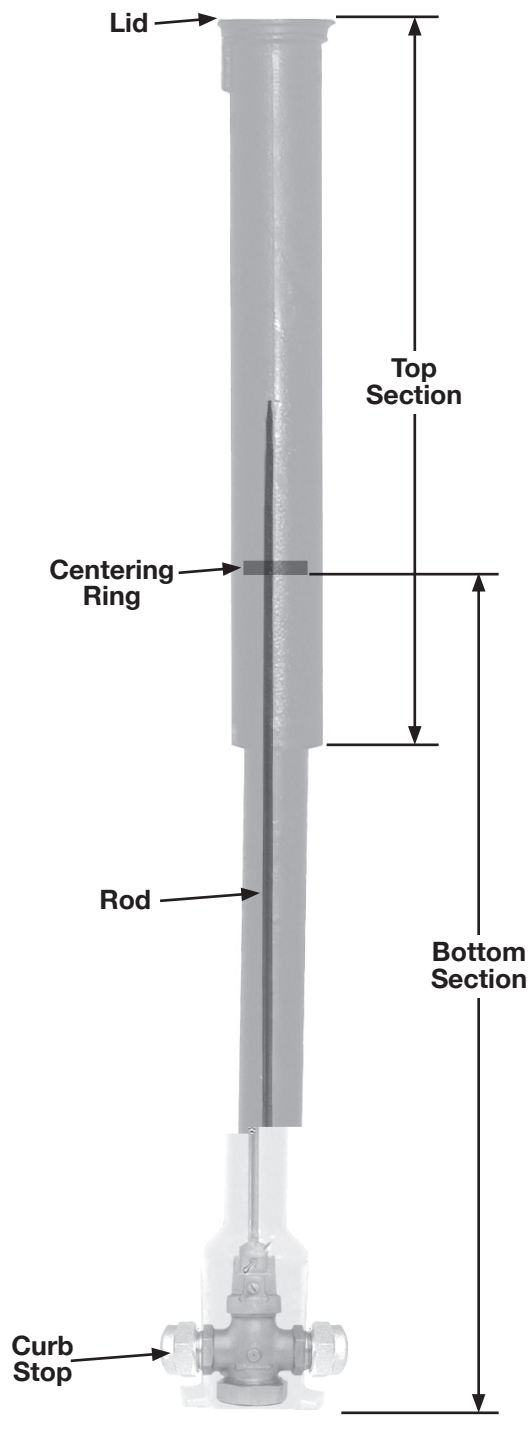

# Arch Pattern

Use with 1/2" through 2" Curb Stops



## 5601

- 1" I.D. Upper Section
- Includes 5660 stationary rod
- 5601 Lid - Two hole Erie pattern
- For use with A.Y. McDonald 3/4" and 1" inverted plug or ball style curb stops

## 5602

- 1" I.D. Upper Section
- Includes 5674 stationary rod
- 5607 Lid - with 1" brass pentagon plug\*
- For use with A.Y. McDonald 1 1/4", 1 1/2" and 2" inverted plug curb stops
- For use with 1 1/2" and 2" (ball size) ball valves

## 5603 Erie Pattern

- 1" I.D. Upper Section
- Includes 5674 stationary rod
- 5601 Lid - Two hole Erie pattern
- For use with A.Y. McDonald 1 1/4" and 2" inverted plug curb stops or 1 1/2" and 2" (ball size) ball valves

## 5607

- 1" I.D. Upper Section
- Includes 5660 stationary rod
- 5607 Lid - with 1" brass pentagon plug\*
- For use with A.Y. McDonald 3/4" and 1" inverted plug curb stops or 3/4", 1" (ball size) ball valves

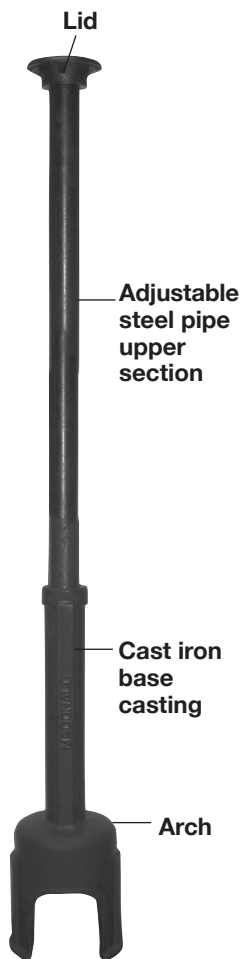

## 5604

- 1 1/4" I.D. Upper Section
- Shut-off rod available
- 5614 Lid - with 1 1/4" brass pentagon plug\*
- For use with A.Y. McDonald 3/4", 1" inverted plug or ball style curb stops

## 5600

- 1 1/4" I.D. Upper Section
- Shut-off rod available
- 5614 Lid - with 1 1/4" brass pentagon plug\*
- For use with A.Y. McDonald 1 1/4" plug style and 1 1/2" and 2" (ball size) ball valves

## 5605

- 1 1/2" I.D. Upper Section
- Shut-off rod available
- 5623 Lid - with 1 1/2" brass pentagon plug\*
- For use with A.Y. McDonald 3/4" and 1" inverted plug or ball style curb stops

## 5606

- 2" I.D. Upper Section.
- Shut-off rod available
- 5624 Lid - with 2" brass pentagon plug\*
- For use with 1 1/4" inverted plug curb stops or 1 1/2" and 2" (ball size) ball valves

## Standard Water Lids



### 5601

Tapped 1"  
Erie Pattern



### 5607\*

Tapped 1"



### 5614\*

Tapped 1 1/4"



### 5623\*

Tapped 1 1/2"



### 5624\*

Tapped 2"



### "TW"

Style Lid  
(Not available on 5601LID)

\*For Lid options, see page 10

## Notes

- Order by model number and maximum extended lengths from 2 1/2' thru 10' (in 6" increments). Example: 5603 8 1/2'
- When rods are furnished with Curb Boxes, they are 18" shorter than maximum extended length of Curb Box.
- All Curb Boxes telescope one foot. Lengths shown are at maximum extension:  
**Example:** A 5' Curb Box can be used at depths ranging from 4' to 5'.
- For Shut Off Rods and Available Lid Options see page 10.
- Our curb boxes are manufactured in Dubuque, IA with components from Canada. (MODEL 5601, 5607, 5614, & 5615) are also available with components made only in the USA.

**A.Y. McDONALD MFG. CO.**

800.292.2737 FAX 800.832.9296 sales@aymcdonald.com www.aymcdonald.com



# Minneapolis Pattern

**Base Tapped 1 1/2"**

## 5610

- 1" I.D. Upper Section
- Includes 5660 stationary rod
- 5607 Lid - with 1" brass pentagon plug\*
- For use with A.Y. McDonald 3/4" inverted plug type curb stops or 3/4", 1" ball type (ball size) curb stops

## 5612 Erie Pattern

- 1" I.D. Upper Section
- Includes 5660 stationary rod
- 5601 Lid - Two hole Erie pattern
- For use with A.Y. McDonald 3/4" inverted plug type curb stops or ball type curb stops 3/4", 1" (ball size)

## 5614

- 1 1/4" I.D. Upper Section
- Shut-off rod available
- 5614 Lid - with 1 1/4" brass pentagon plug\*
- For use with inverted plug type curb stops 3/4"
- For use with ball valve curb stops 3/4", 1" (ball size)

## 5622 / 5622C

- 1 1/2" I.D. Upper Section
- Shut-off rod available
- 5623 Lid - with 1 1/2" brass pentagon plug\*
- For use with inverted plug type curb stops 3/4"
- For use with ball valve curb stops 3/4", 1" (ball size)
- 5622 C- model provided with cast iron pentagon plug
- Base casting includes 3126-626 Bushing 2" MNPT x 1 1/2" FNPT

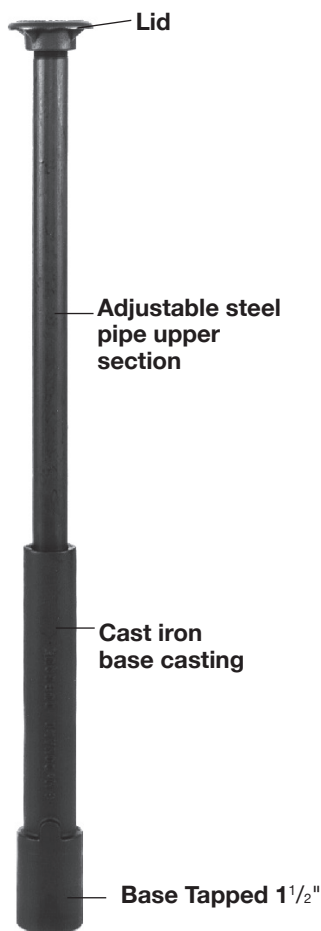

## Standard Water Lids



**5601**  
Tapped 1"  
Erie Pattern



**5607\***  
Tapped 1"



**5614\***  
Tapped 1 1/4"



**5623\***  
Tapped 1 1/2"



**"TW"**  
Style Lid  
(Not available on 5601LID)

## Notes

- Order by model number and maximum extended lengths from 2 1/2' thru 10' (in 6" increments). Example: 5603 8 1/2'
- When rods are furnished with Curb Boxes, they are 18" shorter than maximum extended length of Curb Box.
- All Curb Boxes telescope one foot. Lengths shown are at maximum extension:  
**Example:** A 5' Curb Box can be used at depths ranging from 4' to 5'.
- For Shut Off Rods and Available Lid Options see page 10.
- Our curb boxes are manufactured in Dubuque, IA with components from Canada. (MODEL 5601, 5607, 5614, & 5615) are also available with components made only in the USA.

**A.Y. McDONALD MFG. CO.**

# Minneapolis Pattern

## Base Tapped 2"

### 5611

- 1" I.D. Upper Section
- Includes 5660 shut-off rod
- 5607 Lid - with 1" brass pentagon plug\*
- For use with inverted plug type curb stops 1"
- For use with ball valve curb stops 1½", 2" (ball size)

### 5613 Erie Pattern

- 1" I.D. Upper Section
- Includes 5660 shut-off rod
- 5601 Lid - Two hole Erie pattern
- For use with inverted plug type curb stops 1"
- For use with ball valve curb stops 1½", 2" (ball size)

### 5623A

#### Increasing Adapter

- 2" MNPT x 2½" FNPT
- Increases Minneapolis Pattern Curb Box Tapped 2" up to 2½"
- Use with 1¼" inverted plug type curb stops

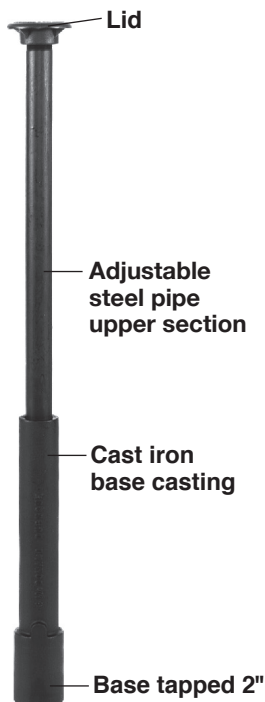

### 5615 / 5615WB

- 1¼" I.D. Upper Section
- Shut-off rod available
- 5614 Lid - with 1¼" brass pentagon plug\*
- For use with inverted plug type curb stops 1"
- For use with ball valve curb stops 1½", 2" (ball size)
- Available with 2" MNPT x 1½" FNPT reducing bushing (Add "WB" to model number)

### 5623 / 5623C

- 1½" I.D. Upper Section
- Shut-off rod available
- 5623 Lid - with 1½" brass pentagon plug\*
- For use with inverted plug type curb stops 1"
- For use with ball valve curb stops 1½", 2" (ball size)
- For cast iron plug add "C" to model number

### 3126-626

#### Decreasing Adapter Bushing

- 2" MNPT x 1½" FNPT
- Decreases Minneapolis Pattern Curb Box Tapped 2" down to 1½"



## Standard Water Lids



**5601**  
Tapped 1"  
Erie Pattern



**5607\***  
Tapped 1"



**5614\***  
Tapped 1¼"



**5623\***  
Tapped 1½"



**"TW"**  
Style Lid  
(Not available on 5601LID)

\*For tracewire lid add "TW" to model code. (Example 5615TW 5)

## Notes

- Order by model number and maximum extended lengths from 2½' thru 10' (in 6" increments). Example: 5603 8½'
- When rods are furnished with Curb Boxes, they are 18" shorter than maximum extended length of Curb Box.
- All Curb Boxes telescope one foot. Lengths shown are at maximum extension:  
**Example:** A 5' Curb Box can be used at depths ranging from 4' to 5'.
- For Shut Off Rods and Available Lid Options see page 10.
- Our curb boxes are manufactured in Dubuque, IA with components from Canada. (MODEL 5601, 5607, 5614, & 5615) are also available with components made only in the USA.

**A.Y. McDONALD MFG. CO.**

800.292.2737 FAX 800.832.9296 sales@aymcdonald.com www.aymcdonald.com

# Minneapolis Pattern

Base Tapped 3" and 3 1/2"

## 5624

- 2" I.D. Upper Section
- Shut-off rod available
- 5624 Lid - 2" brass pentagon plug\*
- Base tapped 3"

## 5625

- 2" I.D. Upper Section
- Shut-off rod available
- 5624 Lid - with 2" brass pentagon plug\*
- Base tapped 3 1/2"



## Standard Water Lids



**5624\***  
Tapped 2"



**"TW"**  
Style Lid

\*For tracewire lid add "TW" to model code. (Example 5624TW 5)

## Notes

- Order by model number and maximum extended lengths from 2 1/2' thru 10' (in 6" increments). Example: 5603 8 1/2'
- When rods are furnished with Curb Boxes, they are 18" shorter than maximum extended length of Curb Box.
- All Curb Boxes telescope one foot. Lengths shown are at maximum extension:  
**Example:** A 5' Curb Box can be used at depths ranging from 4' to 5'.
- For Shut Off Rods and Available Lid Options see page 10.

**A.Y. McDONALD MFG. CO.**

# CURB BOX W/FOOT PIECE

Use with 1/2" through 2" Curb Stops

## 5627 / 5627BSR

- 2" I.D. Upper Section.
- Shut-off rod available
- 5627 Lid
- 1 1/2" threaded support ring (5627R 1 1/2") in base casting
- For use with 1/2", 5/8", 3/4" Minneapolis Pattern inverted plug type curb stops

## 5628

- 2" I.D. Upper Section.
- Shut-off rod available
- 5627 Lid
- 2" threaded support ring (5628R 2") in base casting
- For use with 1" Minneapolis Pattern inverted plug type curb stops

## 5628B

- 2" I.D. Upper Section.
- Shut-off rod available
- 5627 Lid
- 1 1/2" threaded support ring (5628R 1 1/2") in base casting
- For use with 3/4", 1" (ball size) Minneapolis Pattern Curb Stops

## 5629B

- 2" I.D. Upper Section.
- Shut-off rod available
- 5624 Lid \*
- 1 1/2" threaded support ring (5628R 1 1/2") in base casting
- For use with 3/4", 1" (ball size) Minneapolis Pattern Curb Stops



## 5630

- 2" I.D. Upper Section.
- Shut-off rod available
- 5627 Lid
- For use with 1 1/2" **Regular Pattern** inverted plug type curb stops

## 5631

- 2" I.D. Upper Section.
- Shut-off rod available
- 5627 Lid
- For use with 2" **Regular Pattern** inverted plug type curb stops

## 5631B

- 2" I.D. Upper Section.
- Shut-off rod available
- 5627 Lid
- 2" threaded support bracket (5690) in base casting
- For use with 1 1/2", 2" (ball size) Minneapolis Pattern Curb Stops

## Standard Water Lids

\*For tracewire lid add "TW" to model code. (Example 5629BTW 5)



**5624\***  
Tapped 2"



**5627**  
Tapped 2"



**5627C**  
Cap only for 5627L

## Accessories



**5627AB**  
Brass Anchor Bolt



**5627AN**  
Anchor Nut  
For 5627 Lid



**5627R 1 1/2"**  
Support Ring

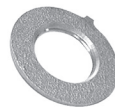

**5628R 1 1/2"**  
Support Ring



**5628R 2"**  
Support Ring



**5690**  
Minnesota Pattern Valve  
Support Bracket - 2" Tap

## Notes

- Order by model number and maximum extended lengths from 2 1/2' thru 10' (in 6" increments). Example: 5603 8 1/2'
- When rods are furnished with Curb Boxes, they are 18" shorter than maximum extended length of Curb Box.
- All Curb Boxes telescope one foot. Lengths shown are at maximum extension:  
**Example:** A 5' Curb Box can be used at depths ranging from 4' to 5'.
- For Shut Off Rods and Available Lid Options see pages 10.

**A.Y. McDONALD MFG. CO.**

800.292.2737 FAX 800.832.9296 sales@aymcdonald.com www.aymcdonald.com



# 5700 SERIES - ARCH PATTERN

- Screw (Buffalo) Style design • Cast iron construction • Includes "WATER" lid • Black dip coated
- Brass pentagon locking bolt lid • Rod sold separately

To order 2 1/2" Service Boxes: Model No. **5700S 24x39** means:

<b>5700</b>	<b>S</b>	<b>24</b>	<b>X</b>	<b>39</b>
-------------	----------	-----------	----------	-----------

**Series**

5700 - Screw Type

**Parts and Options**

**B** = Bottom Section  
**G** = Gas Lid  
**L** = Lid only-Water  
**LG** = Lid only-Gas  
**LS** = Lid only-Sewer  
**S** = Sewer  
**SE** = Extension  
**T** = Top Section (water)  
**TG** = Top Section (gas)  
**TS** = Top Section Sewer

**Minimum X Maximum Extension**

27 X 39  
 34 X 49  
 34 X 53  
 41 X 60  
 41 X 66  
 64 X 76  
 70 X 82

-OR-

Component length  
Example: 5700T 24

**EXAMPLE:**

Model No. **5700S 24x39**

- Screw type 2 1/2" service box
- Sewer lid
- 24" minimum extension
- 39" maximum extension

• Not all combinations available.  
Contact factory.

**Screw Type**

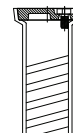

Top Section

Bottom Section

4.25"

3.25"

Arch Base Pattern

Extension Range

MODEL	EXTENSION RANGE	TOP	BOTTOM SECTION	EXTENSION
5700 27x39	27" to 39"	5700T 20"	5700B 23"	NONE
5700 34x49	34" to 49"	5700T 20"	5700B 33"	NONE
5700 34x53	34" to 53"	5700T 24"	5700B 33"	NONE
5700 41x60	41" to 60"	5700T 24"	5700B 40"	NONE
5700 41x66	41" to 66"	5700T 30"	5700B 40"	NONE
5700 64x76	64" to 76"	5700T 24"	5700B 40"	5700SE 16"
5700 70x82	70" to 82"	5700T 30"	5700B 40"	5700SE 16"

## Standard Water Lids



**5700L**  
Water Lid



**5700LG**  
Gas Lid



**5700LS**  
Sewer Lid

## Accessories



**5700SE**  
9" and 16"

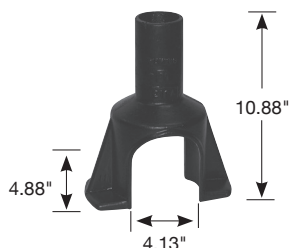

**5700EBASE**  
Enlarged Base



**5700AB**  
Pentagon Bolt



**5700RING**  
Centering Ring



**5700RL NEW**  
2 1/2" Service Box  
Repair Lid



**5700RL OLD**  
2 1/2" Service Box  
Repair Lid

**A.Y. McDONALD MFG. CO.**

# CURB BOX LIDS & RODS



**5607L**  
(Tapped 1")  
marked  
\*\*"G" Gas  
\*\*"PS" Sewer Lid  
\*\*"RW" Reclaimed Water  
\*\*"SK" Irrigation Lid  
"TW" Tracerwire



**5614L**  
(Tapped 1 1/4")  
marked  
\*\*"G" Gas  
\*\*"PS" Sewer Lid  
\*\*"RW" Reclaimed Water  
\*\*"SK" Irrigation Lid  
"TW" Tracerwire



**5623L**  
(Tapped 1 1/2")  
marked  
"TW" Tracerwire



**5624L**  
(Tapped 2")  
marked  
"FS" Fire Sprinkler  
"PS" Sewer Lid  
"TW" Tracerwire



- A pentagon plug allows access to curb stop or shut-off rod without removing lid
- For lids with other markings or variations, contact factory.
- To order a brass pentagon plug separately, add "BP" to the model number.
- \* Pentagon plug with rope-style threads

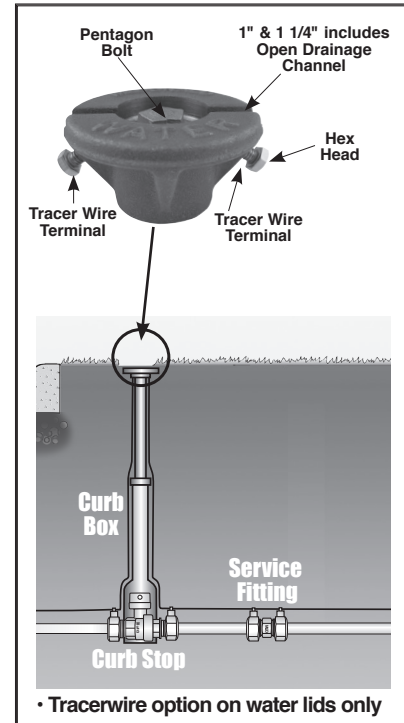

## Shut-Off Rods

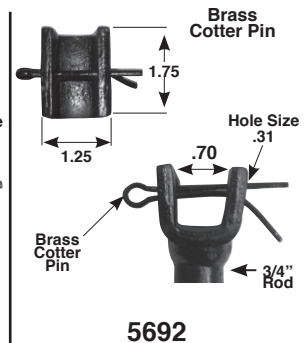
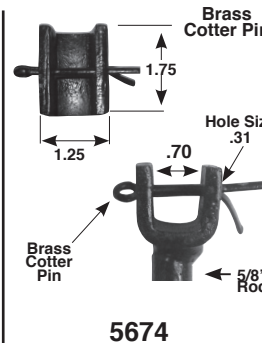
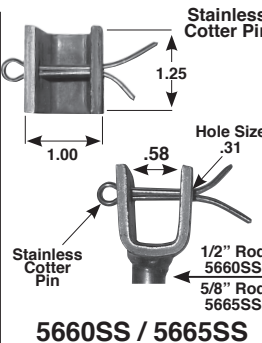
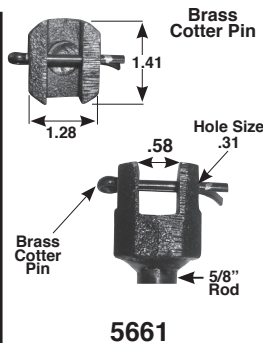
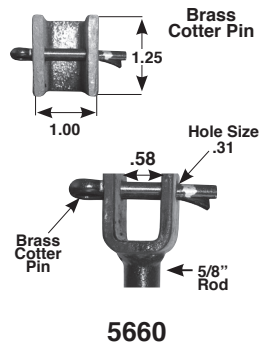

### 5660/5661

- Steel Key Cast Key
- 5/8" rod
  - Small key-clamp welded to rod
  - For use with:
    - Ball style curb stops 5/8", 3/4", 1", 1 1/2", 2" (ball size)
    - Inverted plug style curb stops 1/2", 5/8", 3/4", 1"

### 5660SS / 5665SS

- 1/2" Stainless steel rod (5660SS)
- 5/8" Stainless steel rod (5665SS)
- Small key-clamp welded to rod
- For use with:
  - Ball style curb stops 5/8", 3/4", 1", 1 1/2", 2" (ball size)
  - Inverted plug style curb stops 1/2", 5/8", 3/4", 1"

### 5674

- 5/8" rod
- Large key-clamp welded to rod
- For use with:
  - Ball style curb stops 1 1/2", 2" (ball size)
  - Inverted plug style curb stops 1 1/4", 1 1/2", 2"

### 5692

(For use with 2" upper sections only)

- 3/4" rod
- Large key-clamp welded to rod
- For use with:
  - Ball style curb stops 1 1/2", 2" (ball size)
  - Inverted plug style curb stops 1 1/4", 1 1/2", 2" (For use with 2" upper sections only)

Extended box length in feet	2 1/2'	3'	3 1/2'	4'	4 1/2'	5'	5 1/2'	6'	6 1/2'	7'	7 1/2'	8'
Rod length in inches	12"	18"	24"	30"	36"	42"	48"	54"	60"	66"	72"	78"

•Order by rod model number and length of rod in inches. Example: 5660 4'

# ACCESSORIES



Slotted End

## 304B

### Curb Box Key

**Lengths:** 2', 3', 4', 5', 6', 7', 8'

### Heavy steel rod

Slotted key fits top of all shut-off rods. Spanner wrench end fits 5601L lid. Pentagon wrench fits 5607L, 5614L, 5623L, 5624L, and 5627L lids.



## 304K

### Pentagon Key

Fits 5607L, 5614L, 5623L, 5624L and 5627L lids.



## 5660CP

### Brass Cotter Pin

Fits all shut-off rods. 1 1/4" long



## 5660SSCP

### Stainless Steel Cotter Pin

Fits all shut-off rods. 1 1/4" long



1.31 O.D.

## 305

### Shut-Off Rod

**Lengths:** 2', 3', 4', 6', 8'  
Fits in curb boxes with upper sections 1 1/4" and larger, and directly onto operating head of the curb stop.



## 5639

### Cast Iron Curb Box Receptacle

For use with 1" upper section curb boxes (5601 Erie pattern).



## 5614RL

### Repair Lid

Fits 1" or 1 1/4" pipe

## Cast Iron Repair Couplings



"TR" is used for top curb box thread repairs and extends height by 3"

## 5601TRS

### Curb Box Repair Coupling

For use with 1" upper section curb boxes

## 5604TRS

### Curb Box Repair Coupling

For use with 1 1/4" upper section curb boxes

## 5605TRS

### Curb Box Repair Coupling

For use with 1 1/2" upper section curb boxes

## 5606TRS

### Curb Box Repair Coupling

For use with 2" upper section curb boxes



TRS Coupling

Extension Pipe

RC Coupling

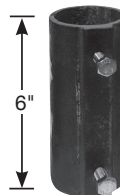

"RC" couplings are used to repair or extend the upper section of curb box pipe

## 5601RC

### Curb Box Coupling

For use with 1" upper section curb boxes

## 5604RC

### Curb Box Coupling

For use with 1 1/4" upper section curb boxes

## 5605RC

### Curb Box Coupling

For use with 1 1/2" upper section curb boxes

## 5606RC

### Curb Box Coupling

For use with 2" upper section curb boxes



[www.aymcdonald.com](http://www.aymcdonald.com)



A.Y. McDonald Mfg. Co. is a leading manufacturer of Waterworks Brass, Plumbing Valves, Pumps and Water Systems, and High Pressure Gas Valves and Meter Bars. The Company has distinguished itself with a proud tradition of quality and reliability since its founding in 1856.

### *Mission Statement*

The mission of A.Y. McDonald Mfg. Co., in the words of our founder, is "to make good products and sell them honestly." We, the stockholders and employees, accomplish this by extending the McDonald family culture through excellent customer service and by focusing on our customers' needs.



*Locations:* Albia, Iowa • Dubuque, Iowa • Elizabethton, TN • Sparks, NV

WARNING: //////////////////////////////////////////////////////////////////// WARNING: //////////////////////////////////////////////////////////////////// WARNING: //////////////////////////////////////////////////////////////////// WARNING: //////////////////////////////////////////////////////////////////// WARNING: //////////////////////////////////////////////////////////////////// WARNING: //

**WARNING:** It is unlawful in **CALIFORNIA & VERMONT** (effective 1/1/2010); **MARYLAND** (effective 1/1/2012); **LOUISIANA** (effective 1/1/2013) and the **UNITED STATES OF AMERICA** (effective 1/4/2014) to use any product in the installation or repair of any public water system or any plumbing in a facility or system that provides water for human consumption if the wetted surface area of the product has a weighted average lead content greater than 0.25%. This prohibition does not extend to service saddles used in California, Louisiana or under USA Public Law 111-380.

WARNING: //////////////////////////////////////////////////////////////////// WARNING: //////////////////////////////////////////////////////////////////// WARNING: //////////////////////////////////////////////////////////////////// WARNING: //////////////////////////////////////////////////////////////////// WARNING: //////////////////////////////////////////////////////////////////// WARNING: //

# A.Y. McDonald Mfg. Co.