

DuraPort™ Industrial Wallplate

APPLICATION

DuraPort Industrial Connectivity products provide IP67 class protection to safeguard your connectivity from humidity/moisture, corrosive materials, temperature extremes and other conditions often found in the industrial environment.

FEATURES

- IP67 rated environmental sealing (dust/water protection)
- Over-molded wallplate gasket ensures watertight fit
- Wallplate mounting holes have embedded sealing feature providing the dual benefit of sealing and helping to ensure proper screw orientation during installation (patent pending)
- DuraPort stainless steel wallplates provide a durable, easy-to-clean solution for demanding environments
- Available in single-gang 1-, 2-port, and dual-gang 2-, 4-port configurations
- DuraPort products are compatible with Leviton QuickPort connectors
- Rockwell Encompass™ approved

STANDARDS COMPLIANCE

Meets or exceeds all applicable standards: cULus Listed; complies with TIA/TR 42.9 Industrial Draft

PHYSICAL SPECIFICATIONS

Ingress Protection: IP67 (dust/water)

Dimensions:

Single-Gang	4.620"H x 2.870"W x .287"D
Dual-Gang	4.620"H x 4.682"W x .287"D

Capacity:

Single-Gang	1-, 2-port
Dual-Gang	2-, 4-port

Materials:

Wallplate	Type 302/304 Stainless Steel
Mounting screws	Type 18-8 Stainless Steel

Wallplate Gasket: Thermoplastic Elastomer

DESIGN CONSIDERATIONS

- Compatible with standard NEMA boxes
- Designed for use with DuraPort Industrial Connector Housings to provide IP67 protection against dust and water
- Individual-port configurability allows specification flexibility



DuraPort™ Industrial Wallplate

Pictured: Industrial Wallplate

WARRANTY INFORMATION

For a copy of Leviton product warranties, log on to www.levitonvoicedata.com/warranty.

TYPICAL SPECIFICATION

Single-gang and dual-gang stainless steel wallplates shall be field configurable and accept DuraPort Industrial Connector Housings. The single-gang wallplate shall provide 1, or 2 ports, and the dual-gang shall provide 2, or 4 ports. Wallplate shall be constructed of stainless steel, have an integral over-molded gasket, fit standard NEMA electrical boxes, be cULus Listed, and compliant with TIA/TR 42.9 Industrial Draft specifications.

ELECTRONIC FILES

For CAD files, Typical Specs, or Dimensional Line Art (.DXF, .DWG, MS-DOS.eps or .TXT), log on to www.levitonvoicedata.com.



For Technical Support Call 1-425-485-4288; in USA call 1-800-824-3005.
Spec sheets and updates are also available at www.levitonvoicedata.com.

2222 – 222nd St. SE • Bothell, WA 98021 USA
Tel: 1-800-722-2082 / 1-425-485-4288 • Fax: 1-425-483-5270 • Int'l Fax: 1-425-485-9170 • GSA Schedule Available.



DuraPort™ Industrial Wallplate

Part Number
D6710-XSX

DIMENSIONAL LINE ART

For Dimensional Line Art (.DXF, .DWG, MS-DOS.eps or .TXT),
log on to www.leviton.com.

The DuraPort System
Patents Pending

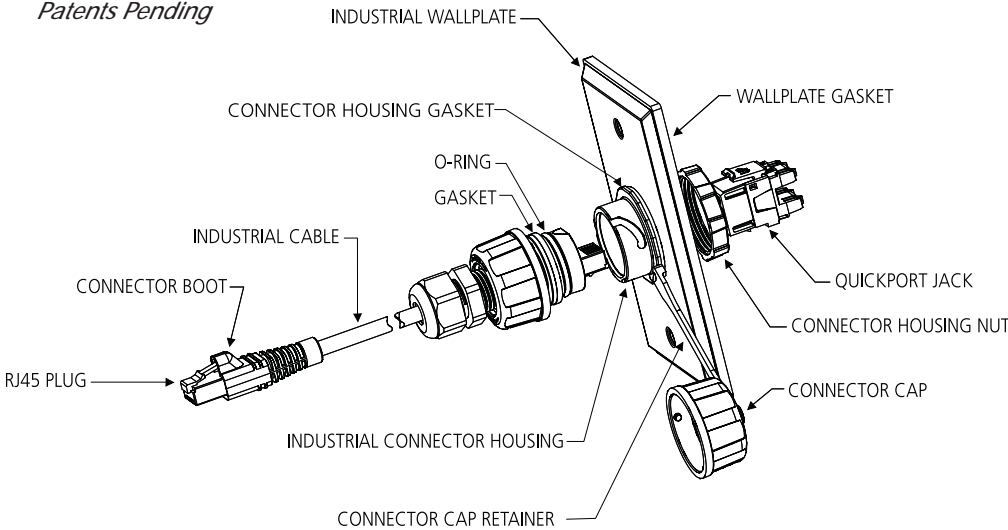

DuraPort Industrial Wallplate

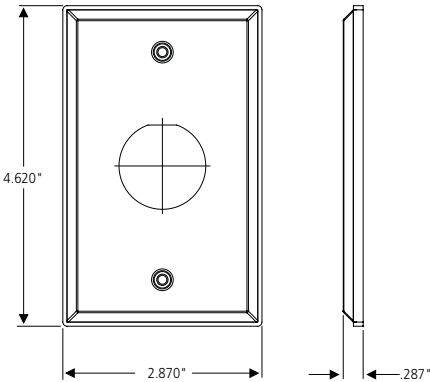

Single-Gang, 1-Port

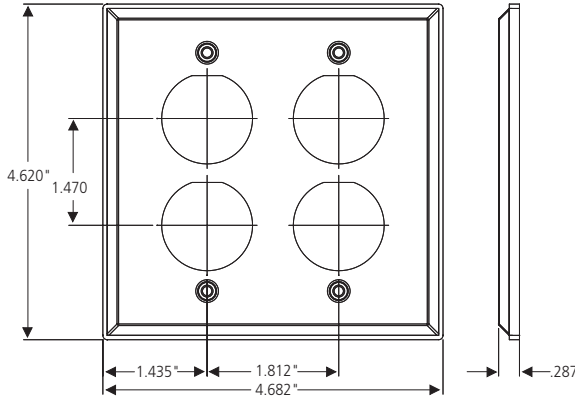

Dual-Gang, 4-Port

PART NUMBERS

Description	Part No.
Industrial Wallplate, Single-Gang, 1-Port	D6710-1S1
Industrial Wallplate, Single-Gang, 2-Port	D6710-1S2
Industrial Wallplate, Dual-Gang, 1-Port	D6710-2S2
Industrial Wallplate, Single-Gang, 1-Port	D6710-2S4



For Technical Support Call 1-425-485-4288; in USA call 1-800-824-3005.
Spec sheets and updates are also available at www.leviton.com.

2222 – 222nd St. SE • Bothell, WA 98021 USA • Tel: 1-800-722-2082 / 1-425-485-4288 • Fax: 1-425-483-5270 • Int'l Fax: 1-425-485-9170 • GSA Schedule Available.