

# Component Specifications

**Part Numbers**  
**41DWX-xxx 41NB2-xxx**  
**41AB2-xxx 41AWX-xxx**  
**41DB1-xxx 41DR2-xxx**  
**..... 41DBR-xxx .....**

## 110 Style Crossconnect Product Wall and Rack Mount Wiring Bases and Kits

### APPLICATION

Used in building entrance facilities, telecommunications closets and equipment rooms to provide fixed cross-connections for voice, security and data applications—including high megabit applications when used with Category 5e rated cabling. Wall version mounts to walls or backboards in 50, 100 or 300 pair densities. Rack version mounts on 19" distribution frames or hinged wall-mount brackets

### STANDARDS COMPLIANCE

Meets or exceeds all applicable standards: all components are UL listed; comply with TIA/EIA-568-B.2 requirements; and meet FCC Part 68.

### PHYSICAL SPECIFICATIONS

#### Wall Mount-

Dimensions:

50 Pair Wiring Base (w/o legs):

1.66"H x 8.51"W x 1.42"D

50 Pair Wiring Base (w/ legs):

1.81"H x 10.7"W x 3.3"D

100 Pair Wiring Base (w/o legs):

3.44"H x 8.51"W x 1.42"D

100 Pair Wiring Base (w/ legs):

3.62"H x 10.7"W x 3.3"D

300 Pair Wiring Base (w/ legs):

10.83"H x 10.7"W x 3.3"D

Materials:

110 wiring bases are made of fire-retardant plastic rated UL 94V-0; C-4 and C-5 connector blocks are made of fire-retardant plastic rated UL 94V-0 with solder plated IDC's.

#### Rack Mount-

Dimensions:

100 Pair Panel: 1.73"H x 19"W x 1.75"D

200 Pair Panel: 3.46"H x 19"W x 1.75"D

300 Pair Panel: 5.23"H x 19"W x 1.75"D

Material:

110 wiring bases are made of fire-retardant plastic rated UL 94V-0; C-4 and C-5 connector blocks are made of fire-retardant plastic rated UL 94V-0 with solder plated IDC's; panel back plates are made of painted black 16 gauge steel.

### DESIGN CONSIDERATIONS

- Use where space limitations and low cost are factors.
- 110 wiring bases are available with or without standoff legs. Legs can also be purchased separately (PN# 410L2-xxx).

See ELECTRONIC FILES for CAD files (.DXF, .DWG, MS-DOS.EPS) on disk

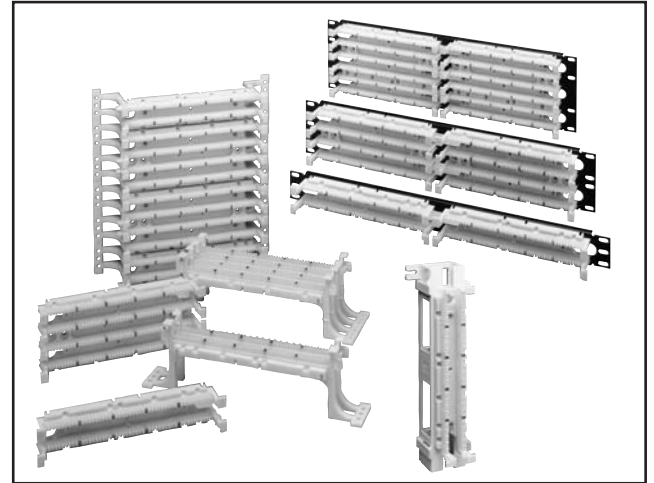

- Kitted versions include 50, 100 or 300 pair bases with legs, labels, label holders, C-4 or C-5 connector blocks.
- Port ID option: Use the label strips and holders provided with the 300-pair wiring base, and Kit versions of these products.
- Mount on wall or backboard.
- Route cable bundles either adjacent to wiring bases, or underneath units with legs.
- Route individually marked cables from both left and right sides.
- 89D mounting bracket is sold separately.

### WARRANTY INFORMATION

For a copy of Leviton product warranties, log on to [www.levitonvoicedata.com/warranty](http://www.levitonvoicedata.com/warranty).

For ELECTRONIC Typical Specs see (.TXT) file on disk.

### TYPICAL SPECIFICATION

The cross-connect shall be Category 5e 110-style wiring bases, mountable to wall or backboard to provide 110 termination capable of supporting voice, security, and Category 5e data applications, including high megabit and shared-sheath applications when used with Category 5e rated cabling. The 110 rack-mount panels shall mount to a 19" distribution frame or hinged wall mount bracket. The components shall be UL listed and TIA/EIA-568-B compliant. Bases shall support 50, 100 or 300 pair densities with provision for TIA/EIA-606 compliant labeling. Plastic bases and blocks shall be made of fire-retardant plastic rated UL 94V-0.



**For Technical Support Call 1-425-485-4288; in USA call 1-800-824-3005.**  
**Spec sheets and updates are also available at [www.levitonvoicedata.com](http://www.levitonvoicedata.com).**

2222 - 222nd St. SE • Bothell, WA 98021 USA  
Tel: 1-800-722-2082 / 1-425-485-4288 • Fax: 1-425-483-5270 • Int'l Fax: 1-425-485-9170 • GSA Schedule Available



**110 Style Crossconnect Product**

# 110 Style Crossconnect Products

**Part Numbers**  
**41DWX-xxx**    **41NB2-xxx**  
**41AB2-xxx**    **41AWX-xxx**  
**41DB1-xxx**    **41DR2-xxx**  
**41DBR-xxx**  
 .....  
 .....

## DIMENSIONAL LINE ART

See ELECTRONIC FILES for CAD files  
 (.DXF, .DWG, MS-DOS, EPS) on disk

50 Pair 89D Bracket Compatible Wiring Base

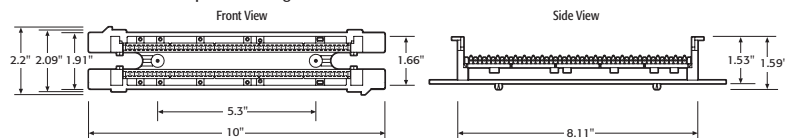

50 Pair Wiring Base (without legs)

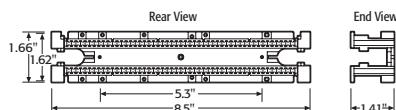

100 Pair Wiring Base (without legs)

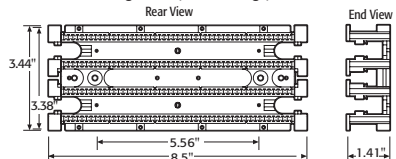

50 Pair Wiring Base (with legs)

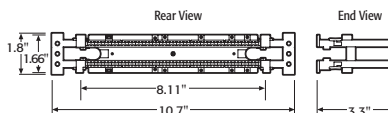

100 Pair Wiring Base (with legs)

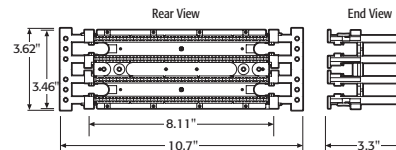

100 Pair Rack Mount Wiring Panel

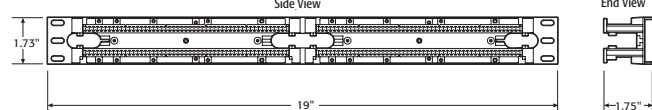

200 Pair Rack Mount Wiring Panel

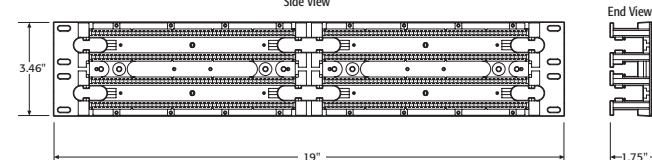

300 Pair Rack Mount Wiring Panel

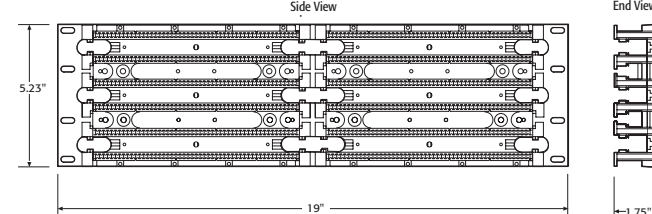

300 Pair Wiring Base (with legs)

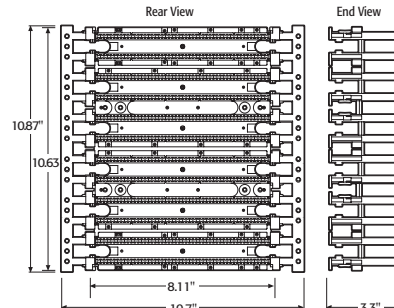

## PART NUMBERS

Description	Part No.
50 Pair Wall Mount Wiring Base without legs	41DW1-50
100 Pair Wall Mount Wiring Base without legs	41DW2-100
50 Pair Wall Mount Wiring Base with legs	41AW1-50
100 Pair Wall Mount Wiring Base with legs	41AW2-100
300 Pair Wall Mount Wiring Base with legs	41AW2-300
100 Pair Wall Mount Wiring Base kit w/C4 clips	41AB2-1F4
300 Pair Wall Mount Wiring Base Kit w/C4 clips	41AB2-3F4
100 Pair Wall Mount Wiring Base kit w/C5 clips	41AB2-1F5
300 Pair Wall Mount Wiring Base Kit w/C5 clips	41AB2-3F5
100 Pair Wall Mount Wiring Base Kit without legs w/C-4 clips	41NB2-1F4
100 Pair Wall Mount Wiring Base Kit without legs w/C-4 clips	41NB2-1F5
100 Pair Rack Mount Wiring Panel	41DR2-100
200 Pair Rack Mount Wiring Panel	41DR2-200
300 Pair Rack Mount Wiring Panel	41DR2-300
100 Pair Rack Mount Wiring Panel Kit w/C4 clips	41DBR-1F4
200 Pair Rack Mount Wiring Panel Kit w/C4 clips	41DBR-2F4
300 Pair Rack Mount Wiring Panel Kit w/C4 clips	41DBR-3F4
100 Pair Rack Mount Wiring Panel Kit w/C5 clips	41DBR-1F5
200 Pair Rack Mount Wiring Panel Kit w/C5 clips	41DBR-2F5
300 Pair Rack Mount Wiring Panel Kit w/C5 clips	41DBR-3F5
50 Pair 89D Bracket Compatible Wiring Base UNIT (89D Bracket sold separately)	41DW1-589
50 Pair 89D Bracket Compatible Wiring Base KIT with C-4/C-5 clips (89D Bracket sold separately)	41DB1-5FT
89D Bracket	40089-D



For Technical Support Call 1-425-485-4288; in USA call 1-800-824-3005.  
 Spec sheets and updates are also available at [www.levitonvoicedata.com](http://www.levitonvoicedata.com).



2222 - 222nd St. SE • Bothell, WA 98021 USA • Tel: 1-800-722-2082 / 1-425-485-4288 • Fax: 1-425-483-5270 • Int'l Fax: 1-425-485-9170 • GSA Schedule Available