

eXtreme® 10G Connector

eXtreme® 10G Connector

APPLICATION

Leviton's eXtreme 10G Connectors exceed all channel performance requirements in TIA-568-B.2-10 from 1 MHz to 500MHz to support the IEEE 802.3an standard for 10 Gigabit Ethernet over UTP Cable. Each 10G connector is designed to be used with all Leviton QuickPort® compatible products and features Leviton's patented, injection molded Cone of Silence™ to provide a simple and effective method of eliminating alien crosstalk (AXT). Every 10G connector includes Leviton's patented Retention Force Technology® (RFT) to promote consistent performance over the life of the system. Unique Pair Separation Towers facilitate quick, easy terminations. The connector is configured in a 180° configuration such that the punch down field is in the back, allowing for rear termination.

FEATURES

- 10G Channel Performance
- Retention Force Technology
- Cone of Silence
- Pair Separation Towers

STANDARDS COMPLIANCE

eXtreme 10G system components meet or exceed the requirements for channel per TIA 568-B.2-10, are cULus Listed, and are NOM and ACA compliant.

PHYSICAL SPECIFICATIONS

Dimensions:

See page two

Materials - Connector Body:

High-impact, fire-retardant plastic rated UL 94V-0

Materials - Spring Wire Contacts:

High-quality, copper-based alloy, plated with 50 micro-inches of gold for lowest contact resistance and maximum life

DESIGN CONSIDERATIONS

- Use in any QuickPort housing to support 10G UTP connectivity in surface mount, flush mount, or modular furniture outlets and field-configurable panels
- Can be used in conjunction with other QuickPort snap-in modules for voice/data/video applications over UTP, coax, fiber
- To identify ports, use different colored modules for each application (full selection of TIA/EIA-606 compatible colors - 14 available)

WARRANTY INFORMATION

For a copy of Leviton product warranties, log on to www.levitonvoicedata.com/warranty.



TYPICAL SPECIFICATION

The modular connector shall meet or exceed the requirements for channel-level performance described in TIA-EIA-568-B.2-10. The modular connector shall be snap-in style. The connectors shall also be in compliance with all National Electrical codes; compliant with FCC Part 68; UL Listed; and independently verified. In addition to 10G compliance, the connector shall have the ability to support high megabit and shared sheath applications. All plastics used in construction of the connector bodies shall be fire-retardant with a UL flammability rating of 94V-0. All terminations shall use 110-type insulation displacement connectors (IDC). The connector shall provide a ledge directly adjacent to the 110-style termination against which wires can be directly terminated and cut in one action by the installation craftsman. Connector wiring is universal and will accommodate installation color codes for T568A and T568B wiring schemes. The termination field shall be in the rear for easy access. The connector shall include an alien crosstalk attenuation cover (Cone of Silence) to protect the termination field from induced noise from adjacent connectors. The modular connector shall fit all other Leviton installed telecommunications wallplates, outlets, field-configurable patch panels and patch blocks. Available in 14 TIA/EIA-606 compatible colors.

ELECTRONIC FILES

For CAD files, Typical Specs, or Dimensional Line Art (.DXF, .DWG, MS-DOS.eps or .TXT), log on to www.levitonvoicedata.com.



For Technical Support Call 1-425-485-4288; in USA call 1-800-824-3005.
Spec sheets and updates are also available at www.levitonvoicedata.com.

2222 - 222nd St. SE • Bothell, WA 98021 USA
Tel: 1-800-722-2082 / 1-425-485-4288 • Fax: 1-425-483-5270 • Int'l Fax: 1-425-485-9170 • GSA Schedule Available.



eXtreme® 10G Connector

Part Number
6110G-R*6
61COS-B13

.....

DIMENSIONAL LINE ART

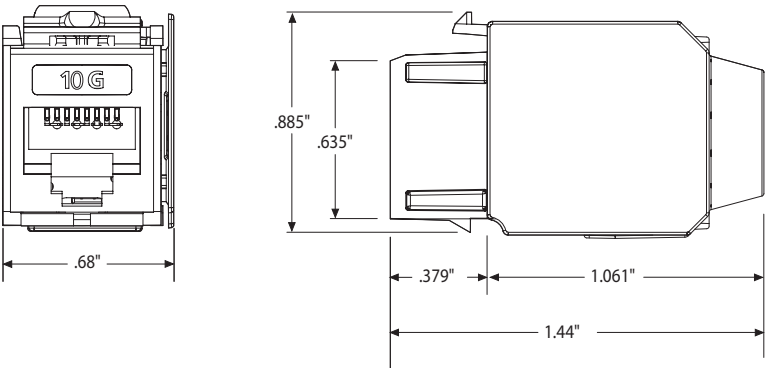

eXtreme 10G Connector
w/Cone of Silence
Front View

eXtreme 10G Connector
w/Cone of Silence
Side View

PART NUMBERS

Description	Part No.
eXtreme 10G Connector	6110G-R*6
Cone of Silence™ replacement pack (bag of 13)	61COS-B13



For Technical Support Call 1-425-485-4288; in USA call 1-800-824-3005.
Spec sheets and updates are also available at www.levitonvoicedata.com.

2222 – 222nd St. SE • Bothell, WA 98021 USA
Tel: 1-800-722-2082 / 1-425-485-4288 • Fax: 1-425-483-5270 • Int'l Fax: 1-425-485-9170 • GSA Schedule Available.

